

NOTE: THIS IS A RETRACEMENT OF A SURVEY BY SELLNER AS RECORDED IN SURVEY PLAT V. 8, P. 404.

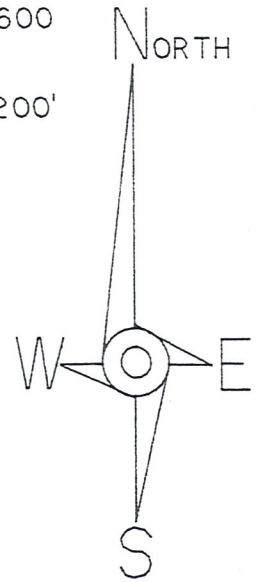
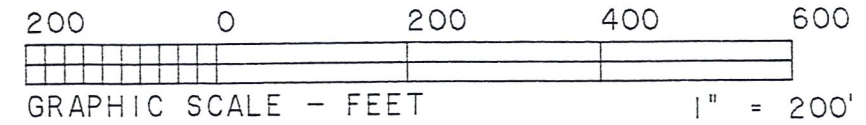

31  
31

S 85° 47' 24" E 1310.00' REC.  
1322.55' MEAS.

FENCE POST FD. & USED -  
A STONE IS LOCATED 1' WEST  
OF THE POST BUT DOESN'T  
APPEAR TO BE A CORNER STONE.

NORTHEAST COR.  
NORTHWEST QTR.  
SOUTHWEST QTR.

- LEGEND:
- = STONE FOUND
  - = IRON PIN/PIPE FOUND
  - = POINT-OF-DEPARTURE
  - = 5/8" X 30" RE-BAR  
W/I.D. CAP SET
  - ⊗ = RAILROAD SPIKE SET
  - △ = R/R SPIKE FOUND

REFERENCE DOCUMENTS:  
TAX MAP  
DEEDS AS SHOWN  
SURVEY PLATS:  
P. 8/404  
P. 8/387

\* BEARINGS ESTABLISHED  
FROM SURVEY P. 8/404

KENNETH E. HEIMBERGER  
205/381

KENNETH E. & SHIRLEY A. HEIMBERGER  
266/149

I CERTIFY THIS TO BE A TRUE PLAT OF A FIELD  
SURVEY COMPLETED ON DECEMBER 13, 1994:

*Jim Shamp*

JIM SHAMP, REG. SUR. NO. 9-6088

JOSEPH ZUCHARO &  
WAVELET L. CAVINEE - ZUCHARO  
243/963

REX M. MESSNER  
238/237

8.853 ACRES

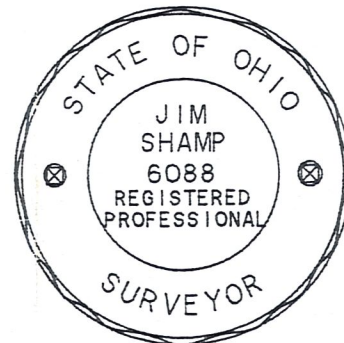

HEARTLAND Surveying

Jim Shamp  
5210 Twp. Rd. 257 Millersburg, OH 44654  
Phone: 216-674-4698

SURVEY			DATE
JOSEPH ZUCARO			DECEMBER 19, 1994
STATE	COUNTY	TOWNSHIP	RANGE
OHIO	HOLMES	WASHINGTON	15 WEST
TOWNSHIP	SOUTHWEST QUARTER OF		941160
20 NORTH	SECTION 31		DISK 94/11

ASHLAND COUNTY  
HOLMES COUNTY

600.40'  
C/L S.R. 3  
R/W VARIES

\* N 03° 44' 42" E  
600.00'

\* S 73° 53' 46" W 820.00'

\* N 87° 56' 21" E  
775.26'

981.5' REC.  
1003.54' MEAS.  
\* S 03° 44' 42" W  
400.00' TOTAL  
282.20'

77.10'  
PROP. LN.

40.70'