

120.641 ACRES

MARYANN TROYER

D.V. 168 -563 & 566

S.W. QTR. - 116.066 AC.

S.E. QTR. - 4.575 AC.

26.187 ACRES

S.W. QTR. - 1.756 AC.

S.E. QTR. - 24.431 AC.

WALNUT CREEK TOWNSHIP

S.E. & S.W. QTRS. SECTION 22

T-9 N; R-5 W

HOLMES COUNTY, OHIO

SURVEYED FOR: MARYANN TROYER ESTATE



SCALE: 1"=200'

- STONE FOUND
- 5/8" REBAR FOUND
- △ R.R. SPIKE SET
- 5/8" REBAR WITH I.D. CAP SET  
I.D. CAP MARKED "BAKER 6938"
- R & U RECORD & USED

REFERENCES:

- DEED VOL. 168 PAGE 566
- DEED VOL. 181 PAGES 657
- DEED VOL. 246 PAGE 942
- DEED VOL. 277 PAGES 172
- DEED VOL. 205 PAGE 718
- DEED VOL. 279 PAGES 225
- O.R. VOL. 66 PAGE 931

BEARINGS FROM PLAT VOL. 2 PAGE 327

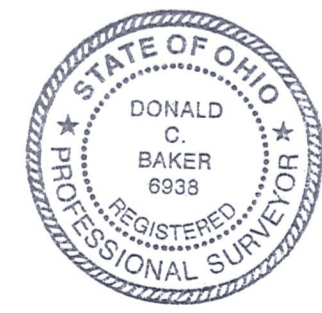

I CERTIFY THIS SURVEY TO BE CORRECT TO THE BEST OF MY KNOWLEDGE.

*Donald C. Baker*

DONALD C. BAKER PS 6938  
 FCC\FDB DATE: MAY 14, 2003  
 File Name: C:\JOBS\S-151-03\MLD



DONALD C. BAKER SURVEYING  
 138 N. CLAY ST.  
 MILLERSBURG, OH 44654  
 PH. 330-674-4788  
 FAX: 330-674-6027

RECEIVED  
 MAY 16 2003  
 Tol. Co. Tax Map Office