

WALNUT CREEK TOWNSHIP
 S.W. QTR. SECTION 12
 T-9 N; R-5 W
 HOLMES COUNTY, OHIO

MASTER PLAT
 ACTION 1) CONVEY 4.438 ACRE PARCEL TO ADJOINER
 ACTION 2) CONVEY 3.319 ACRE PARCEL TO ADJOINER

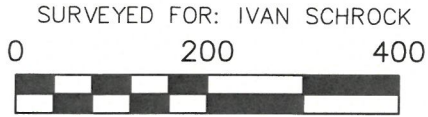

SCALE: 1"=200'

- STONE FOUND
- 5/8" REBAR FOUND
UNLESS OTHERWISE NOTED
- 5/8" REBAR SET WITH I.D. CAP
I.D. CAP MARKED "BAKER 6938"



BASIS OF BEARINGS FROM
 OHIO STATE PLANE COORDINATE
 SYSTEM, NORTH ZONE, N.A.D. 83
 (2011 ADJUSTMENT)

REFERENCES

O.R. VOL. 287 PAGE 4796
 PLAT VOL. 5 PAGE 93
 PLAT VOL. 19 PAGE 2112

I CERTIFY THIS SURVEY TO BE CORRECT
 TO THE BEST OF MY KNOWLEDGE.

DONALD C. BAKER P.S. 6938

DATE: AUG. 11, 2022

TAB\VJD

FILE NAME: WORK6\S-430-22

UPDATED NAMES: JUNE 2, 2026



BAKER SURVEYING
 138 N. CLAY STREET
 MILLERSBURG, OHIO 44654
 PH. 330-674-4788
 EMAIL: bakersurveying@gmail.com

