

SURVEY PLAT
 SE and SW QTR. SECTION 12
 T-17-N, R-14-W
 Ripley Township
 Holmes County, Ohio

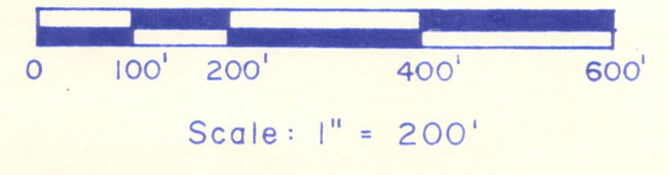

- - 5/8" Rebar Fd.
- - Fence Cor. Post
- - 5/8" x 30" Rebar with Yellow Plastic Cap Marked RUDOLPH 6449 Set

References

- Deeds
- Vol 143 pg. 65
 - Vol 171 pg. 157
 - Vol 173 pg. 284
 - Vol 175 pg. 400
 - Vol 196 pg. 849
- Previous R.G.R. Surveys

I Certify This Survey And Plat To Be Correct To The Best Of My Knowledge.

11-21-83 *Ronald G. Rudolph*
 Date Ronald G. Rudolph, Reg. Surv. 6449
 R.G. RUDOLPH SURVEYING, Inc.
 405 W. Liberty St.
 Wooster, Ohio 44691

Job No.
 G.C.M.

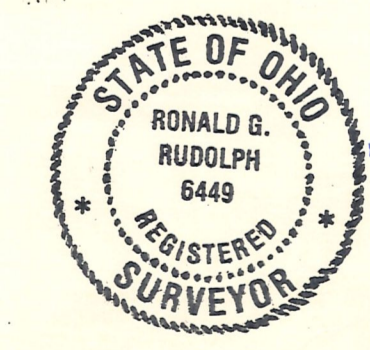

12
 13
 7
 18