

- LEGEND:
- = IRON PIN/PIPE FOUND
 - ⚡ = P.K. NAIL FOUND
 - △ = RAILROAD SPIKE FOUND
 - = NAIL FOUND
 - X = FENCE FOUND
 - = 5/8" X 30" RE-BAR W/I.D. CAP SET
 - △ = DELTA

REFERENCE DOCUMENTS:
 TAX MAP
 DEEDS AS SHOWN
 SURVEY PLATS:
 S.R. 4-238
 P. 5-163
 P. 12-50
 P. 7-52
 P. 7-111

CON'T. FROM BELOW - RIGHT.

2. THE DEED DESCRIPTIONS FOR THE PARCELS ON THE EAST SIDE OF NASHVILLE RD., LYING BETWEEN LOTS 85 AND 107 ARE VERY POOR AND DO NOT INDICATE A COMMON STRAIGHT LINE ON THEIR EASTERLY SIDES - OLD STONE AND WIRE FENCE FOUND INDICATE A STRAIGHT COMMON LINE.

3. THERE IS A SHORTAGE OF 40' +/- ALONG THE CENTER LINE OF NASHVILLE RD. FOR THE ABOVE MENTIONED PARCELS (DEEDED 808.5' +/-) PLUS LOTS 80 THROUGH 85 (PLATTED 448.5') FOR A TOTAL OF 1257' VERSUS 1216.68' MEASURED. APPARENTLY 20' +/- OF THIS SHORTAGE EXISTS BETWEEN LOTS 80 AND 85 INCLUSIVE.

I DO BELIEVE THE QUESTIONED LINES ARE ONE AND THE SAME.

CONSIDERING THE ABOVE, MONUMENTS FOUND, TESTIMONY AND DWELLING LOCATIONS; THE BOUNDARIES OF THESE TRACTS WERE ESTABLISHED AS SHOWN.

*THE LOCATION OF THE CORPORATION LINE IS VAGUE. IT IS MY OPINION, IT WAS MEANT TO COINCIDE WITH THE NORTH SIDE OF LOTS 62 THROUGH 73 AND THE NORTHEASTERLY SIDE OF THE WORKMAN, MASON, ALEXANDER AND CROSKY LOTS AS SHOWN.

I CERTIFY THIS TO BE A TRUE PLAT OF A FIELD SURVEY COMPLETED ON JULY 29, 1994:

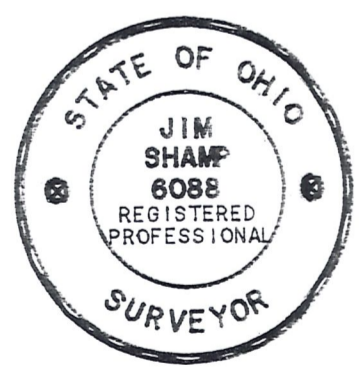

Jim Shamp
 JIM SHAMP, REG. SUR. NO. S-6088

HEARTLAND Surveying			
Jim Shamp			
5210 Twp. Rd. 257 Millersburg, OH 44654			
Phone: 216-674-4698			
SURVEY		DATE	
TOM ALEXANDER		AUGUST 3, 1994	
STATE	COUNTY	TOWNSHIP	RANGE
OHIO	HOLMES	RICHLAND	9 WEST
TOWNSHIP	SECTION		
6 NORTH	1 VILLAGE OF GLENMONT		940726

ON THE SURFACE THERE APPEARS TO BE AN OVERLAP OF THE SURVEY RECORDED IN SURVEY RECORD BOOK 4, PAGE 238 AND THE PARCELS ON THE EAST SIDE OF NASHVILLE ROAD, LYING BETWEEN LOTS 85 AND 107. BASED ON THE FOLLOWING, I DO NOT BELIEVE THIS TO BE THE CASE.

1. WITH REFERENCE TO S.R. 4/238, THERE IS A SIGNIFICANT ERROR OF CLOSURE. DEPENDING ON WHICH BEARING IS ASSUMED ON THE EAST LINE OF THIS SURVEY (THE BEARING IS ILLEGIBLE - EITHER N 5°E OR N 6°E... I ASSUME IT IS N 6°E), THE ERROR IS:

- A. N 6°E: 1:40 (OFF N 77°E, 57'); OR
- B. N 5°E: 1:70 (OFF N 69°E, 41').

ANGULAR CLOSURE IS OFF 5°, HOWEVER, IF ANGULAR CLOSURE WAS CORRECT, THE DISTANCE CLOSURE WOULD BE OFF 17' NORTH OR 4' EAST.

IN ADDITION, THE CALCULATED DISTANCE OF THE EAST LINE IS 964' BASED ON FIELD MEASUREMENTS OF MONUMENTS FOUND. THE RECORD DISTANCE IS 1001.88' (60P, 18L).

THIS SURVEY CONTAINS MAJOR DISTANCE ERROR.