

HENRY G. YODER

T.R. 99

T.R. 99

S. 89° 59' 00" W. 638.20'

N. 89° 59' 00" E. 846.15'

20.00' IRON PIN SET  
N.E. COR.  
SECTION 19

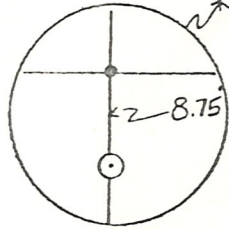

DAVID SCHLABACH

1,081.25' # 1090.00'  
N. 0° 36' 30" E.

20.435 Ac.

S. 0° 25' 36" W. 1010.00'  
990.00'

AMMON H. MILLER



S. 84° 36' 37" W. 853.98'

HENRY A. STUTZMAN ET. UX.

LEGEND

- IRON PIN SET
- POINTS USED
- #----- PROPERTY LINE
- PAVEMENT

**MAP OFFICE COPY**

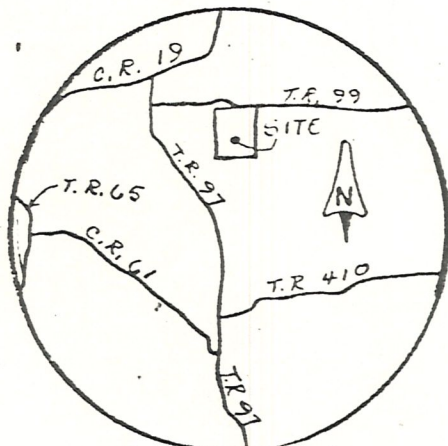

LOCATION MAP  
"NO SCALE"

HENRY A. STUTZMAN ET. UX.

BEING PART OF THE NORTH HALF  
OF THE NORTHEAST QUARTER OF  
SECTION 19 IN TOWNSHIP 8, RANGE 6  
UNITED STATES MILITARY LANDS  
MECHANIC TOWNSHIP  
HOLMES COUNTY OHIO

Buckeye Land Surveying

215 South Fifth Street - rear  
Coshocton, Ohio 43812  
Phone 1-614-622-4210

SCALE: 1"=200' SEPT. 1976

I HEREBY CERTIFY THAT THIS IS A  
TRUE DELINEATION OF A SURVEY BY  
GEORGE W. JOHNSON S.S. # 5252

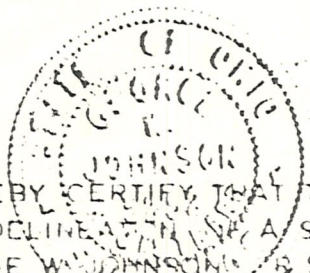

*George W. Johnson*