

Situated in the South Half of Section 17 (T-17N, R-14W) of the Congress Lands North of the Old Seven Ranges, Township of Ripley, County of Holmes and the State of Ohio.

STEPHEN E. ANDREWS  
 PEGGY L. ANDREWS  
 O.R. Bk. 287, Pg. 832

STEPHEN E. ANDREWS  
 PEGGY L. ANDREWS  
 O.R. Bk. 287, Pg. 836

T.R. 503 - 60' RW

T.R. 505  
 40' RW

T.R. 504 - 40' RW  
 (NON-MAINTAINED)

ROBERT J. JURSIK, SR.,  
 TRUSTEE OF THE ROBERT J.  
 JURSIK, SR. REVOCABLE TRUST  
 O.R. Bk. 262, Pg. 6386  
 PN: 23-00212.000

PN: 23-00212.001

DAVID J. HERSHBERGER  
 FANNIE A. HERSHBERGER  
 O.R. Bk. 288, Pg. 1017

IVAN R. SWARTZENTRUBER  
 LAURA J. SWARTZENTRUBER  
 O.R. Bk. 285, Pg. 2287

R&R PROPERTY  
 RENTALS, LLC  
 O.R. Bk. 290, Pg. 783

24.274 ACRES  
 0.544 Acres in Road RW

PN: 23-00211.001

16.183 ACRES  
 0.365 Acres in Road RW

PN: 23-00211.000

**\* MASTER PLAT \***  
 Action 1) Convey 40.279 acre parcel, 40.563 acre parcel, 24.274 acre parcel & 16.183 acre parcel

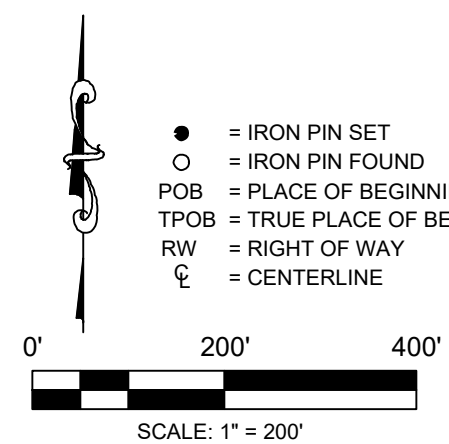

The Basis of Bearings is Ohio State Plane Coordinates, North Zone, NAD 1983 (2011).

All Iron pins set are 30" X 5/8" rebar with a plastic cap stamped "CASTLE SURVEYING".

I, the undersigned, hereby certify that the parcel of land shown hereon is in accordance with the provisions of Chapter 4733-37 of the Ohio Administrative Code. Monuments were found or set as indicated hereon. Dimensions are expressed to US Survey Feet and decimal parts thereof. Bearings shown are oriented to the meridian as indicated hereon and are for the sole purpose of describing the relative angular value between lines.

*Joshua C. Lambert*

Joshua C. Lambert - Registered Professional Surveyor No. 8666

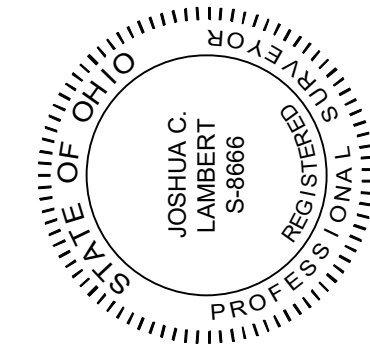

- SOURCES USED:**
- DEEDS (AS SHOWN)
  - SURVEYS:
    - BAKER - 10/08/2021
    - BAKER - 02/06/2023
    - GALBRAITH (PIONEER) - 08/11/2023
  - HOLMES COUNTY GIS

PLAT OF SURVEY

ROBERT J. JURSIK, SR., TRUSTEE OF THE ROBERT J. JURSIK, SR. REVOCABLE TRUST DATED JULY 22, 2015

12780 T.R. 503  
 BIG PRAIRIE, OHIO 44611



PREPARED BY:  
 CASTLE SURVEYING, LLC  
 50 NORTH AVE. N.E., OFFICE D  
 MASSILLON, OHIO 44646  
 PHONE: 330-754-5099

SCALE: 1" = 200' | ISSUE DATE: 12/02/2024 | FIELD DATE: 11/13/2024 | FILE NUMBER: C-24288

APPROVED FOR TRANSFER ONLY  
 NO SUBDIVISION PLAT REQUIRED  
 (O.R.C. 711.001 & 711.131)  
 Lot(s) not for building unless approved by Board of Health  
 HOLMES CO. PLANNING COMMISSION  
 By AO Date 2/21/2025

**Plat Approved**  
 Holmes County Map Office  
 2/19/2025 MM