

ORV 269 Pgs 1311, 1314,
1317, 1320

Clark Township S.W. Qtr. Section 23 T-8 N; R-5 W Holmes County, Ohio

SURVEYED FOR: Junior Troyer

0 100 200

Scale 1"=100'

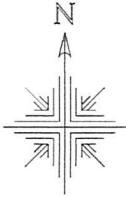

REFERENCES:

Deeds as shown

Surveys

Plat book 18 page 481

Plat Book 19 page 626

Basis of Bearing from Grid North, Ohio State Plane
Coordinate System, North Zone, NAD 83.

MASTER PLAT:

The Purpose of this Survey

(Action 1): Convey the 4.000 acre parcel of Mervin A. Hershberger and Katie R. Mast to Junior L. Troyer.

(Action 2): Convey the 1.000 acre parcel of Junior L. Troyer to Junior L. Troyer.

(Action 3): Combine the 1.000 acre parcel and the 4.000 acre parcel of Junior L. Troyer for new 5.000 acre parcel.

(Action 4): Establish 50 foot secondary access easement for the new 5.000 acre parcel over Mervin A. Hershberger and Katie R. Mast.

- Stone Found
- 5/8" Rebar Found unless noted
- 5/8" Capped Pin Found "Baker"
- 5/8" Capped Pin Set "Galbraith"
- Point

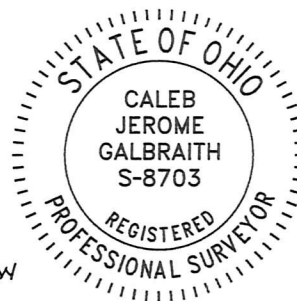

5.000 Acres

(4.000 Acres)
Mervin A. Hershberger
Katie R. Mast
O.R. Vol. 132 Page 848
PPN 0300024003

I certify this survey to be correct to
the best of my knowledge.

Caleb Jerome Galbraith P.S. 8703
Date: June 19, 2019
Job ID: 6719

Abe N. Miller, trustee
Fannie J. Miller, trustee
O.R. Vol. 255 Page 4850
PPN 0300003000

Centerline 50'
Secondary Easement

Mahlon and Anna Burkholder
O.R. Vol. 133 Page 451
PPN 0300024000

Junior L. Troyer
O.R. Vol. 212 Page 769
PPN 0300024004

State Route 643
(RW Varies)

Marvin M. and Susan D. Mast
O.R. Vol. 186 Page 2263
PPN 0300025004

Holmes County 1062.68' Section Line
Coshocton County N 88°25'30" W

Pioneer Surveying & Services, LLC.
5434 Township Road 377
Millersburg, Ohio 44654
Phone: 330-276-0220
Email: caleb@pioneersurveyingandservices.com

APPROVED FOR TRANSFER ONLY
NO SUBDIVISION PLAT REQUIRED

(O.R.C. 711.001 & 711.131)
Lot(s) not for building unless
approved by Board of Health.

HOLMES CO. PLANNING COMMISSION

By A Date 9/16/19



PLAT APPROVED

9/16/2019 JD