

THE BELOW LICENSED PROFESSIONAL ENGINEER CERTIFIES THAT TO THE BEST OF HIS KNOWLEDGE AND BELIEF THIS PLAN GRAPHICALLY SHOWS ALL THE PARTICULARS OF THE BUILDINGS AS CONSTRUCTED.

Harry D. Matter
 HARRY D. MATTER, REGISTERED PROFESSIONAL ENGINEER E-040167 DATE 10/3/16

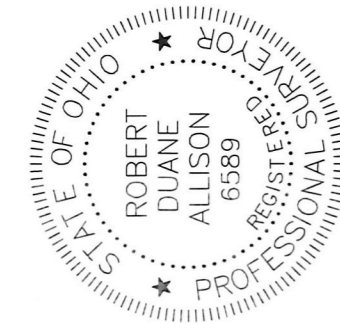

201600102091
 B: 19 P: 3085
 FILED FOR RECORD IN
 HOLMES COUNTY, OH
 ANITA HALL, COUNTY RECORDER
 10/26/2016 9:05 AM
 SMALL PLAT - 40.00
 PAGES: 1

ORV 258 Pg 860

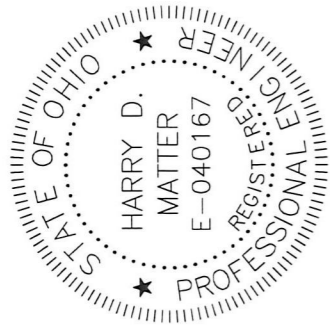

THE BELOW LICENSED PROFESSIONAL SURVEYOR CERTIFIES THAT TO THE BEST OF HIS KNOWLEDGE AND BELIEF THIS PLAN ACCURATELY REFLECTS THE LOCATION OF IMPROVEMENTS AND RECORDED EASEMENTS.

Robert D. Allison
 ROBERT D. ALLISON, REGISTERED PROFESSIONAL SURVEYOR 6589 DATE 10/3/2016

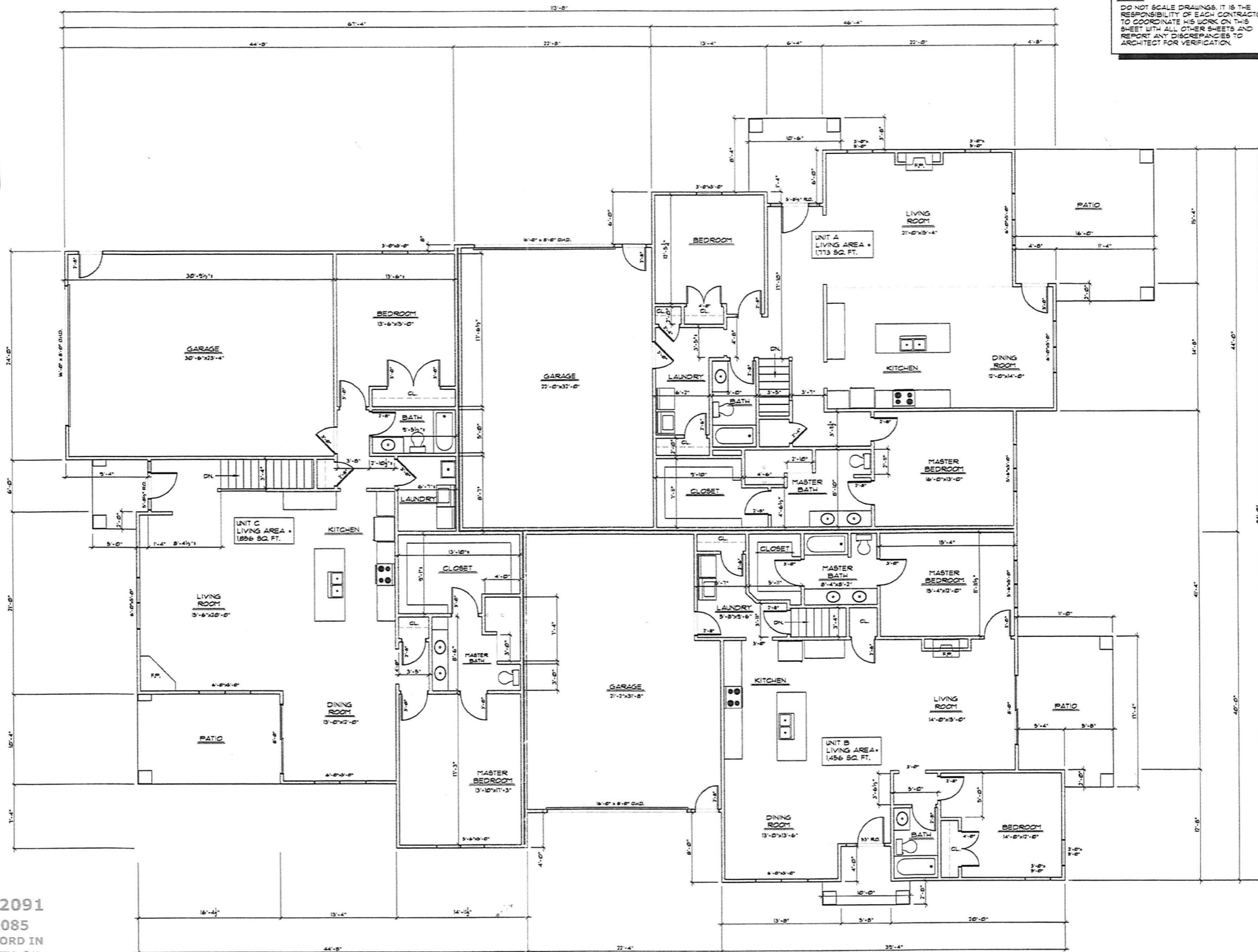

NOTE:
 DO NOT SCALE DRAWINGS. IT IS THE RESPONSIBILITY OF EACH CONTRACTOR TO COORDINATE HIS WORK ON THIS SHEET WITH ALL OTHER SHEETS AND REPORT ANY DISCREPANCIES TO ARCHITECT FOR VERIFICATION.

FLOOR PLAN

SCALE: 3/16" = 1'-0"

BUILDING 11, UNITS 23, 24 AND 25

FIRST FLOOR

BA WILDER
 Architectural Services
 Commercial, Industrial, & Residential Design
 407 4th Street NW Suite B New Philadelphia, Ohio 44663 Phone (330) 339-4854 Fax (330) 339-4219

Brace A Walker, Lic #11195
 Expiration Date 12/31/17
 © COPYRIGHT 2016
 ALL RIGHTS RESERVED. ARRANGEMENTS AND PLANS PREPARED OR MODIFIED BY THE DRAWING AND ARCHITECTURAL SERVICES AND WERE CREATED, REVISED AND DEVELOPED OR CHANGED IN CONNECTION WITH THE SPECIFIC PROJECT HEREIN. SUCH AS BY PERSON, FIRM OR CORPORATION FOR ANY PURPOSE WHATSOEVER WITHOUT THE WRITTEN PERMISSION OF BA WILDER ARCHITECTURAL SERVICES, LLC.

New Building For:
The Cove at Walnut Creek
 Walnut Creek, Ohio 44687

JOB NO	16-1720
Start Date	2-23-16
Part Date	6-14-16
Revisions	

