

WALNUT CREEK TOWNSHIP
 N.E. QTR. SECTION 19
 T-9 N; R-5 W
 HOLMES COUNTY, OHIO

SURVEYED FOR: ADEN TROYER

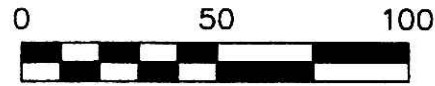

SCALE: 1"=50'

- 5/8" REBAR FOUND UNLESS OTHERWISE NOTED
- 5/8" REBAR WITH I.D. CAP SET I.D. CAP MARKED "BAKER 6938"

REFERENCES

- DEED VOL. 201 PAGE 352
- DEED VOL. 271 PAGE 157
- O.R. VOL. 71 PAGE 252
- PLAT VOL. 14 PAGE 967
- PLAT VOL. 19 PAGE 894
- PLAT VOL. 2 PAGE 230
- BEARINGS FROM PLAT VOL. 14 PAGE 967



APPROVED FOR TRANSFER ONLY
 NO SUBDIVISION PLAT REQUIRED
 (O.R.C. 711.001 & 711.131)
 Lot(s) not for building unless
 approved by Board of Health.
 HOLMES CO. PLANNING COMM.

By Donald C. Baker Date 11/11/07

I CERTIFY THIS SURVEY TO BE CORRECT
 TO THE BEST OF MY KNOWLEDGE.

Donald C. Baker

DONALD C. BAKER P.S. 6938
 DATE: OCT. 22, 2007

FDB\AEG
 File Name: WORK2\S--634--07

19 | 19 564.30'
 19 | 19 S 89°20'10" E QTR. SECTION LINE

ALVIN and RUTH YODER
 D.V. 198-153

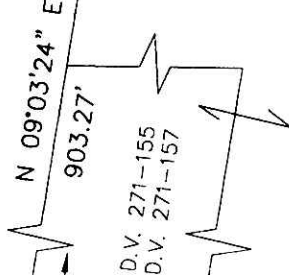

RUTH YODER
 O.R. 71-252

N 08°24'24" E
 245.02'

50.00'

DAVID M. and JANICE C. GOODING
 O.R. 193-1207

S 88°29'50" E
 183.48'

CENTERLINE S.R. 39

S 52°56'59" E
 93.97'

S.R. 39
 R/W VARIES

44.93'

97.84'

0.346 AC.
 SHOP

N 30°02'16" E
 166.06' TOTAL

114.53'

36.65'

51.53'

87.90'

N 56°35'57" W

159.55' TOTAL

S 33°24'03" W

64.96'

S 04°14'35" E

15.52'

300.72'

EXISTING DRIVE TO SHOP

CENTERLINE 15' EASEMENT

ADEN E. and BETTY TROYER
 D.V. 201-352

200800054330
 PAUL A
 MILLER LAW
 MILLERSBURG OH

200800054330
 Filed for Record in
 HOLMES COUNTY, OH
 SALLY MILLER
 01-24-2008 At 01:36 pm.
 SMALL PLAT
 DR Book 19 Page 1235 - 1235

OR 202 p 633

Instrument
 200800054330 DR 19 1235
 Book Page



DONALD C. BAKER SURVEYING
 138 N. CLAY ST.
 MILLERSBURG, OHIO, 44654
 PH. 330-674-4788
 FAX. 330-674-6027

PLAT APPROVED

12/19/2007