

DETWEILER SUBDIVISION REPLAT OF LOT 1 & ADDITIONAL LANDS (P.V. 2-176)

(FINAL)

AGENT:
NATHAN MAST
5082 TWP. RD. 419
SUGARCREEK, OHIO 44681
PHONE: 330-852-4925

200800054093
Filed for Record in
HOLMES COUNTY, OH
SALLY MILLER
01-08-2008 At 02:11 pm.
PLAT MED 43.20
OR Book 19 Page 1225 - 1225

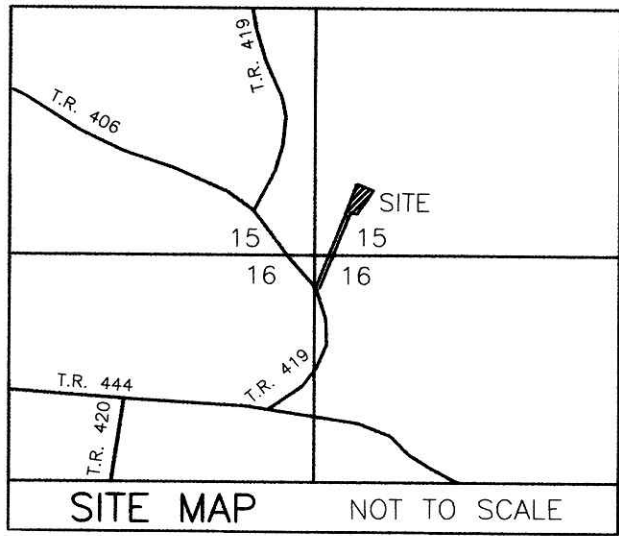

WAYNE L. and ESTA YODER
D.V. 173-181

LOT 2
5.026 ACRES
MICHAEL A. and MARY BETH MILLER
O.R. 168-2150

NATHAN LEE and
ANNA MAST
O.R. 196-1632

200800054093
NATHAN MAST
5082 TR 419
SUGARCREEK OH 44681

- REFERENCES
- DEED VOL. 173 PAGE 181
 - O.R. VOL. 168 PAGE 2150
 - O.R. VOL. 196 PAGE 1632
 - PLAT VOL. 2 PAGE 176
 - BEARINGS FROM PLAT VOL. 2 PAGE 176

THIS LOT IS FOR RESIDENTIAL PURPOSES ONLY.
NO FURTHER SPLITS WILL BE PERMITTED
WITHOUT REPLATTING SAID LOT.
NOTE: BUILDING SETBACK LINES ARE 15'
OFF SIDE AND REAR LINES AND
30' OFF ROAD RIGHT OF WAY

For erosion and sedimentation control, the landowner will follow the Rainwater and Land Development, Ohio's Standards for Stormwater Management and Urban Street Protection. A copy of the Rainwater and Land Development, Ohio's Standards is available at the Holmes Soil and Water Conservation District Office: 52 W. Clinton Street Millersburg, Ohio 44654
State regulated permits and plans may be required by the Ohio Environmental Protection Agency to address stormwater and sedimentation issues.

ACREAGE IN LOT 5.026 ACRES
ACREAGE IN ROAD DEDICATION 0.000 ACRES
TOTAL ACREAGE 5.026 ACRES

NOTE: SIGN IN PERMANENT BLACK INK
CERTIFICATE OF OWNERSHIP AND DEDICATION
We certify that we are the owners of the property shown and described hereon and that we hereby adopt this plan of subdivision with our free consent and establish the minimum building restriction lines.
Michael A. Miller 12-08-07
MICHAEL A. MILLER DATE
Mary Beth Miller 12-08-07
MARY BETH MILLER DATE

CERTIFICATE OF DEDICATION OF EASEMENT
We, the undersigned, grant unto hereon shown Lot 2, their heirs and assigns, the 50' easement for the purposes of ingress, egress and utilities as shown on this plan of subdivision.
Nathan Lee Mast 12-08-07
NATHAN LEE MAST DATE
Anna Mast 12-08-07
ANNA MAST DATE
John R. Chupp 12-17-07
JOHN R. CHUPP DATE
Ruth K. Chupp 12-17-07
RUTH CHUPP DATE
Andrew R. Coblenz 12-11-07
ANDREW R. COBLENTZ DATE
Mary Ellen Coblenz 12-11-07
MARY ELLEN COBLENTZ DATE

CERTIFICATE OF APPROVAL OF WATER SUPPLY AND SEWAGE TREATMENT SYSTEMS
I hereby certify that the subdivision plat entitled DETWEILER SUBDIVISION, REPLAT OF LOT 1 & ADDITIONAL LANDS meets the requirements of the Board of Health for water supply and sewage treatment and is hereby approved for recording. The issuance of permits to install a private water system and on-site sewage treatment system of any lot is dependent on a site specific evaluation prior to the start of any construction.
D. McFadden 12-19-2007
Health Commissioner DATE

CERTIFICATE OF APPROVAL BY THE HOLMES SOIL AND WATER CONSERVATION DISTRICT
I hereby certify that I have approved the subdivision plat and/or agreements or provisions for sedimentation and erosion control as stated or shown hereon.
Michelle Wood 12-19-07
Holmes Soil and Water Conservation District DATE

CERTIFICATE OF APPROVAL BY THE COUNTY COMMISSIONERS
I hereby certify that the County Commissioners have approved the subdivision plat as shown hereon.
John R. Chupp 12/27/07
Chairman, County Commissioners DATE

CERTIFICATE OF APPROVAL OF PLAT
I hereby certify that I have approved the plat shown hereon.
Christopher R. Young, P.E., P.S. 12/19/07
County Engineer DATE

CERTIFICATE OF APPROVAL FOR RECORDING
I hereby certify that the subdivision plat shown hereon has been found to comply with the subdivision regulations for Holmes County, Ohio, with the exception of such variances, if any, as prenoted in the minutes of the Holmes County Planning Commission and that it has been approved for recording in the office of the County Recorder.
Paul R. Olin 12/19/07
Holmes County Planning Commission DATE

CERTIFICATE OF ACCURACY
I hereby certify that the plan shown and described hereon is a true and correct survey to the accuracy required by the Holmes County Planning Commission and that the monuments have been placed as shown hereon.
Jamie D. Darr 100 23, 2007
Jamie D. Darr P.S. 7755 DATE



<p>DONALD C. BAKER SURVEYING 138 N. CLAY STREET MILLERSBURG, OHIO 44654 PH. 330-674-4788 FAX 330-674-6027</p>	<p>WALNUT CREEK TOWNSHIP S.E. QTR. SECTION 15 N.E. QTR. SECTION 16 T-9 N; R-4 W HOLMES COUNTY, OHIO</p>	<p>SCALE: 1"=100'</p> <p>DATE: NOV. 15, 2007 JDD\DB WORK3\S-534-07\ERZ</p>	<p>● 5/8" REBAR FOUND UNLESS OTHERWISE NOTED</p>
---	---	--	--

TRANSFER NOT NECESSARY
DATE January 8, 2008
AUDITOR *Jacob M. Bee*