

KILLBUCK TOWNSHIP  
 N.W. QTR. SECTION 15  
 T-8 N; R-7 W  
 HOLMES COUNTY, OHIO  
 SURVEYED FOR: JERRY VALENTINE

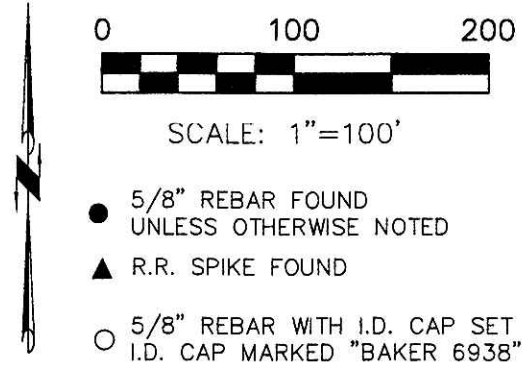

REFERENCES

- DEED VOL. 276 PAGE 365
- O.R. VOL. 166 PAGE 121
- PLAT VOL. 12 PAGE 280
- PLAT VOL. 16 PAGE 122
- BEARINGS FROM PLAT VOL 16 PAGE 441

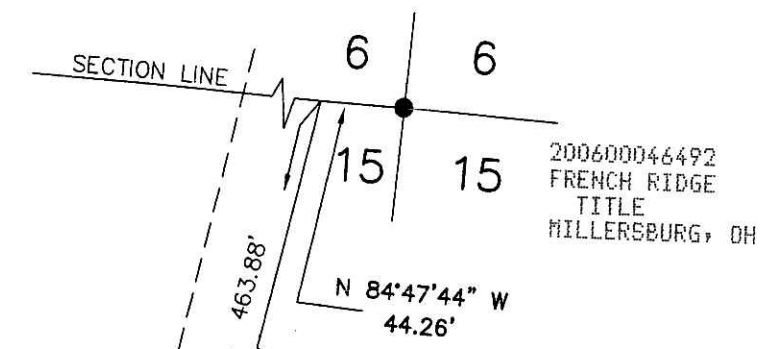

CURVE DATA

Δ	-06°48'12"
R	-3906.64'
ARC	-463.88
T	-232.21
CH	-463.61
BRG	-S 14°26'38" W

200600046492  
 Filed for Record in  
 HOLMES COUNTY, OH  
 SALLY MILLER  
 10-26-2006 At 02:57 pm.  
 SMALL PLAT 40.00  
 OR Book 19 Page 847 - 847  
 OR 192p2167

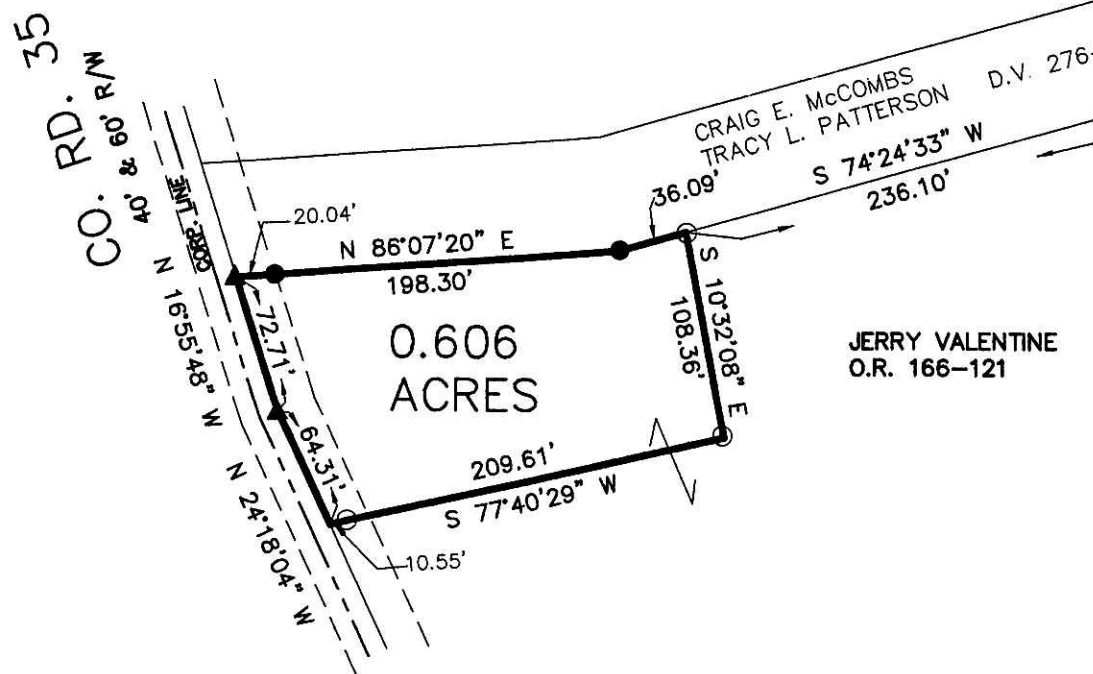

DONALD C. BAKER SURVEYING  
 138 N. CLAY ST.  
 MILLERSBURG, OHIO, 44654  
 PH. 330-674-4788  
 FAX. 330-674-6027

I CERTIFY THIS SURVEY TO BE CORRECT TO THE BEST OF MY KNOWLEDGE.

*Donald C. Baker*  
 DONALD C. BAKER P.S. 6938  
 DATE: DEC. 14, 2004

KES\ALG  
 File Name: WORK2\S-839-04\KES

PLAT APPROVED

10/18/2006

Instrument 200600046492 OR Book 19 Page 847