

Instrument Book Page  
200300025334 DR 18 700

0 30' 60'



SCALE: 1"=30'

- 5/8" REBAR FOUND UNLESS OTHERWISE NOTED
- 5/8" REBAR WITH I.D. CAP SET I.D. CAP MARKED "BAKER 6938"

REFERENCES:

O.R. VOL. 139 PAGES 511  
 PLAT VOL. 1 PAGES 379, 380  
 PLAT VOL. 2 PAGES 358-362

BEARINGS PLAT VOL. 2 PAGES 358-362

LAKELAND BEACH SUBDIVISION  
 LOTS 10 & 11

(P.V. 1 P. 379,380)

RIPLEY TOWNSHIP  
 N.W. QTR. SECTION 30  
 T-18 N; R-14 W  
 HOLMES COUNTY, OHIO

SURVEYED FOR: MIKE KICK

200300025334  
 HOLMES CTY  
 TITLE  
 MILLERSBURG, OH

200300025334  
 Filed for Record in  
 HOLMES COUNTY, OH  
 SALLY MILLER  
 08-12-2003 At 02:19 pm.  
 SMALL PLAT 40.00  
 DR Book 18 Page 700 - 700  
 OR Vol 160 page 345

INDEXED



I CERTIFY THIS SURVEY TO BE CORRECT TO THE BEST OF MY KNOWLEDGE.

*Donald C Baker*  
 DONALD C. BAKER PS 6938

FCC\KES DATE: MAY 20, 2003

File Name: C:\WORK\S-366-03



DONALD C. BAKER SURVEYING  
 138 N. CLAY ST.  
 MILLERSBURG, OH 44654  
 PH. 330-674-4788  
 FAX: 330-674-6027

PLAT APPROVED

*7/14/2003*

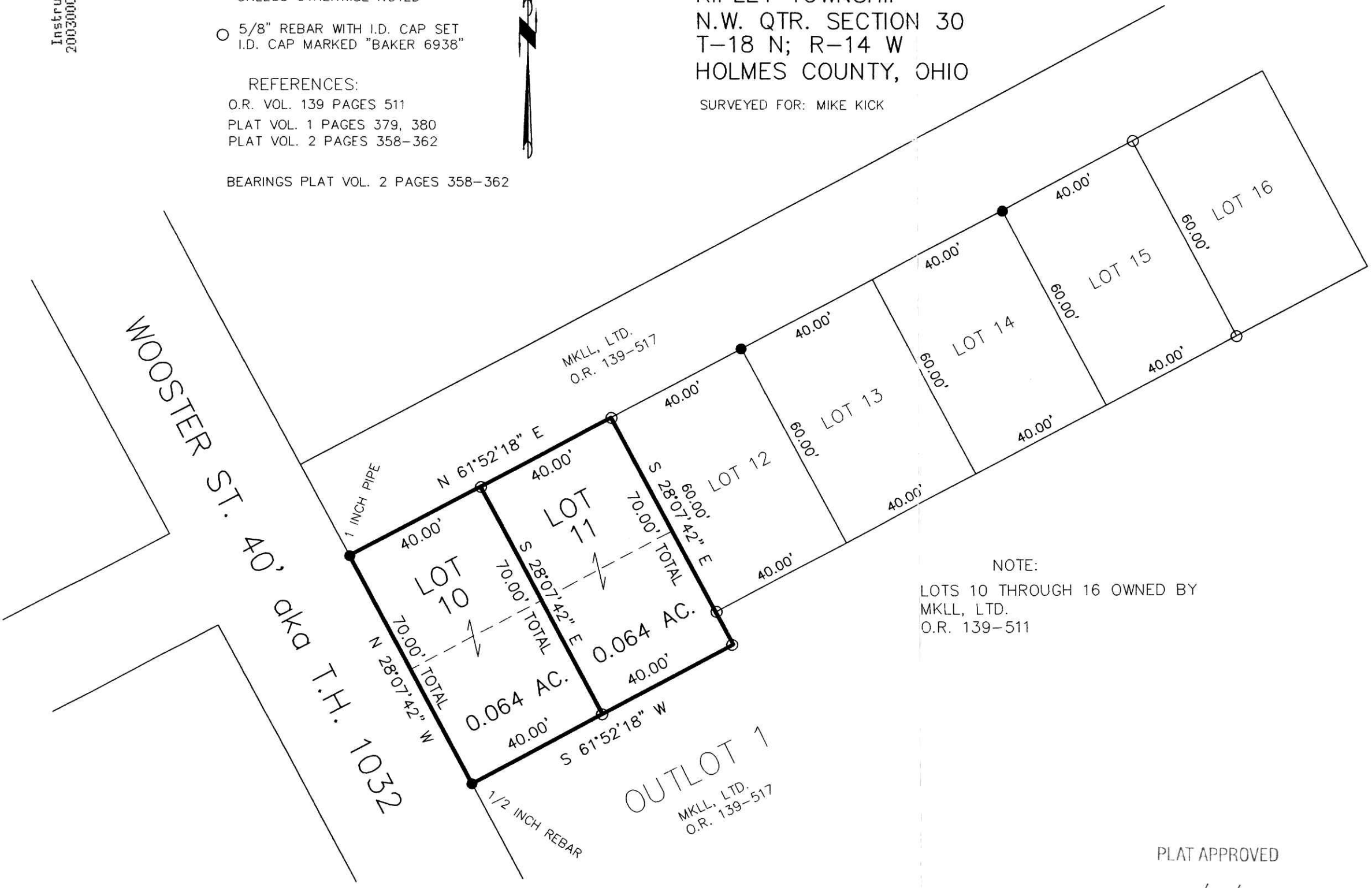

NOTE:  
 LOTS 10 THROUGH 16 OWNED BY  
 MKLL, LTD.  
 O.R. 139-511

OUTLOT 1  
 MKLL, LTD.  
 O.R. 139-517

WOOSTER ST. 40' aka T.H. 1032