

SURVEY PLAT
for
HASSEMAN, ETAL

part of
S.E. 1/4 SECTION 25

T-15 , R-11
PAINT TOWNSHIP

HOLMES Co. OHIO
JUNE, 2000

200000002711
Filed for Record in
HOLMES COUNTY, OH
SALLY MILLER
On 06-22-2000 At 11:59 am.
PLAT MED 21.60
OR Book 17 Page 536 - 536
oR vol 54 pg 165

INDEXED

MILO J. MILLER
D.V. 264-997

200000002711
AMERICAN
TITLE
CANTON, OH

MILO J. MILLER
O.R. 756 Pg 618

BEARING BASIS

N.W. COR
S.W. QTR
SEC. 32
STARK COUNTY

S 84° 55'13" E



BEARING BASIS:

NORTH LINE SW 1/4 SEC. 32 STARK Co.
FROM STARK Co. O.R. 756 Pg 618
BEARING S 84° 55'13" E

PLAT APPROVED

6/8/00

I HEREBY CERTIFY THIS PLAT ACCURATELY
REPRESENTS A SURVEY MADE UNDER MY SUPERVISION
IN ACCORDANCE WITH THE MINIMUM STANDARDS FOR
BOUNDARY SURVEYS IN OHIO, PUBLISHED IN CHAPTER
4733-37 OF THE OHIO ADMINISTRATIVE CODE.

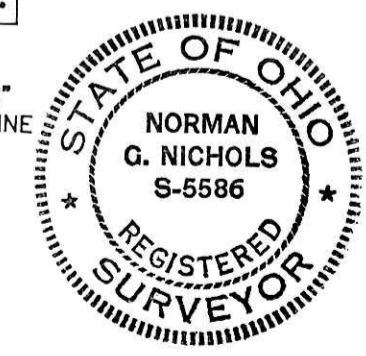

Norman G. Nichols 6/8/00
NORMAN G. NICHOLS DATE
REGISTERED PROFESSIONAL SURVEYOR # 5586

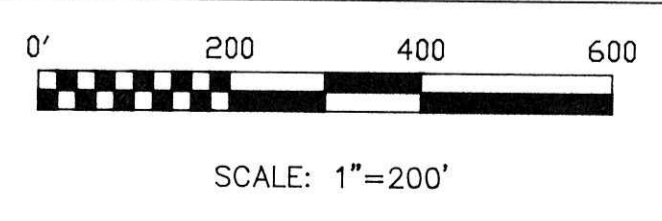

- LEGEND
- 5/8" IRON BAR FOUND & USED (UNLESS NOTED)
 - ⊗ IRON PIPE FOUND
 - ⊙ #5 REBAR W/NGN #5586 CAP SET
 - ⊠ STONE FD. W/"X".
 - △ RR SPIKE FOUND
 - ▲ RR SPIKE SET
 - P.K. NAIL FOUND
 - ⚡ P.K. NAIL SET

NICHOLS FIELD SERVICES, INC.
526 4th STREET NW
CANTON, OHIO 44703



TEL (330) 453-6688
FAX (330) 453-1764

NFSI-1039

