

Stone at N.W. corner 587°00'00" E N. Line Lot 11, 1st Qtr. Approximate E.C.R. 1687
 Lot 11, 1st Qtr., 339.4' + 112.9' = 452.30' T9N, R5W, of Walnut
 T9N, R5W P.B. 10 Pg. 462 Creek Twp., Hol. Co., Ohio

John H. & Arlene
 Wengert
 Vol. 245 Pg. 277

APPROVED FOR TRANSFER ONLY
 NO SUBDIVISION PLAT REQUIRED
 (O.R.C. 711.001 & 711.131)
 Lot(s) not for building unless
 approved by Board of Health.
 HOLMES CO. PLANNING COMM

By TRM Date 10-27-94
 940187

Mahlon & Mary S. Miller
 Vol. 236 Pg. 319 N9°24'11"E
 108.09'

I. Pin Fd
 Mahlon M. & Mary S.
 Miller
 Vol. 204 Pg. 681
 P.B. 8 Pg. 371

Chrystal M. Hostetler
 Vol. 209 Pg. 242

29.73'
 I. Pipe Fd
 56°24'00"W 113.3'
 Jacob D. Jr. & Mary Graber
 83.57' Vol. 228 Pg. 424
 I. Pipe Fd P.B. 10 Pg. 462

N6°22'26"E 31.80' 2
 I. Pin Fd
 573°38'00"E 130.92' (Mens)
 131.00' Rec.
 I. Pin Fd 13.27'
 I. Pin Set

580°18'21"E 115.90' I. Pin Fd
 0.6703 Ac. Total
 part of Vol. 192 Pg. 825
 and Vol. 103 Pg. 578
 0.6701 Vol. 192 Pg. 825
 0.0002 Vol. 103 Pg. 578
 36.95' 562°14'36"W
 2.51' + 34.44'
 I. Pin Set
 11.35' I. Pin Fd
 581°11'48"E
 13.27'
 163.83' Total
 Recd.

Moses J.
 Hostetler
 Vol. 192 Pg. 825
 & Vol. 103 Pg. 578
 I. Pin Set
 134.25'
 P.P. Fd

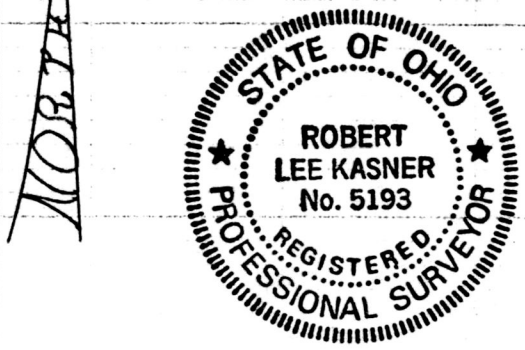
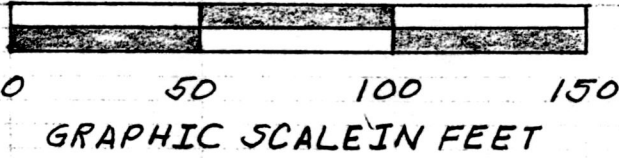

PLAT OF A SURVEY FOR
 MOSES J. HOSTETLER

Grant to
 known as part of Lot 11, 1st Qtr.,
 T9N, R5W, of Walnut Creek Twp.,
 Hol. Co., Ohio.

Robert L. Kasner P.S. 5193
 189989

REC'D 189989 RECORDED P.E. 28820
 AT 10:55 o'clock Am. FEE \$ 20.00 1013194

NOV 01 '94 NOV 02 '94

INDEXED

PLAT APPROVED
 10/27/94