

HEARTLAND Surveying

Jim Shamp
5210 Twp. Rd. 257 Millersburg, OH 44654
Phone: 216-674-4698

SURVEY			DATE
JOHN & ELI WEAVER			NOVEMBER 18, 1991
STATE	COUNTY	TOWNSHIP	RANGE
OHIO	HOLMES	RIPLEY	14 WEST
TOWNSHIP	SOUTHWEST QUARTER OF		SECTION 8
17 NORTH	RIPLEY TWP.		



I CERTIFY THIS TO BE A TRUE PLAT OF A FIELD SURVEY COMPLETED ON NOVEMBER 13, 1991:

Jim Shamp
JIM SHAMP, REG. SUR. NO. 9-6088

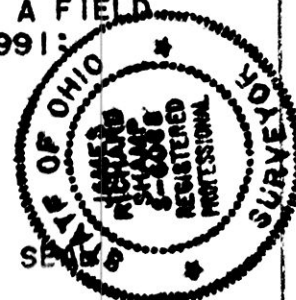

DOCUMENTS: DEEDS AS SHOWN.

- PLATS V. 5, P. 12;
- V. 6, P. 49;
- V. 7, P. 278;
- V. 7, P. 586;
- V. 12, P. 616;
- V. 12, P. 715.

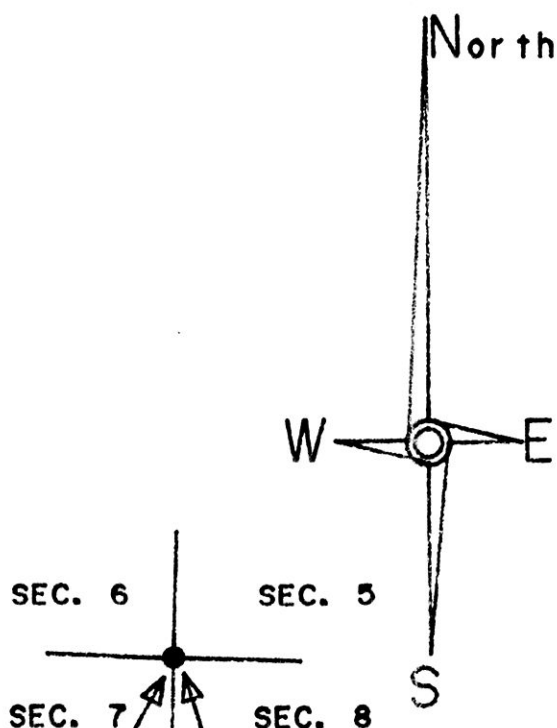

SEC. 6 SEC. 5
SEC. 7 SEC. 8

2305.22'
964.43'
1340.79'
30.00'
N 01°30'00"E
351.27'

N 89°51'30"E
168.73'

S 38°04'45"E
163.07'

S 24°13'49"E
261.91'

This 2.387 acre parcel is not approved for any use that generates wastewater.

Jim Shamp 12/12/91
Sanitarian Date

SPLIT APPROVED # 910196

2.387 ACERS

JOHN A. & CLARA WEAVER
V. 190, P. 855

C.L. T.R. 506
(OLD T.R. 317)
60' R/W

PATRICIA JEAN CERMAK
V. 189, P. 541

N 87°40'51"W
386.30'

SECTION LINE & C.L.
T.R. 501 (OLD T.R. 325)
60' R/W

- LEGEND:
- - I.P. FOUND.
 - - STONE WITH "X" FOUND.
 - - I.P. SET (5" X 30" RE-BAR W/PLASTIC LINES CAP MARKED "JIM SHAMP 6088").
 - Ⓐ - DISTANCE ESTABLISHED USING PLATS V. 6, P. 49; V. 7, P. 278; & V. 12, P. 616.
 - * BEARINGS ESTABLISHED FROM PLAT V. 7, P. 278.

HALF SECTION
S.E. COR.
N.W. QTR.

174742

Rec'd. DEC 20 1991

AT 10:26 O'CLOCK

Recorded DEC 23 1991

Holmes Co. Ohio Fee

Plat Vol 12 Pg 821
Deed vol 253 pg 855

INDEXED

PLAT APPROVED
12/18/91

Recorder Mary Ellen Signer