

HOLMES COUNTY
DEDICATION PLAT OF
GLENMONT - WESTERN ROAD
S.H. (I.C.H.) No. 676

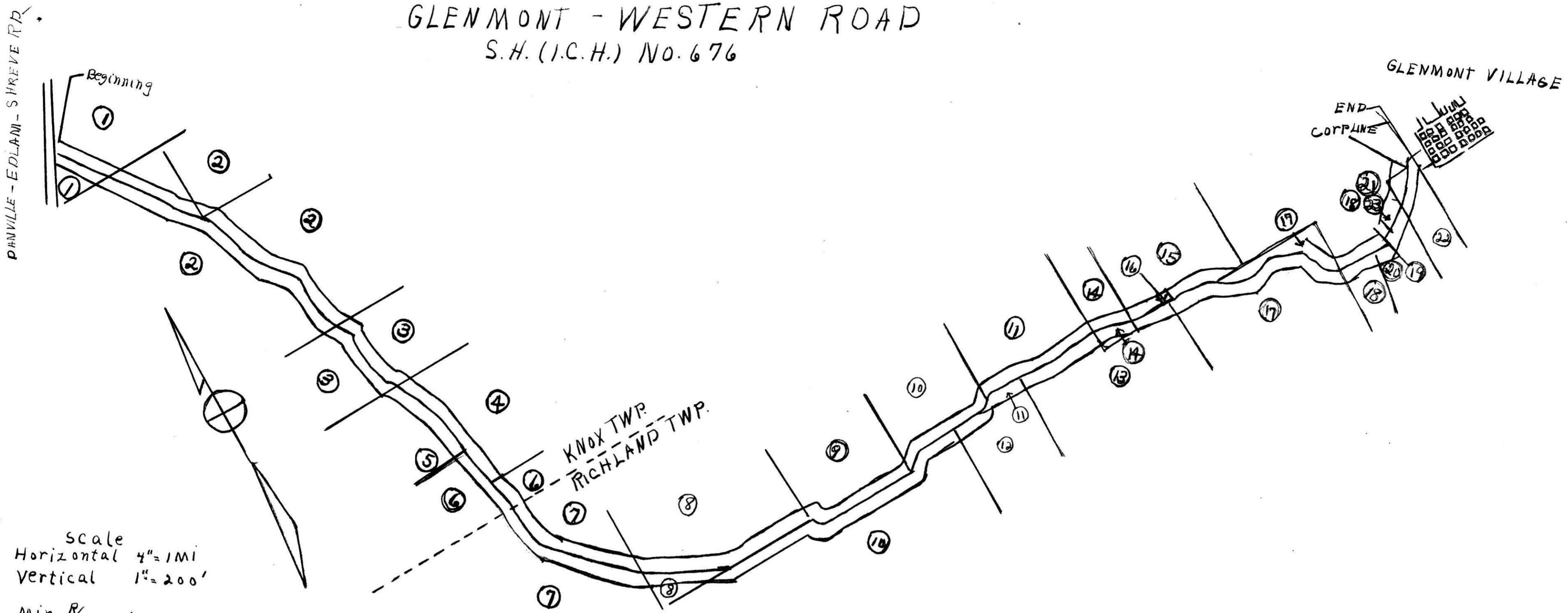

We, the undersigned owners of the above described property, dedicate the same to public use for road and other public purposes consistent therewith clear of all obstructions which interfere with the improvement and/or maintenance of the highway, at the time of improvement.

Parcel No.	Owners	Witnesses	Parcel No.	Owners	Witnesses
21	S. L. Mackey	L. Mast E. J. Frey	1	L. P. Young	L. Mast E. J. Frey
21	Bertha L. Mackey	L. Mast E. J. Frey	1	Dora E. Young	L. Mast E. J. Frey
23	Belle Conner	L. Mast E. J. Frey	9	Walter Ruble	L. Mast E. J. Frey
19	John Jones	L. Mast E. J. Frey	13	Charles J. Dete	L. Mast E. J. Frey
19	Lucy Jones	L. Mast E. J. Frey	15	J. W. Augsberger	L. Mast E. J. Frey
18	Harvey Clark	L. Mast E. J. Frey	15	Laura Augsberger	L. Mast E. J. Frey
18	Lola Clark	L. Mast E. J. Frey	4	The Farmers and Savings Bank by D. C. House Cashier	L. Mast E. J. Frey
16	Paul S. Neal	L. Mast E. J. Frey	6	L. F. Young	L. Mast E. J. Frey
16	Bernice Neal	L. Mast E. J. Frey	6	Mona Young	L. Mast E. J. Frey
14	J. A. Marks	L. Mast E. J. Frey			
14	Kate Marks	L. Mast E. J. Frey			
12	Willis H. Manchester	L. Mast E. J. Frey			
11	Geo. Manchester	L. Mast E. J. Frey			
11	Maggie Manchester	L. Mast E. J. Frey			
10	Charles J. Manchester	L. Mast E. J. Frey			
10	Lizzie Manchester	L. Mast E. J. Frey			
8	Bertha Weaver	L. Mast E. J. Frey			
7	Frieda Lang	L. Mast E. J. Frey			
3	Herman Young	L. Mast E. J. Frey			
3	Erma Young	L. Mast E. J. Frey			
2	John M. Young	L. Mast E. J. Frey			
2	Mabel Young	L. Mast E. J. Frey			

County of Holmes
State of Ohio
On this 29 day of May 1936, before me a Notary Public in and for said County and State personally appeared: S. L. Mackey and Bertha L. Mackey, husband and wife; John Jones and Lucy Jones, brother and sister; Harvey Clark and Lola Clark, husband and wife; Paul S. Neal and Bernice Neal, husband and wife; J. A. Marks and Kate Marks, husband and wife; Willis Manchester; Geo. Manchester and Maggie Manchester, husband and wife; Charles J. Manchester and Lizzie Manchester, husband and wife; Bertha Weaver; Frieda Lang; Herman Young and Erma Young, husband and wife; John M. Young and Mabel Young, husband and wife; L. F. Young and Dora E. Young, husband and wife; Walter Ruble; S. W. Augsburger and Laura Augsburger, husband and wife; Belle Conner; Charles Dete; The Farmers and Savings Bank, by D. C. House Cashier; L. F. Young and Mona Young, husband and wife; who acknowledged the signing of this plat to be their voluntary act and deed for the purposes hereon mentioned. Witness my hand this 29 day of May, 1936.

JUSTICE OF PEACE, HOLMES COUNTY, OHIO
APPROVED AND ACCEPTED BY ME
THIS 29 DAY OF MAY 1936

Karl Snyder
COUNTY ENGINEER
KARL SNYDER
SURVEYOR'S [SEAL]

OFFICE OF COUNTY COMMISSIONERS
HOLMES COUNTY, OHIO
This plat has been approved and accepted by us
this 29 day of May, 1936

J. A. Yoder
J. C. Deale
John Schopfer

BOARD OF COUNTY COMMISSIONERS

ATTEST - H. C. Gray
COUNTY AUDITOR
AUDITOR'S [SEAL]

RECORDING DATA
Recorded in Plat Book, Vol. 2 Page 4
of County Plat Records. Date July 20, 1936
Geneva D. Cressley
COUNTY RECORDER
RECORDER'S [SEAL]
fee #30.95