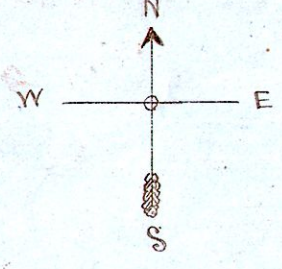
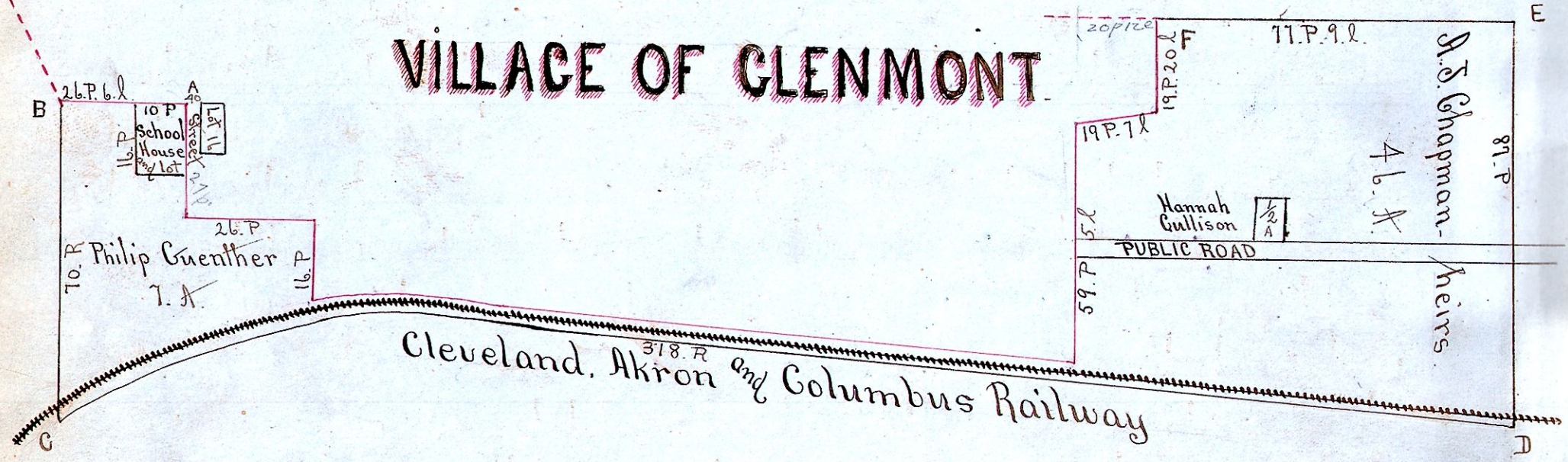

Exhibit "C"



VILLAGE OF GLENMONT



The red lines represent lines of the present corporate limits of the Village of Glenmont adjacent to land sought to be attached to the present corporate limits.

The above plat represents territory sought to be attached to the Village of Glenmont in Holmes county, Ohio.

The survey made was for the council of said village May 22, 1903.

A.H. Robinson,
county surveyor of Holmes county, O.