

Griffith Cowan's Land.

So of Sec. 3. T13. R. 13.

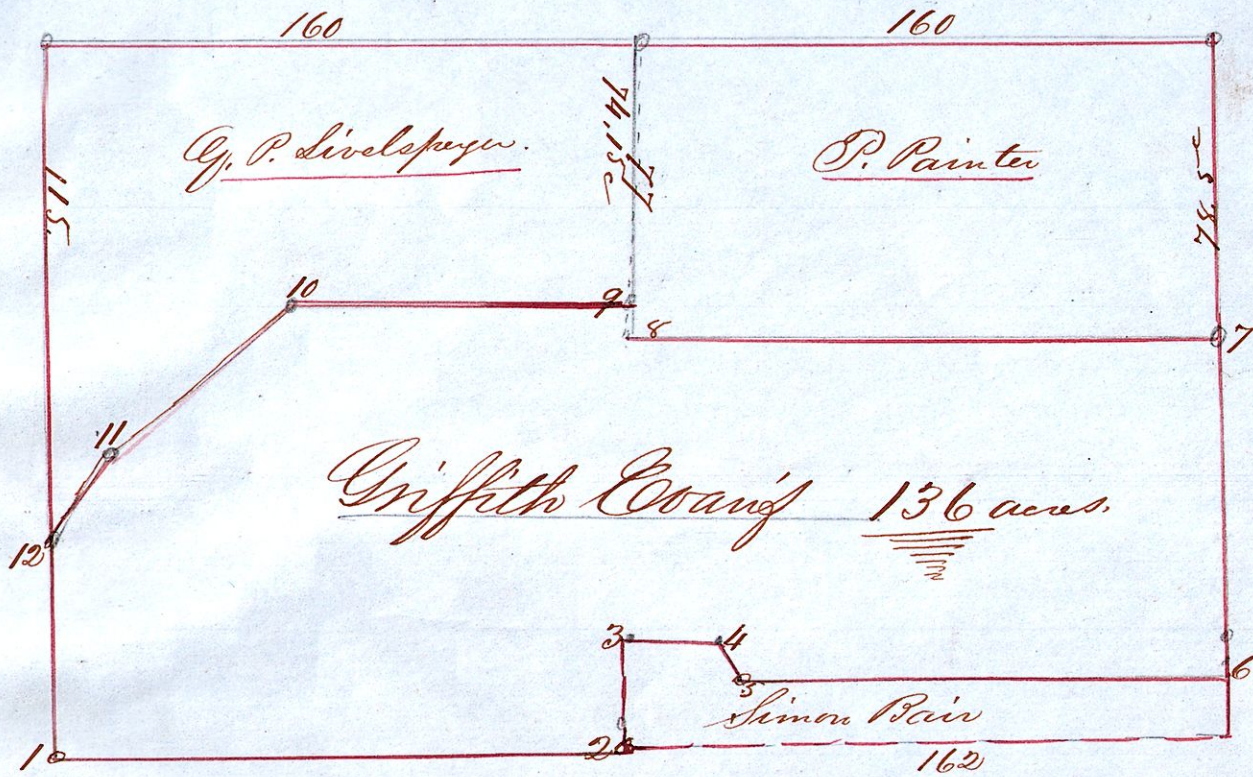

Containing 136. (acres more or less) Scale 80 perches to the inch.

1. N 89 1/4° E. 162 per. C to gr Post.
2. N 1° W. 33. 5 c
3. N 89 1/4° E. 30. 20 c
4. S 18° E. 14.
5. N 89 1/4° E. 127.
6. N 1 1/4° W. 61. 8 links
7. S 89 1/2° W. 161. 10
8. N 1° W. 2. 10
9. S 89 3/4° W. 97. 12
10. S 51° W. 56. 20
11. S 67° W. 19.
12. South 42. 12 to the place of beginning.

I do hereby certify that the above is a correct plat of the South half of Sec. 3. T13. R. 13. January 29th. 1849.

S. Robinson. Surveyor.

Presented and Platted in this Office April 12th. A.D. 1851.

W. M. McKinley, Recorder.