

9. 8. 1. Napoleon, (Now Glenmont 1905)

Plat of the town of Napoleon, situated on the
W 1/2 of Sec. 1. in T. 8. R. 9.
Jesse Hughes Proprietor of lots on W 1/2 of S. W. q. r.
Asa Critchfield Proprietor of lots on E 1/2 of S. W. q. r.
Ephraim Darby " " W 1/2 of N. W. q. r.
Surveyed May 11th 1841.
60 feet in front & 120 feet back.

GLENMONT.

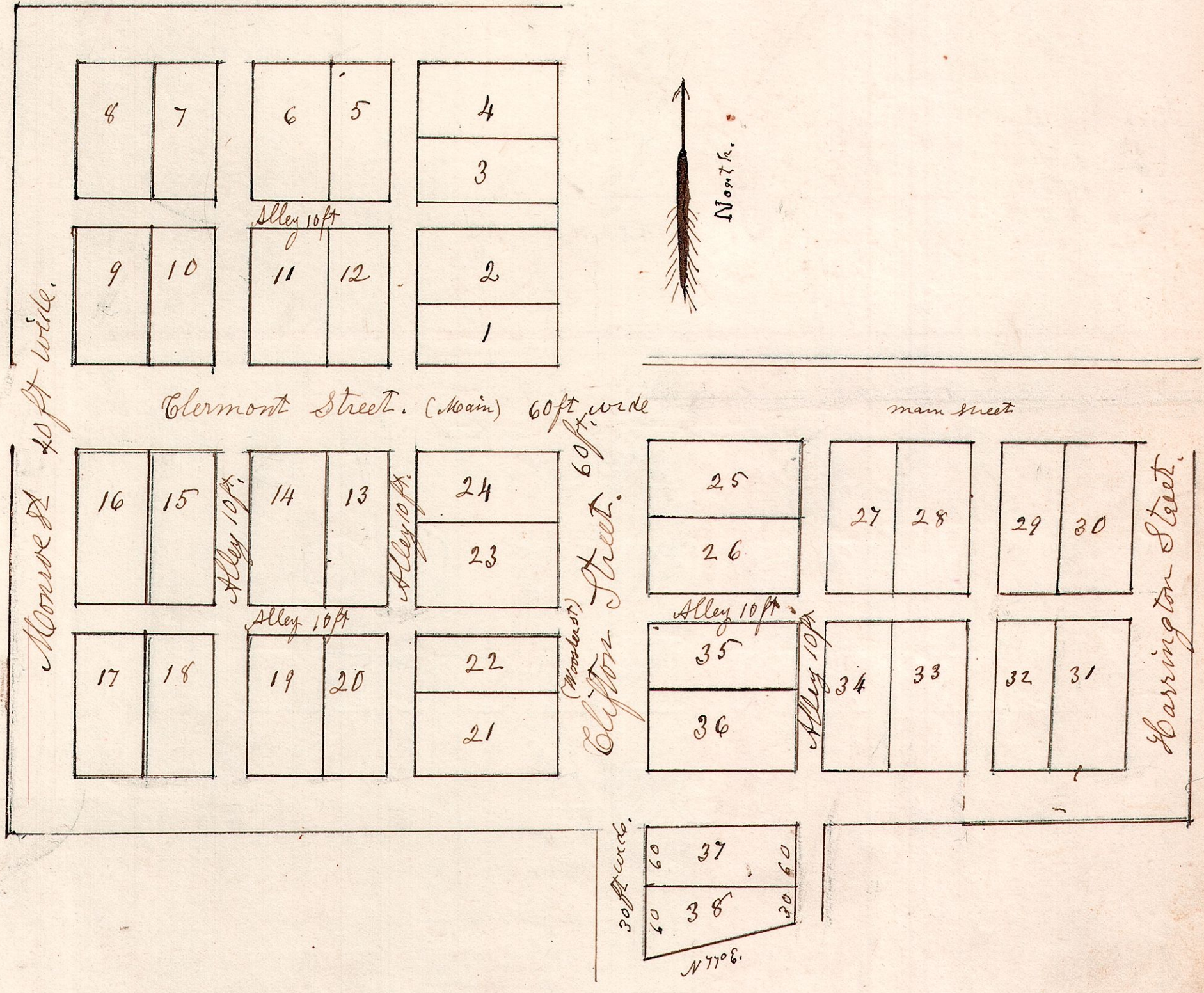

The above plat or plan of the town plat of Napoleon sets forth the number of the
lots, the courses, and width of the streets & alleys. Said town^{plat} is situated on the
west half of Section No one in T. 8. of R. No. 9. Holmes County Ohio.
Ephraim Darby Proprietor of lots No 1-2-3-4-5-6-7-8-9-10-11-12. situated on the S. E. part or
corner of the W 1/2 of the N. W. q. r. of Sec 1. aforesaid.
Jesse Hughes Proprietor of lots No. 13-14-15-16-17-18-19-20-21-22-23-24. situated on the
N. E. corner of of the W 1/2 of the S. W. q. r. of Sec 1 aforesaid.
Jesse Critchfield Proprietor of lots Nos. 25-26-27-28-29-30-31-32-33-34-35-36-37-38.
situated on the N. W. corner of the E 1/2 of the S. W. q. r. of Sec. 1. aforesaid.
A Stone ginses in diameter planted at the N. W. corner of inlot No 25. to make future
surveys from.