

5.8.3.

December 11th 1833, Surveyed Section 3 in T⁸. R⁵. in the following manner and for the following persons

Hickory 14 S 44 E 34.
Elm 9 N 5 W 22.

W. Oak 24 S 42 W 30.
Blue Birch 10 S 25 E 35.

W. Oak 24 East 6.
do 12 S 67 W 40.

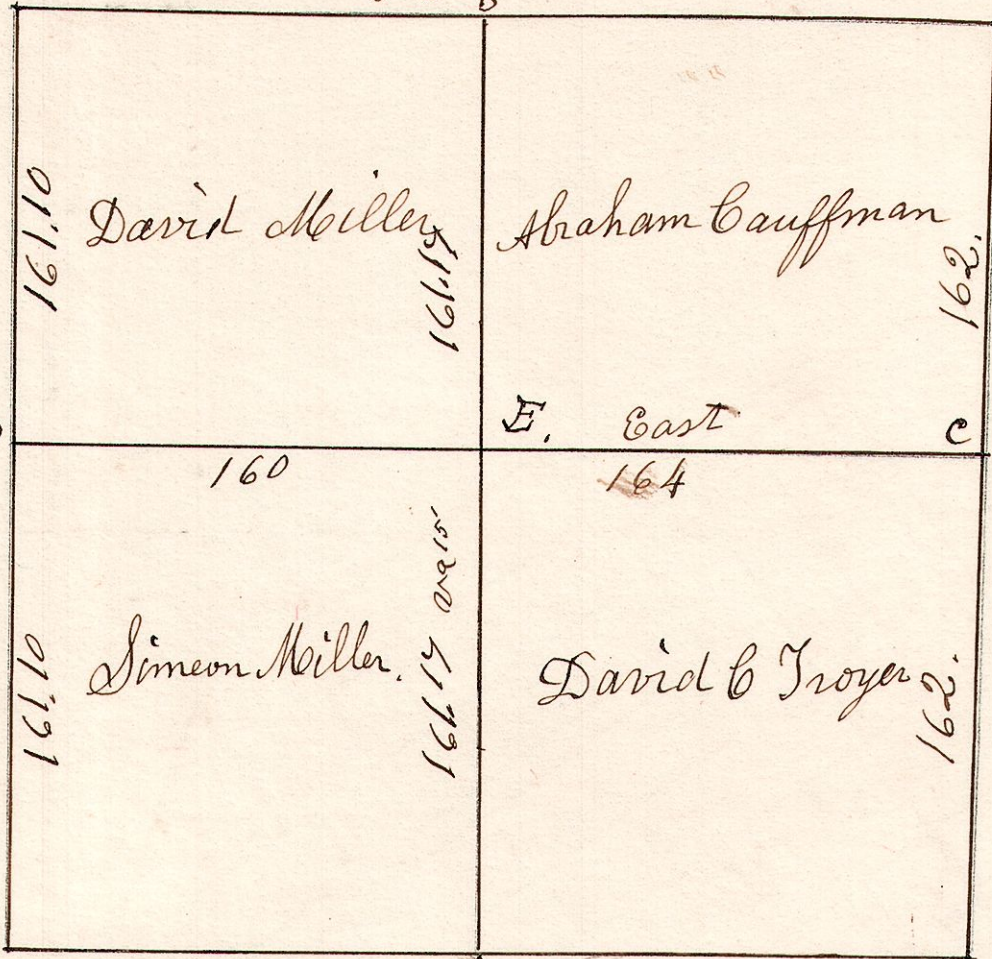

W. Oak 20 S 15 E 24.
do 15 N 50 W 43. D

E. Stone 20" the corner.

Hickory 5 S 18 E 10.
Chestnut 5 N 5 W 22.

W. Oak 18 N 21 1/2 W 26.
do 14 S 22 E 33.

W. Oak 12 S 21 E 29.
do 12 N 8 W 14.

5.8.22. April 10th 1833, Surveyed Section 22 in T⁸. R⁵. in the following manner and for the following persons.

W. Oak 24 N 21 E 61.
Hickory 18 S 26 W 44.

W. Oak 20 S 59 W 97.
do 18 N 7 1/2 E 27.

Decayed Stone 15" the corner.

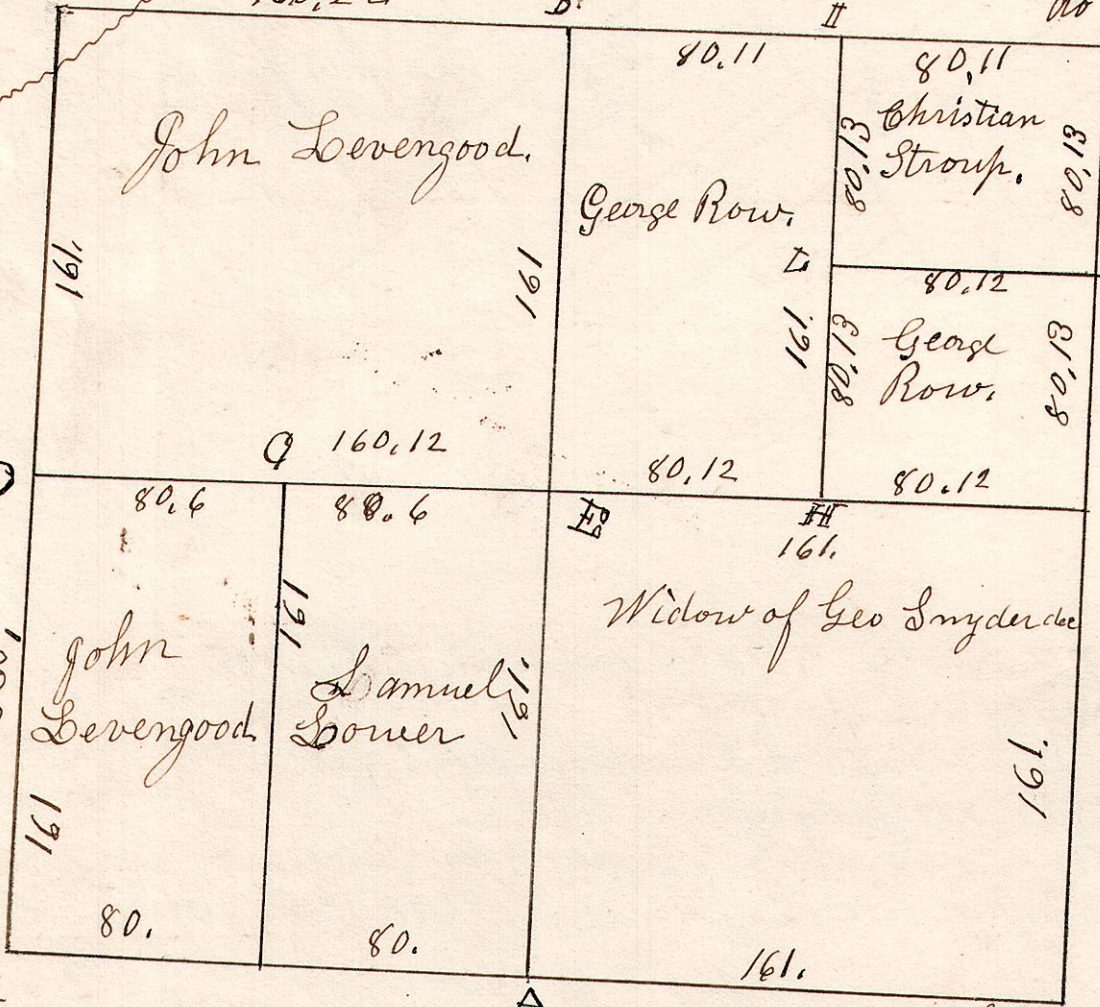

W. Oak 20 N 51 E 85.
do 18 S 32 E 40.

Decayed Stone 16" the corner.

W. Oak 12 N 47 E 33.
B. Oak 20 S 81 W 25.

W. Oak 12 N 47 E 33.
B. Oak 20 S 81 W 25.

E	B. Oak	10	N 71 W	3
"	W. Oak	6	S 30 W	7
F	W. Oak	20	S 39 W	13 1/2
"	do	22	N 32 E	13 1/2
Q	Stone	10"	the corner	
H				

I	W. Oak	18	N 74 E	20
"	do	15	S 34 W	30
L				
M	B. Oak	15	S 37 W	22
"	Hickory	6	N 10 W	17