

11.14.3.

Feb 18th 1830. Surveyed part of Fractional Section 3 in T 14. of Range 11. Situated in the N.W. Corner of said Fraction, adjoining Valentine Summers lot.

No 8.

Alter this on Duplicate from 70 acres to 58.

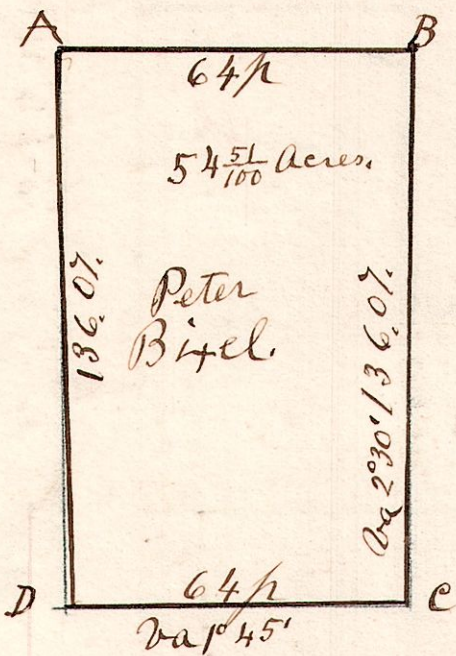

- A. Oak 9. S 2 E 5.
- " do 6. N 57 E 17.
- B. W. Oak 15. S 49 1/2 E 16 1/2
- " do 18. S 8 E 16 1/2
- C. W. Oak 24. N 79 E 21
- D. W. Oak 30. N 65 E 3

11.14.3.

Pt of Sec 3. T 14. R 11. Situated South of Valentine Summers lot.

No 9.

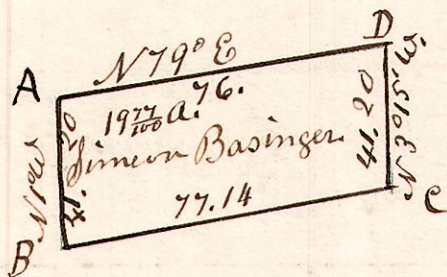

- A. W. Oak 20. S 64 W 19.
- B. B. Oak 18. S 79 W 16.
- C. Ash 16. N 54 E 12.
- D. W. Oak 15. N 89 E 12.

B	N 79 E	19.39	} 19 7/100 a.
C	N 3° 15 W	10.45	
D	S 79 W	19.00	
A	S 1° E	10.45	

11.14.1.

Sugar 10. S 11 E. 10.
W. Oak 15. N 3 E 19.

No 10.

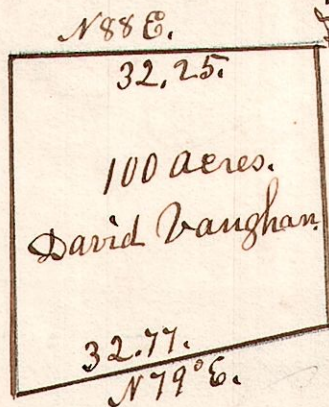

W. Oak 14. N 88 W 12.
" " 24. N 84 E 19.

Stone 10" the corner

Draft is made and delivered.

Surveyed the above Feb 12th 1834.
Being the west part of (fractional) Section No 1. T 14. R 11.
for David Vaughan.