

Lots No. 19 & 20 Section 1 Twp. 9 R

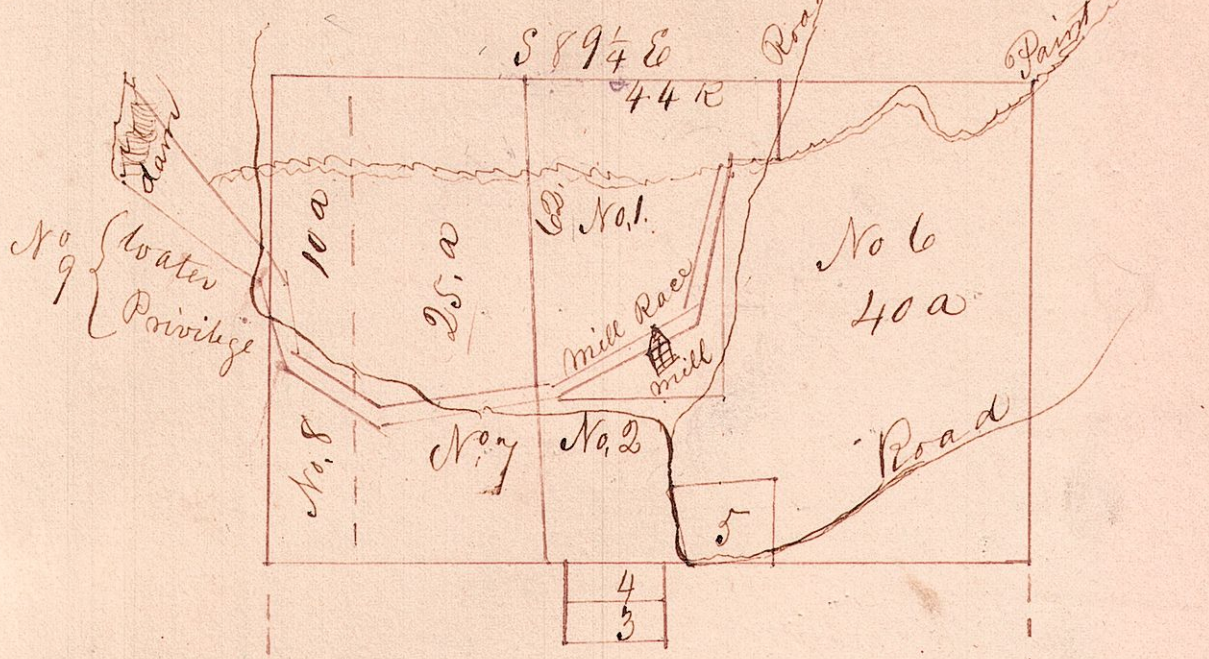

Elias Spences	Subdivisions No 1	containing	11 ¹³ / ₁₀₀ a
William H Philips	" No 2	"	6 a
William Davis	" No 3	"	1/2 a
Edward Smith	" No 4	"	1/2 a
Willow Coates	" No 5	"	1 a
James Moorhead	" No 6	"	40 a
Mary A Johnston	" No 7	"	25 a
M. A. Johnston widow	" No 8	"	10 a
Elias Spences	water privilege No 9	"	6 ⁸⁵ / ₁₀₀ a

This survey made on the 13th day of May for
 Auditor
 Joshua Sprongle County Surveyor