

Township 13 R 13 Sec 5 (Prairie)

Re-surveyed this April 25th 1882 and Established corners at D on S. E. corner
 a e + d run division line by and established at the ends there by
 variation about 35 minutes less of 2 is 152 about
 James C. Gilman
 Co Surveyor

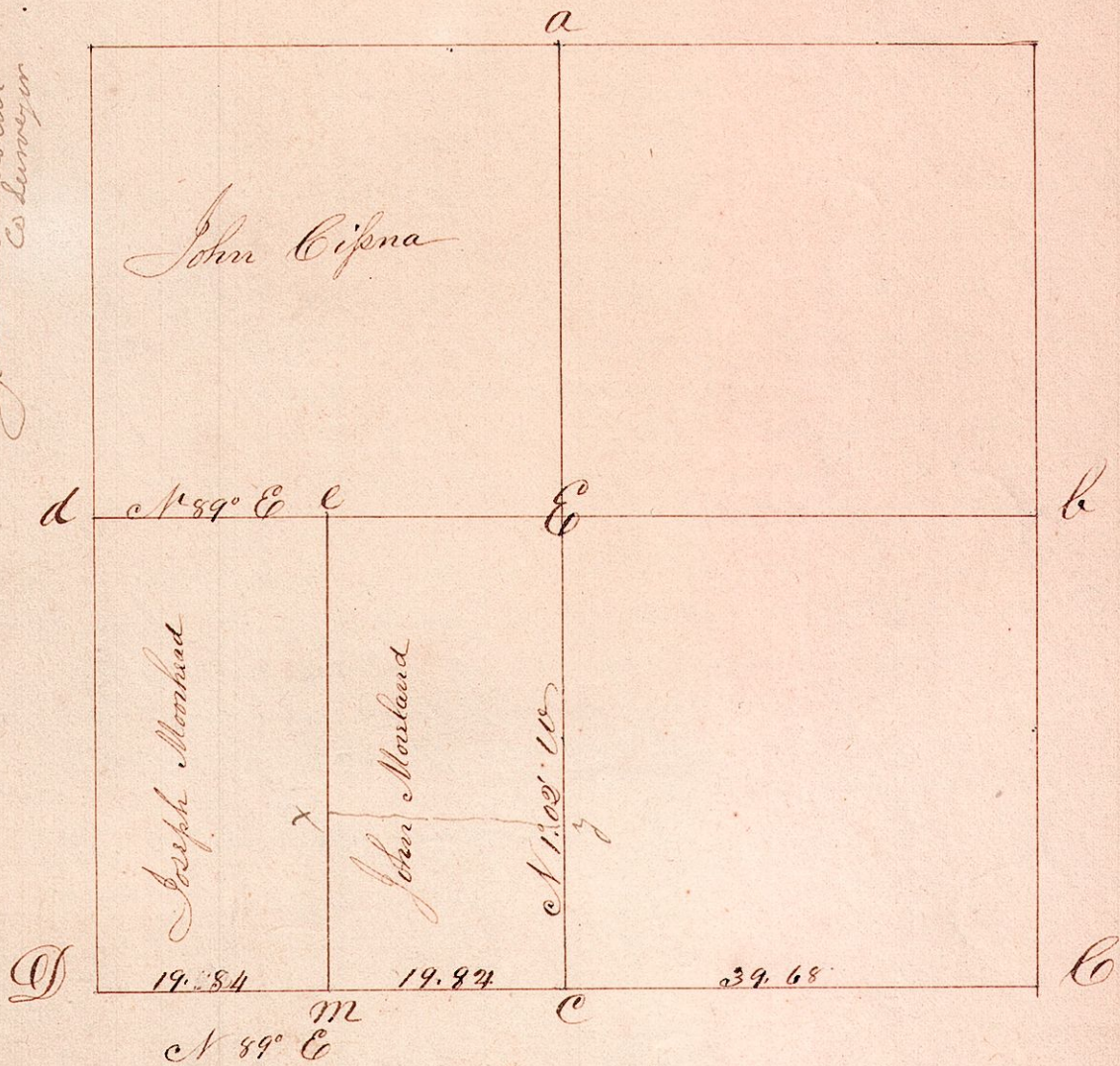

Field Notes & Remarks of the above Section

- a. Original good. W. Oak Standing S W. C 16 S 29 E W 40
- b. W. Oak 16 N 40 E 54 S Do 20 N 70 E 52
- c. Original. W. A standing but dead
- c. Hick 15 S 64 W 9 S W. Oak 12 N 10 E 22
- m. Maple 12 S 83 W 17 limbs
- d. Maple 16 S 72 E 11 S W. Oak 4 N 13 E 15
- d. W. Oak 18 S 17 E 21 S W. Oak 16 N 82 W 31
- e. Hickory 18 S 76 1/2 W 21
- E. W. Oak 36 S 76 1/2 W 33 S Maple 5 N 66 E 66

Remarks

The above section was surveyed Jan. 1848.
 The original witness trees at c, were not to be found
 the corner was placed equidistantly between the section corners

James Gilman

(N.B. on next page will be found testimony)