

Plat of Middletown Holmes County Ohio

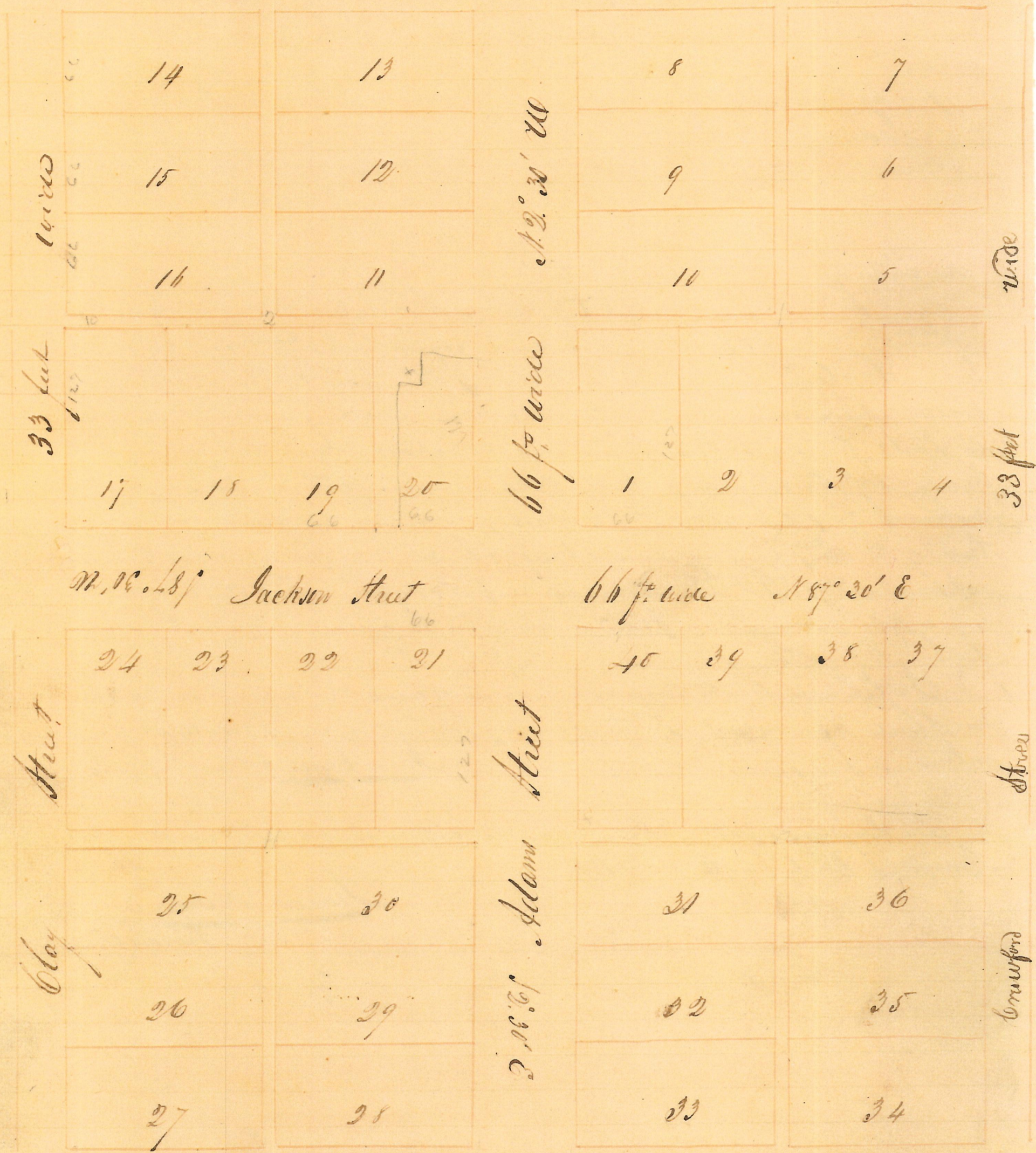

I hereby certify the above to be a correct plat of the town of Middletown
 Holmes County Ohio situated as follows (viz) Lots No. 1. 2. 3. 4. 5. 6. 7. 8. 9. and 10
 situated in the south east corner of section No. 1 (John McLean proprietor)
 Lots No. 11. 12. 13. 14. 15. 16. 17. 18. 19. and 20. Situated in the South East corner of section
 No. two (George Pauster Proprietor) Lots No. 21. 22. 23. 24. 25. 26. 27. 28. 29. and 30.
 in the north east corner of section No. eleven (Benjamin H. Gray proprietor)