

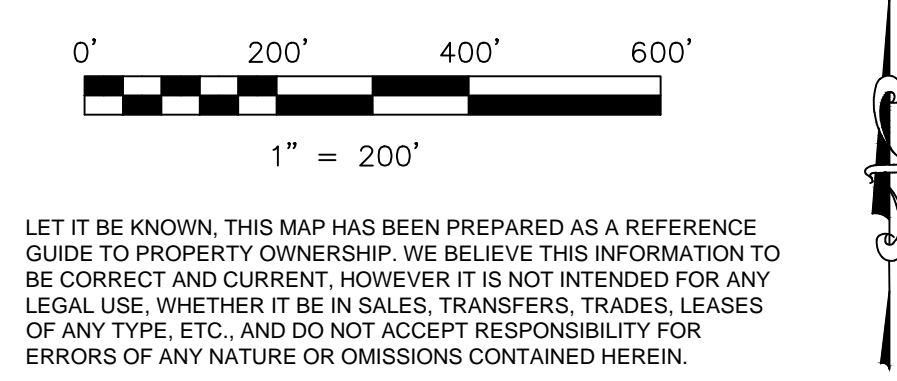

- 0100366000 Charlene L. Miller
133-256 10/10/1956
217-28 5/13/1982
OR.88-539 9/25/2001
OR.88-543 9/25/2001
0.46 ac
- 0000000000 not used
- 0000000000 not used
- 0100763000 Michael Yoder
OR.214-3062 11/17/2009
0.6085 ac p.8-80
- 0100762000 Michael W. Yoder
OR.214-3062 11/17/2009
1.000 ac p.7-570
- 0100055001 Charlene L. Miller
261-332 8/30/1993
OR.88-539 9/25/2001
OR.88-543 9/25/2001
0.201 ac p.14-289
- 0100710001 Troyer Equipment, Ltd.
OR.27-544 3/9/1999
1.134 ac p.16-253
- 0100054004 Wayne E. and Mary Miller 80%
James Elgin Miller, 20%
dba Wayne Miller Trucking
OR.29-173 4/7/1999
0.50 ac p.17-53
- 0100327000 J. Mark Menezes, Sr., trustee
Rozella Sue Menezes, trustee
OR.190-152 6/29/2006
1.3025 ac p.9-67
- 0000000000 not used
- 0100054002 James Elgin and Doris L. Miller
268-947 6/7/1995
OR.29-176 4/7/1999
1.5 ac p.14-827



LET IT BE KNOWN, THIS MAP HAS BEEN PREPARED AS A REFERENCE GUIDE TO PROPERTY OWNERSHIP. WE BELIEVE THIS INFORMATION TO BE CORRECT AND CURRENT, HOWEVER IT IS NOT INTENDED FOR ANY LEGAL USE, WHETHER IT BE IN SALES, TRANSFERS, TRADES, LEASES OF ANY TYPE, ETC., AND DO NOT ACCEPT RESPONSIBILITY FOR ERRORS OF ANY NATURE OR OMISSIONS CONTAINED HEREIN.

S.F.T. new survey required for next transfer

Last Revision: 7/19/2010

**T-9, R-6, 1st Qtr.
 Lots 3, 4, 8, 9
 Berlin Twp.
 Holmes County, Ohio**

B-10