

- 010036000 ① Charlene L. Miller  
133-256 10/10/1996  
217-26 5/13/1982  
DR88-539 9/25/2001  
DR88-543 9/25/2001  
0.46 ac
- 0100056000 ② Valve D. and Vera Boyd  
101-456 11/26/1948  
220-222 5/2/1983  
0.225 ac
- 0100056001 ③ Valve D. and Vera Boyd  
101-456 11/26/1948  
220-222 5/2/1983  
0.52 ac
- 0100763000 ④ Daniel and Sharon Workman  
214-632 9/23/1981  
0.6695 ac p.8-801
- 0100762000 ⑤ Daniel V. and Sharon E. Workman  
207-79 8/21/1979  
1.000 ac p.7-310
- 0100055001 ⑥ Charlene L. Miller  
261-322 8/23/1993  
DR88-539 9/25/2001  
DR88-543 9/25/2001  
0.201 ac p.14-289
- 0100710001 ⑦ Troyer Equipment, Ltd.  
DR27-544 3/9/1999  
1134 ac p.16-253
- 0100054004 ⑧ Wayne E. and Mary Miller, 80%  
James Elgin Miller, 20%  
dba Wayne Miller Trucking  
DR29-173 4/7/1999  
0.50 ac p.17-53
- 0100327000 ⑨ J. Mark Menez, Sr., trustee  
Rozella Sue Menez, trustee  
DR190-152 6/29/2006  
1.3025 ac p.9-67
- 0100055000 ⑩ Valve D. and Vera Boyd  
175-184 10/13/1970  
179-491 2/26/1972  
197-529 4/5/1977  
220-222 5/2/1983  
1.154 ac
- 0100054002 ⑪ James Elgin and Doris L. Miller  
268-947 6/7/1995  
DR29-173 4/7/1999  
1.5 ac p.14-827

Last Revision: 9/10/2007

**T-9, R-6, 1st Qtr.  
Lots 3, 4, 8, 9  
Berlin Twp.  
Holmes County, Ohio**

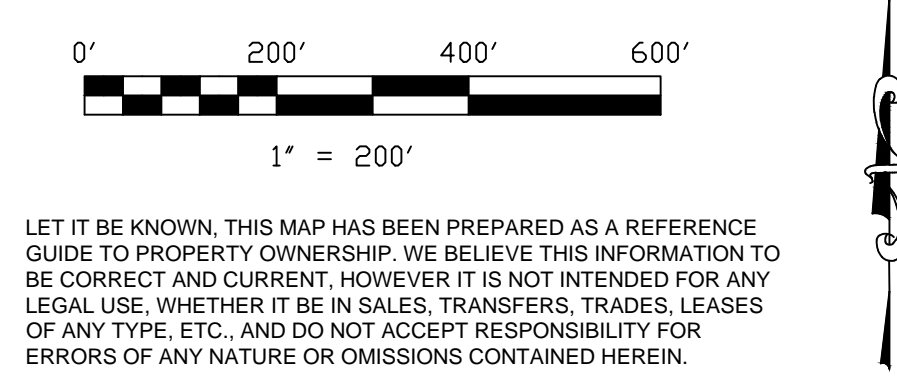

S.F.T. new survey  
required for next  
transfer

**B-10**