

- Asgard Subdivision, Second Addition  
Plat 19-1038 Platted 6/5/2007
- 0100201026 Jacob J. and Erma E. Beachy, co-trustees  
OR.199-2489 9/13/2007  
6.711 ac p.19-1038
- Heidelberg Manor Estates of Glead's Balm  
Plat 13-124 Platted 11/26/1990
- 0100247003 Donald Patrick Spirito  
258-457 1/4/1993  
1.861 ac p.13-124
- 0100247004 Timothy J. and Gina C. Miller  
OR.199-2221 7/28/2007  
1.815 ac p.13-124
- 0100247005 Barbara Sue Pritchard, trustee  
OR.198-2798 5/15/2006  
1.59 ac p.13-124
- 0100247006 Kathleen Torrence  
246-257 2/20/1990  
1.575 ac p.13-124
- 0100247007 Kathleen Torrence  
246-257 2/20/1990  
1.560 ac p.13-124
- Heidelberg Manor Estates No. 2 of Glead's Balm  
Plat 15-113 Platted 12/30/1996
- 0100247016 Kathleen Torrence  
268-47  
0.763 ac p.15-113
- Heidelberg Manor Estates No. 2 of Glead's Balm Replat  
Plat 19-1087 Platted 7/24/2007
- 0100247034 Ryan C. and Yvonne J. Torrence  
OR.27-92 3/1/1999  
OR.198-616 7/5/2007  
2.156 ac p.19-1087
- 0100247035 Doug and Tracy Cooper  
OR.198-3096 8/9/2007  
3.007 ac p.19-1087
- Jerry Anderson Allotment No. 1  
Plat 15-125 Platted 4/17/1997
- 0100201011 Dennis R. and Kimberly S. Anderson  
277-979 4/24/1997  
1.222 ac p.15-125
- Paul Hochstetler Allotment No. 1  
Plat 15-23 Platted 1/27/1994
- 0100201005 Jerry R. and Jerri L. Anderson  
OR.199-2221 7/28/2007  
1.6093 ac p.15-23
- Paul H. Hochstetler Allotment No. 2  
Plat 17-419 Platted 3/26/1998
- 0100201012 Joseph R. Kauffman  
MOE Yoder  
OR.508  
0.508 ac p.16-679
- Paul Hochstetler Allotment No. 3  
Plat 17-419 Platted 3/9/2000
- 0100201014 Jeff L. and Dawn R. Yoder  
OR.50-434 4/13/2000  
1.864 ac p.17-419
- Pine Cove Subdivision  
Plat 2-351 Platted 8/6/2002
- 0100247004 John A. Thern  
Debra E. Shank-Thern  
OR.183-2508 10/16/2005  
2.553 ac p.2-351
- 0100247025 Janice M. Limbert, trustee  
OR.167-2500 10/30/2003  
2.226 ac p.2-351
- 0100247026 David Anthony and Julie Ann Kaufman  
OR.128-788 11/15/2002  
3.000 ac p.2-351
- 0100247027 Ruth F. Schlaabach  
OR.158-458 7/28/2003  
1.600 ac p.2-351
- 0100247028 Stephen R. Schlaabach  
OR.97-489 12/27/2001  
OR.97-502 12/27/2001  
1.119 ac p.2-351
- 0100247029 Stephen R. Schlaabach  
OR.97-489 12/27/2001  
OR.97-502 12/27/2001  
1.031 ac p.2-351
- 0100247030 Stephen R. Schlaabach  
OR.97-489 12/27/2001  
OR.97-502 12/27/2001  
1.382 ac p.2-351
- 0100247031 Brian L. and Rena K. Mullet  
OR.121-65 8/22/2002  
2.250 ac p.2-351
- Safe Seven Subdivision  
Plat 17-469 Platted 4/25/2000
- 0100247020 Anderson Safe Properties, Ltd.  
OR.100-371 1/18/2002  
2.500 ac p.17-469
- Victoria Estates II  
Plat 17-217 Platted 8/26/1999
- 0100247010 Michael W. and Rebecca R. Conn  
251-599 6/6/1991  
OR.44-308 12/22/1999  
OR.44-308 12/22/1999  
OR.171-1113 4/8/2004  
2.139 ac p.17-217
- 0100247009 Wilford D. Conn  
250-691 3/20/1991  
258-444 1/4/1993  
OR.44-304 12/22/1999  
OR.44-312 12/22/1999  
5.888 ac p.17-217
- 0100247008 Sandra M. Conn  
OR.44-315 12/22/1999  
1.574 ac p.17-217
- 0100247001 Thomas C. and Dawn L. Lee  
OR.44-310 12/22/1999  
2.499 ac p.17-217
- Victoria Estates II First Addition  
Plat 19-403 Platted 5/25/2005
- 0100247032 Carol M. Conn  
OR.182-3141 8/29/2005  
OR.192-2902 11/3/2006  
2.000 ac p.19-403
- 0100247018 Wilford D. Conn  
278-355 5/23/1997  
3.000 ac p.19-403

- 0100492000 Gerald W. and Diane Stromme Mast  
236-916 10/30/1987  
OR.74-271 5/7/2001  
1.302 ac p.4-6
- 0100493000 Gerald W. and Diane Stromme Mast  
236-916 10/30/1987  
OR.74-271 5/7/2001  
0.431 ac p.4-6
- 0100494000 Kenneth N. and Deborah Ann Troyer  
254-13 1/2/1992  
OR.194-585 1/9/2007  
1.0 ac p.7-495
- 0100492001 Karen K. Hummel, trustee  
OR.8-413 5/6/1998  
0.3976 ac p.10-191
- 0100374000 Dan A. and Betty E. Miller  
201-282 3/14/1978  
OR.192-2257 10/27/2006  
0.25 ac
- 0100730000 Joseph W. and Sally Ann Yoder  
249-86 10/16/1990  
0.50 ac p.8-194
- 0100731001 Joseph W. and Sally Ann Yoder  
249-86 10/16/1990  
0.168 ac
- 0100731000 Joseph W. and Sally Ann Yoder  
249-86 10/16/1990  
0.012 ac
- 0100729000 Joseph W. and Sally Ann Yoder  
249-86 10/16/1990  
0.02984 ac p.5-28
- 0100712000 Samuel J. and Karen K. Troyer  
158-447 2/24/1986  
0.75 ac p.3-358
- 0100713000 Samuel J. and Karen K. Troyer  
173-490 4/27/1970  
0.25 ac p.5-35
- 0100799000 A. Allen Yoder, trustee  
OR.190-2028 7/25/2006  
1.08 ac p.10-191
- 0100236000 James L. and Jane D. Martin  
241-244 11/15/1988  
241-246 11/15/1988  
1.01 ac p.5-174
- 0100251000 W. Gerald and Peggy L. Miller  
159-438 6/23/1966  
254-971 3/26/1992  
0.4896 ac p.12-893
- 0100414000 PG Holdings, LLC  
OR.184-1021 1/16/2007  
0.4-10
- 0100094000 A. Louise Hershberger  
OR.181-1585 7/5/2005  
0.34 ac p.4-10
- 0100247002 Brenda L. Beachy  
OR.185-2348 12/23/2005  
1.0 ac p.12-195
- 0100493001 Kenneth N. and Deborah Ann Troyer  
254-13 1/2/1992  
OR.194-575 1/9/2007  
0.3492 ac p.12-928
- 0100201002 Carl E. and Mary E. Wiebe  
254-429 2/24/2000  
1.0 ac p.12-859
- 0100414001 W. Gerald and Peggy L. Miller  
254-973 3/26/1992  
0.3316 ac p.12-893
- 0100201003 Thomas C. and Angela D. Yoder  
OR.137-757 2/5/2003  
1.2316 ac p.16-70
- 0100201001 Karen K. Hummel, trustee  
OR.8-413 5/6/1998  
1.1947 ac p.12-857
- 0100201007 Gerald W. and Diane Stromme Mast  
274-538 7/30/1996  
OR.74-271 5/7/2001  
1.8284 ac p.16-171
- 0100201008 Kenneth N. and Deborah Ann Troyer  
254-429 2/24/2000  
1.478 ac p.16-171
- 0100201010 Carl E. and Mary E. Wiebe  
274-659 8/6/1996  
1.155 ac p.16-171
- 0100201009 Thomas C. and Angela D. Yoder  
OR.137-757 2/5/2003  
1.209 ac p.16-171
- 0100201013 Dennis R. and Kimberly S. Anderson  
OR.187-366 3/2/2006  
0.055 ac p.17-399
- 0100201006 Jerry R. and Jerri L. Anderson  
OR.187-366 3/2/2006  
0.3316 ac p.16-70
- 0100785003 Michael D. and Karlene R. Sommers  
OR.163-305 9/4/2003  
0.277 ac p.17-43
- 0100201015 Dan A. and Betty E. Miller  
OR.201-282 3/14/1978  
OR.192-2257 10/27/2006  
0.265 ac p.17-699
- 0100228001 Forrest and Mary Ann Kandel  
OR.66-788 1/31/2001  
1.128 ac p.17-774
- 0100229002 James L. and Jane D. Martin  
OR.86-668 9/4/2001  
0.493 ac p.17-774
- 0100201025 Andrew H. Miller, trustee  
OR.199-2486 9/13/2007  
0.276 ac p.19-1038

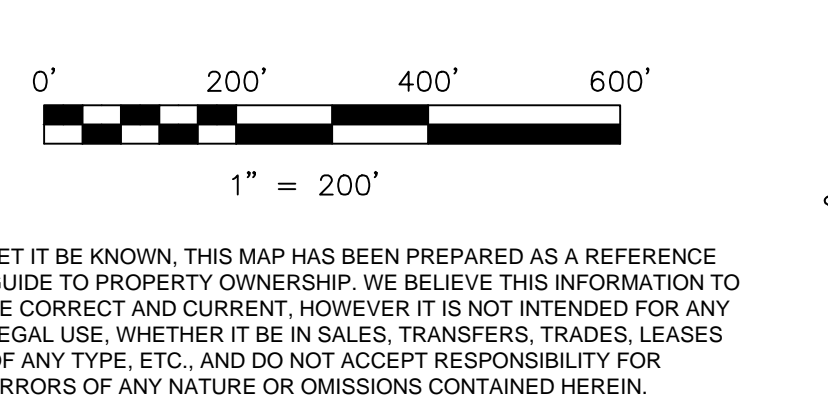

Last Revision: 9/13/2007

**T-9, R-6, 1st Qtr.**  
**Lots 13, 14, 18, 19**  
**Berlin Twp.**  
**Holmes County, Ohio**

**B-09**