

side ditch to be cut out back to sta. 5+70 and stone removed from road

18" culvert to be hauled and placed as directed by engineer

513.00 yds.

Note - Section 2. Begins at sta. 5+70 and extends to sta. 13. no stone shall be left in roadway nearer than 7' from surface

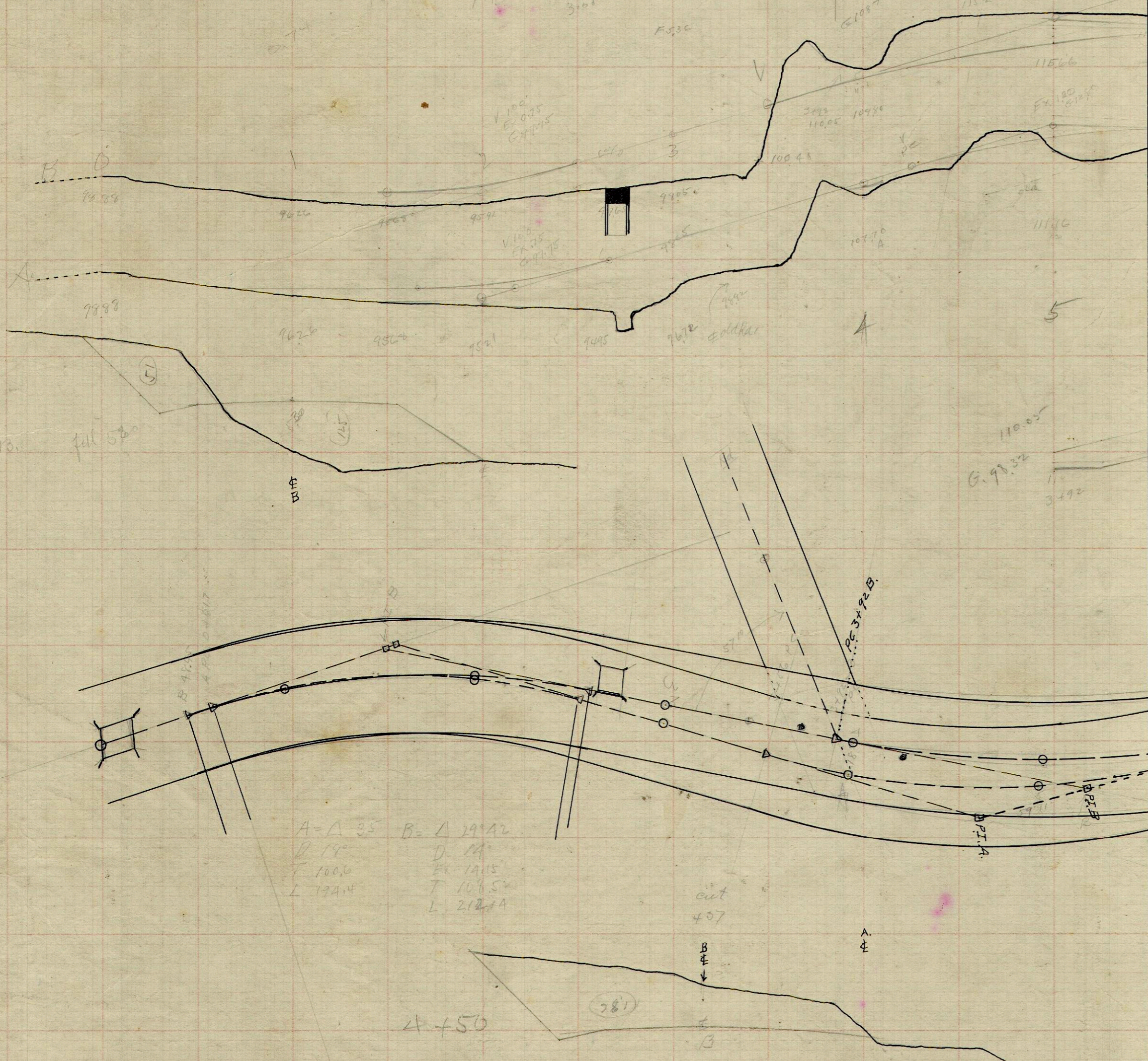

Approved:

\_\_\_\_\_  
 \_\_\_\_\_  
 \_\_\_\_\_

County Commissioners

PLAN FOR ROAD IMPROVEMENT  
 DEMAS MAST in BERLINTOWNSHIP  
 ROAD N<sup>o</sup> 76  
 April, 1918.  
 H.H. Palmer Co. Surveyors

473.