

HOLMES COUNTY
DEDICATION PLAT OF
WINESBURG-WALNUTCREEK ROAD
S.H.(I.C.H.) No. 725

NOTE
Reference is hereby made to extra widths acquired
on Parcels 2 4 6 9 10 by Holmes County Commissioners.
For further information see County Road Plans on file at
County Engineers Office.

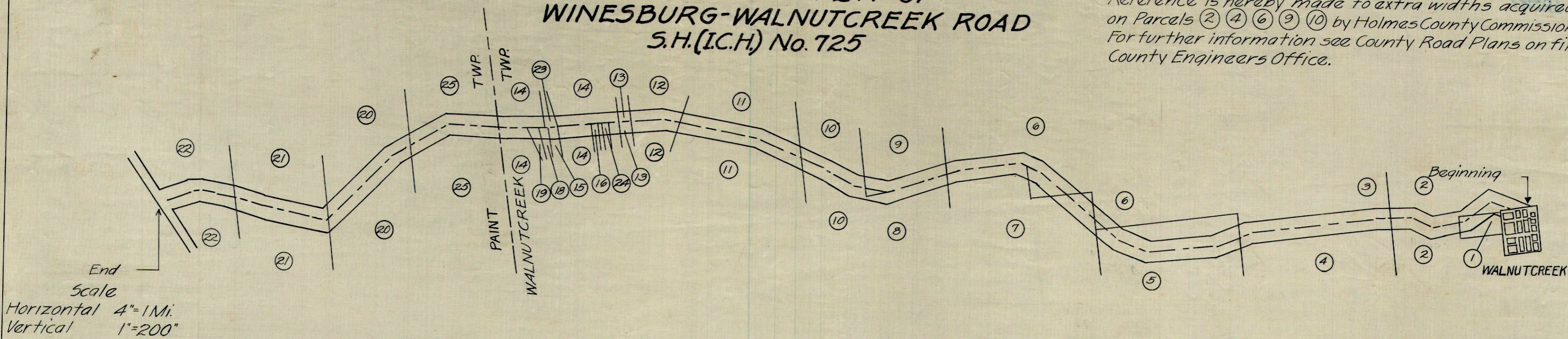

We, the undersigned owners of the above described property, dedicate the same to public use for road and other public purposes consistent therewith clear of all obstructions which interfere with the improvement and/or maintenance of the highway at the time of improvement.

Parcel Number	Owners	Witnesses	Parcel Number	Owners	Witnesses	Parcel Number	Owners	Witnesses
1	Alex. D. Hochstetler	L. Mast E. J. Frey	10	John de Hochstetler	L. Mast E. J. Frey	19	John M. Karrer	L. Mast E. J. Frey
2	Leo C. Hochstetler	L. Mast E. J. Frey	10	Martin Hochstetler	L. Mast E. J. Frey	19	Caroline (X) Karrer	L. Mast E. J. Frey
2	Rebecca J. Hochstetler	L. Mast E. J. Frey	11	Jacob J. Schlabach	L. Mast E. J. Frey	20	H. E. Hostettler	L. Mast E. J. Frey
3	Nathan Schrock	L. Mast E. J. Frey	11	Mary Schlabach	L. Mast E. J. Frey	20	Elva Hostettler	L. Mast E. J. Frey
3	Masa Schrock	L. Mast E. J. Frey	12	Mrs. Susan Voigt	L. Mast E. J. Frey	21	Fred (X) Hostettler	L. Mast E. J. Frey
4	Anna Miller	L. Mast E. J. Frey	13	Lloyd Troyer	L. Mast E. J. Frey	21	Lena Hostettler	L. Mast E. J. Frey
5	John C. Miller	L. Mast E. J. Frey	13	Mrs. Lloyd Troyer	L. Mast E. J. Frey	22	Dora Hostettler	L. Mast E. J. Frey
5	Clara Miller	L. Mast E. J. Frey	14	Seth Miller	L. Mast E. J. Frey	23	Ed S. Miller	L. Mast E. J. Frey
6	Ammon Harshberger	L. Mast E. J. Frey	14	M. K. (X) Miller	L. Mast E. J. Frey	23	Elva Miller	L. Mast E. J. Frey
6	Licce Harshberger	L. Mast E. J. Frey	15	Mrs. Kate Weaver	L. Mast E. J. Frey	24	Russel Brand	L. Mast E. J. Frey
7	Eliza Schrock	L. Mast E. J. Frey	16	Yost Miller	L. Mast E. J. Frey	24	Artie Brand	L. Mast E. J. Frey
7	Lister Schrock Adm.	L. Mast E. J. Frey	16	Fern Miller	L. Mast E. J. Frey			
8	Neal J. Yoder	L. Mast E. J. Frey	17	Lee H. Miller	L. Mast E. J. Frey			
8	Mattie Yoder	L. Mast E. J. Frey	17	Della Miller	L. Mast E. J. Frey			
9	A. D. Hochstetler	L. Mast E. J. Frey	18	Trail Flour Mill	L. Mast E. J. Frey			
9	Malinda Hochstetler	L. Mast E. J. Frey		Ralph Britkover B. K.	L. Mast E. J. Frey			

County of Holmes
State of Ohio

On this day of May 1936, before me a Notary Public in and for said County and State personally appeared, Alex. D. Hochstetler; Leo C. Hochstetler and Rebecca J. Hochstetler, husband and wife; Nathan Schrock and Masa Schrock, husband and wife; Anna Miller; John C. Miller and Clara Miller, husband and wife; Ammon Harshberger and Licce Harshberger, husband and wife; Eliza Schrock and Lister Schrock Adm.; Neal J. Yoder and Mattie Yoder, husband and wife; A. D. Hochstetler and Malinda Hochstetler, husband and wife; John D. Hochstetler and Mattie Hochstetler, husband and wife; Jacob J. Schlabach and Mary Schlabach, husband and wife; Susan Voigt; Lloyd Troyer and Mrs. Lloyd Troyer, husband and wife; Seth Miller and M. K. Miller; Kate Weaver; Yost Miller and Fern Miller, husband and wife; Les. H. Miller and Della Miller, husband and wife; Fred Hostettler and Lena Hostettler, husband and wife; Dan Hostettler; and Caroline Karrer, husband and wife; H. E. Hostettler and Elva Hostettler, husband and wife; Russel Brand and Artie Brand, husband and wife; who acknowledged the signing of this plat to be their voluntary act and deed for the purposes hereon mentioned. Witness my hand
this 29 day of May, 1936.

E. J. Frey
JUSTICE OF PEACE, HOLMES COUNTY, OHIO

OFFICE OF COUNTY COMMISSIONERS
HOLMES COUNTY, OHIO

This plat has been approved and accepted by us
this 29 day of May 1936.

J. A. Yoder
J. B. Lisle
John Schaffer
BOARD OF COUNTY COMMISSIONERS

ATTEST H. E. Gray
COUNTY AUDITOR

APPROVED AND ACCEPTED BY ME THIS 29 DAY OF MAY 1936.

Karl Snyder
COUNTY ENGINEER

RECORDING DATA
Recorded in Plat Book Vol. 2 Page 5
Holmes County Plat Records, Date July 21, 1936
Geneva D. Crissey
COUNTY RECORDER