

HOL-39-(16.69-17.29)

**PROPOSED DESIGN CHANGE
APPROACH 5-A**

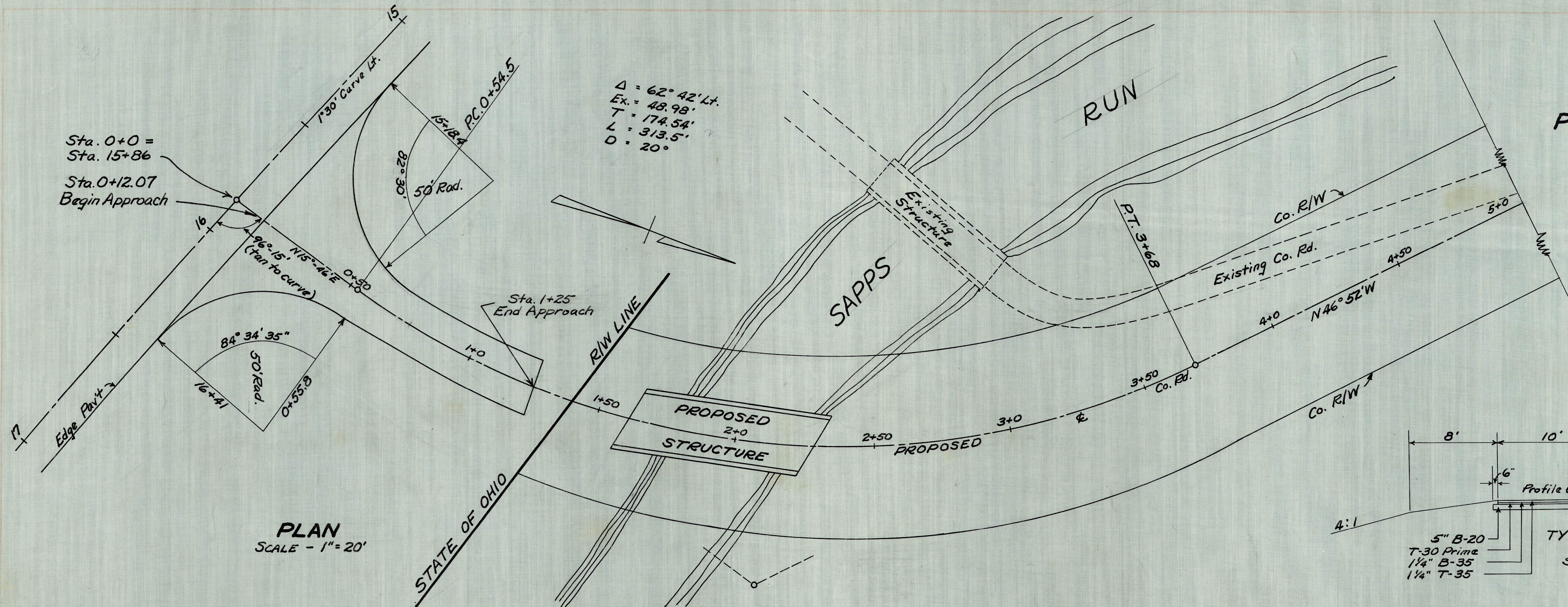

PLAN
SCALE - 1" = 20'

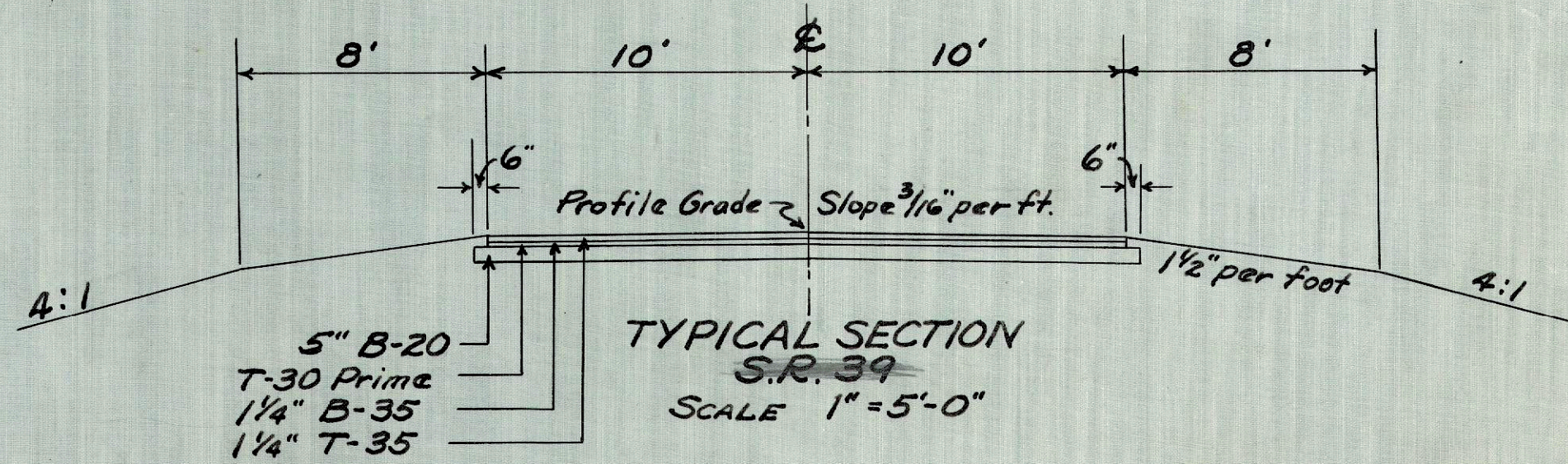
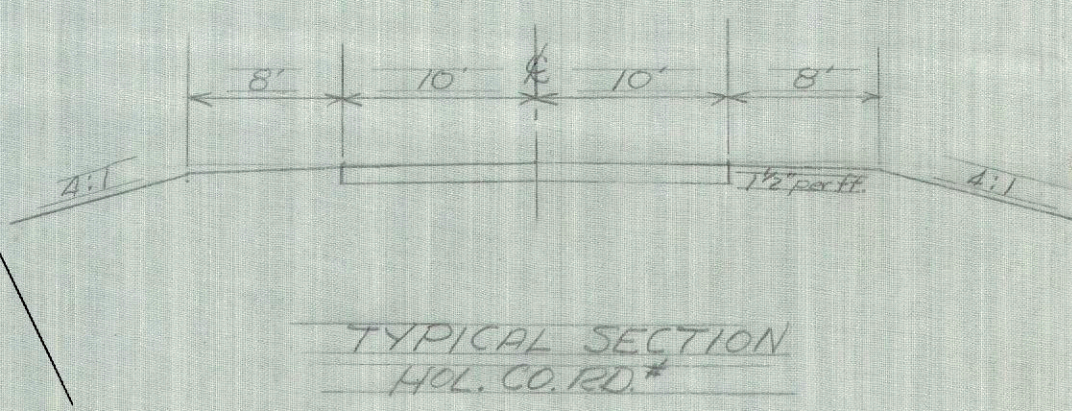

ESTIMATED QUANTITIES

- * Pavement Area 379 Sq. Yd.
- * 5" Waterbound Macadam Base Area 388 Sq. Yd.
- * Bituminous Prime Area 388 Sq. Yd.
- * Carried to pavement calculations (Sheet No. 5)

