

Auditor's Duplicate of Taxes assessed on Lands in Paint

Township, Holmes County, Ohio, for the Year 1861.

Main table with columns: TRANSFERS, OWNERS' NAMES, Description of..., Total Taxes of 1861, and Duplicates for DECEMBER and JUNE COLLECTION.

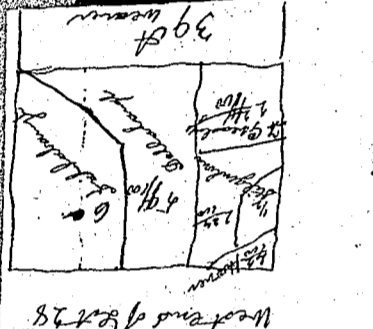

Handwritten notes providing details or corrections for specific land entries.

Auditor's Duplicate of Taxes assessed on Lands in Town

Township: Holmes County: Ohio, for the Year 1861.

Main table with columns: TRANSFERS, OWNERS' NAMES, Description of, Lot, Acres, Value, Total Taxes of 1861, and Duplicates of December and June Collections.

Note there is too much land changed in this tract by cause the 5/8 a acre in the name of ...

Auditor's Duplicate of Taxes assessed on Land in Grant

Township: Holmes County, Ohio, for the Year 1861.

Main table with columns: TRANSFERS, OWNERS' NAMES, Description of, Lot, Acres, Value, Total Taxes of 1861, and Duplicates of December and June Collections.

33 How long since each balance to the upper part of any of 54713.

Lehman Herman N. pt No. 332 4229307
Mayport Valentine 6 pt No. 172 4229140

Auditor's Duplicate of Taxes assessed on Land in Paint

Township Holmes County, Ohio, for the Year 1861.

Table with columns: TRANSFERS, OWNERS' NAMES, Description of, Lot, Acres, Value, Total Taxes of 1861, and Delinquencies of 1860, DOLLARS, CENTS, MILLS. Includes sub-sections for DUPLICATE OF DECEMBER COLLECTION and DUPLICATE OF JUNE COLLECTION.

