

The Basis of Bearing is Ohio State Plane
 Coordinates, North Zone, NAD 1983.

Iron pins set are 30" x 3/4" steel rod with
 plastic cap stamped "DIVERSIFIED
 ENGINEERING".

Situated in the Township of Berlin, County of
 Holmes and State of Ohio, being part of Lot 25
 in the Third Quarter in Township 9, Range 5 of
 the United States Military District.

Ingram Subdivision Replat No. 1
 Plat 19-4082 Lot 4

- R/W - Right-of-Way
- ℓ - Property Line
- ⊥ - Centerline
- POB - Place/Point of Beginning
- TPOB - True Place/Point of Beginning
- R&U - Record & Used
- C - Calculated
- M - Measured
- R - Record
- N.L.D. - New Line of Division
- - Iron Pin Set
- ▲ - Mag Nail Set
- - Iron Pin Found
- ⊙ - Iron Pipe Found
- △ - Monument Found as Noted
- - Stone Monument Found

Holmes Ingram Group, Ltd.
 O.R. Vol. 272, Pg. 3225
 PN: 01-00315.001

"Diversified
 Engineering" Iron
 Pin Fd & Used

Section 15
 Lot 25

N 89°01'58" W 1,555.36'
 Lot Line

POB
 RR Spike
 Fd & Used
 NE Corner
 Lot 25

Wayne W. Beachy Jr.
 & Martha Beachy
 Deed Vol. 250, Pg. 146
 PN: 01-00035.001

SSB Community Bank
 O.R. Vol. 275, Pg. 3792
 PN: 01-00035.011

SSB Community Bank
 O.R. Vol. 272, Pg. 3961
 PN: 01-00214.000

SSB Community Bank
 O.R. Vol. 272, Pg. 3961
 PN: 01-00036.011

Three Bee Company, Ltd.
 O.R. Vol. 214, Pg. 582
 PN: 01-00036.005

Three Bee Company, Ltd.
 O.R. Vol. 214, Pg. 582
 PN: 01-00215.000

Three Bee Company, Ltd.
 O.R. Vol. 214, Pg. 582
 PN: 01-00036.004

State Route 39

TPOB
 S 32°40'14" E
 217.21'
 5/8" Iron Pin
 Fd & Used

N 64°42'21" E
 (0.030 Acres)
 "To go to Adjoiner"
 133.22' N.L.D.
 (0.043 Acres)
 "To go to Adjoiner"
 0.073 Acres Total
 S 89°16'22" W 84.99'
 1/2" Iron Pipe
 Fd & Used
 S 56°45'38" W
 60.00'

Reference used:
 County Auditor's Tax Maps
 Deeds as noted hereon
 Surveys on File at the County Map Office

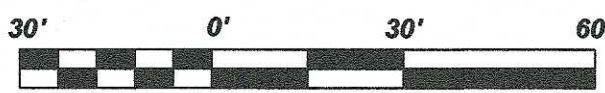

This is to certify that, at the request of the owner, I have
 surveyed and platted the parcel of land shown hereon in
 accordance with the provisions of Chapter 4733-37 of the
 Ohio Administrative Code. Monuments were found or set as
 indicated hereon. Dimensions are expressed in US Survey
 Feet and decimal parts thereof. All of which I certify to be
 correct to the best of my knowledge and belief.

APPROVED FOR TRANSFER ONLY
 NO SUBDIVISION PLAT REQUIRED
 (O.R.C. 711.001 & 711.131)
 Lot(s) not for building unless
 approved by Board of Health
 HOLMES CO. PLANNING COMMISSION
 By TS Date 5/7/2021

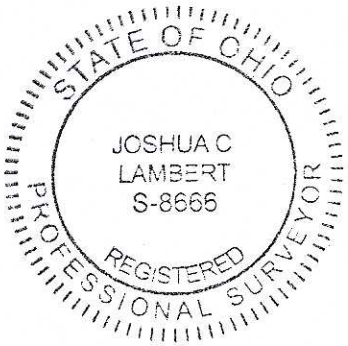

Joshua C. Lambert
 Joshua C. Lambert Date 3-19-21
 Registered Professional Surveyor No. S-8666
 State of Ohio

Plat Approved
 Holmes County Map Office
5/6/2021 Rg

ISSUE DATE	<u>3/19/21</u>	SCALE	<u>1" = 30'</u>
SURVEYED BY	<u>JGG/BSM</u>	DATE	<u>3/05/21</u>
DRAWN BY	<u>FDO</u>	DATE	<u>3/10/21</u>
CHECKED BY	<u>JCL</u>	DATE	<u>3/16/21</u>
FILE ID: <u>DEI-7211-0.073 CONVEY</u>			

Diversified Engineering Inc.
 CONSULTING ENGINEERS & SURVEYORS
 175 RAY AVENUE, N.E
 NEW PHILADELPHIA, OH 44663
 Phone: (330) 364-1631
 Fax: (330) 364-4031
 e-mail: dei@div-eng.com
 Web: www.div-eng.com

PLAT OF SURVEY
SSB Community Bank
 4599 State Route 39
 Millersburg, Ohio 44654

SHEET NO:
1 / 1

Z:\Users\jclambert\Documents\7211 SSB Bank (4599 S.R. 39)\Dwg\DEI-7211-0.073 CONVEY.dwg, 3/19/2021 1:59 PM