

PRAIRIE TOWNSHIP
 S.E. QTR. SECTION 29
 N.E. QTR. SECTION 32
 T-14 N; R-13 W
 HOLMES COUNTY, OHIO
 SURVEYED FOR: EMMA SUE MAST

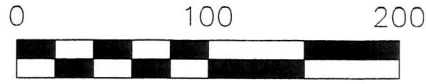

SCALE: 1"=100'

- ▲ R.R. SPIKE FOUND
- 5/8" REBAR FOUND UNLESS OTHERWISE NOTED
- 5/8" REBAR SET WITH I.D. CAP I.D. CAP MARKED "BAKER 6938"

201900004916

B: 19 P: 3895
 FILED FOR RECORD IN
 HOLMES COUNTY, OH
 ANITA HALL, COUNTY RECORDER
 10/25/2019 02:36 PM
 SMALL PLAT . 40.00
 PAGES: 1

ORV 269 page 57559



ABE A. MAST, TRUSTEE
 O.R. 227-943

APPROVED FOR TRANSFER ONLY
 NO SUBDIVISION PLAT REQUIRED

(O.R.C. 711.001 & 711.131)
 Lot(s) not for building unless
 approved by Board of Health.



HOLMES CO. PLANNING COMMISSION

By *[Signature]* Date *10/22/19*

REFERENCES

- DEED VOL. 228 PAGE 938
- O.R. VOL. 240 PAGE 1330
- O.R. VOL. 54 PAGE 190
- O.R. VOL. 227 PAGE 943

BEARINGS FROM OHIO STATE PLANE
 COORDINATE SYSTEM, NORTH ZONE,
 N.A.D. 83



BAKER SURVEYING, LLC
 138 N. CLAY STREET
 MILLERSBURG, OHIO 44654
 PH. 330-674-4788
 FAX 330-674-6027
 EMAIL: bakersurveying@gmail.com

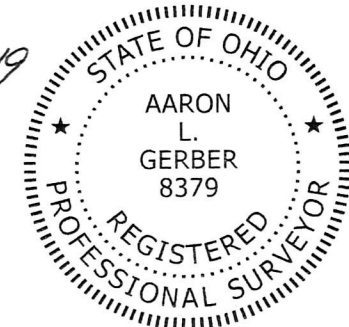

I CERTIFY THIS SURVEY TO BE CORRECT
 TO THE BEST OF MY KNOWLEDGE.

[Signature]
 AARON L. GERBER P.S. 8379
 DATE: OCTOBER 3, 2019
 ALG\CES
 FILE NAME: WORK5\S-544-19\AG-MD

PLAT APPROVED

10/22/2019 TD