

THE BELOW LICENSED PROFESSIONAL ENGINEER CERTIFIES THAT TO THE BEST OF HIS KNOWLEDGE AND BELIEF THIS PLAN GRAPHICALLY SHOWS ALL THE PARTICULARS OF THE BUILDINGS AS CONSTRUCTED.

Harry D. Matter
 HARRY D. MATTER, REGISTERED PROFESSIONAL ENGINEER E-040167 DATE 10/3/16

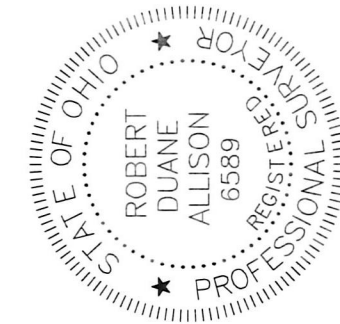

THE BELOW LICENSED PROFESSIONAL SURVEYOR CERTIFIES THAT TO THE BEST OF HIS KNOWLEDGE AND BELIEF THIS PLAN ACCURATELY REFLECTS THE LOCATION OF IMPROVEMENTS AND RECORDED EASEMENTS.

Robert D. Allison
 ROBERT D. ALLISON, REGISTERED PROFESSIONAL SURVEYOR 6589 DATE 10/3/2016

201600102092
 B: 19 P: 3086
 FILED FOR RECORD IN
 HOLMES COUNTY, OH
 ANITA HALL, COUNTY RECORDER
 10/26/2016 9:05 AM
 SMALL PLAT .40.00
 PAGES: 1
 ORV 258 PG 860

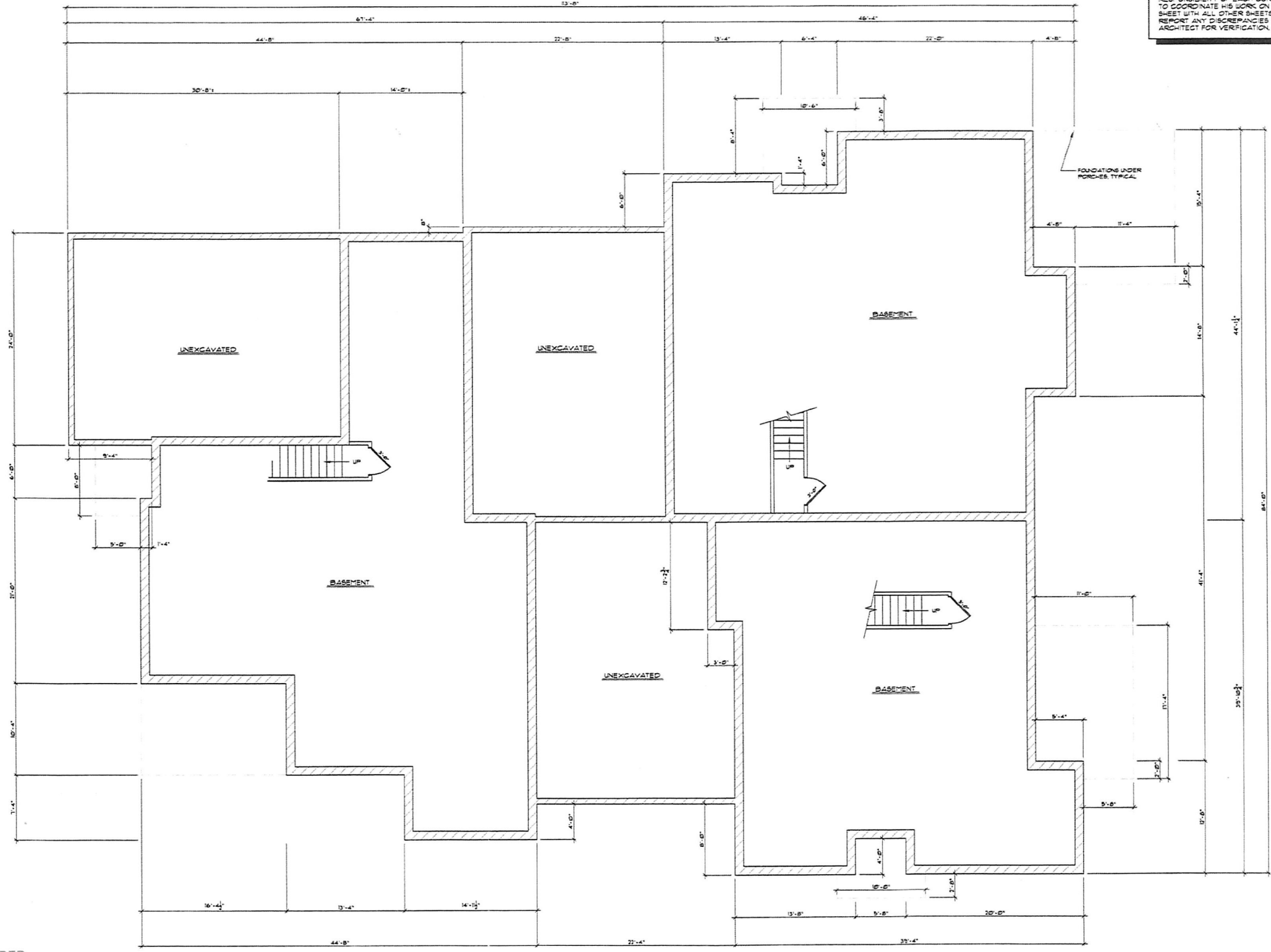

NOTE:
 DO NOT SCALE DRAWINGS. IT IS THE RESPONSIBILITY OF EACH CONTRACTOR TO COORDINATE HIS WORK ON THIS SHEET WITH ALL OTHER SHEETS AND REPORT ANY DISCREPANCIES TO ARCHITECT FOR VERIFICATION.

BASEMENT FLOOR PLAN
 SCALE: 3/16" = 1'-0"

BUILDING DATA

UNIT NO.	LIVING	BASEMENT	TOTAL	GARAGE
23	1456 S.F.	1292 S.F.	2748 S.F.	652 S.F.
24	1856 S.F.	1724 S.F.	3580 S.F.	712 S.F.
25	1773 S.F.	1642 S.F.	3415 S.F.	704 S.F.

BUILDING 11, UNITS 23, 24 AND 25

BA WIDDER
 Architectural Services
 Commercial, Industrial, & Residential Design
 427 4th Street NW, Suite B, New Philadelphia, Ohio 44663 Phone: (330) 338-4894 Fax: (330) 338-4719

PRELIMINARY
 NOT FOR
 CONSTRUCTION

Bravo A. Widder Lic #11190
 Expiration Date 12/31/17
 © COPYRIGHT 2016
 ALL RIGHTS RESERVED. ANY REPRODUCTION OR TRANSMISSION OF THIS DRAWING OR ANY PART THEREOF WITHOUT THE WRITTEN PERMISSION OF BA WIDDER ARCHITECTURAL SERVICES, LLC IS STRICTLY PROHIBITED.

New Building For:
The Cove at Walnut Creek
 Walnut Creek, Ohio 44087

JOB NO.
 16-1720
 Start Date
 2-23-16
 Plot Date
 5-7-16

