

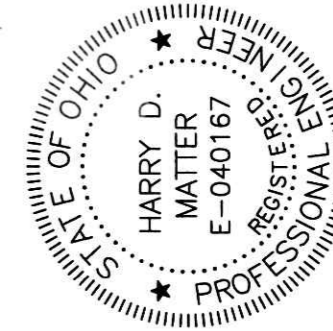

201400087625

B: 19 P: 2441
FILED FOR RECORD IN
HOLMES COUNTY, OH
ANITA HALL, COUNTY RECORDER
03/03/2014 2:42 PM
SMALL PLAT .40 00
PAGES: 1

ORV 248 Pg 332



THE BELOW LICENSED PROFESSIONAL ENGINEER CERTIFIES THAT TO THE BEST OF HIS KNOWLEDGE AND BELIEF THIS PLAN GRAPHICALLY SHOWS ALL THE PARTICULARS OF THE BUILDINGS AS CONSTRUCTED.

Harry D. Matter
HARRY D. MATTER, REGISTERED PROFESSIONAL ENGINEER E-040167 DATE 1/31/14

THE BELOW LICENSED PROFESSIONAL SURVEYOR CERTIFIES THAT TO THE BEST OF HIS KNOWLEDGE AND BELIEF THIS PLAN ACCURATELY REFLECTS THE LOCATION OF IMPROVEMENTS AND RECORDED EASEMENTS.

Robert D. Allison
ROBERT D. ALLISON, REGISTERED PROFESSIONAL SURVEYOR 6589 DATE 1/30/2014

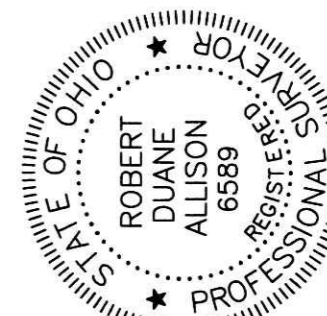
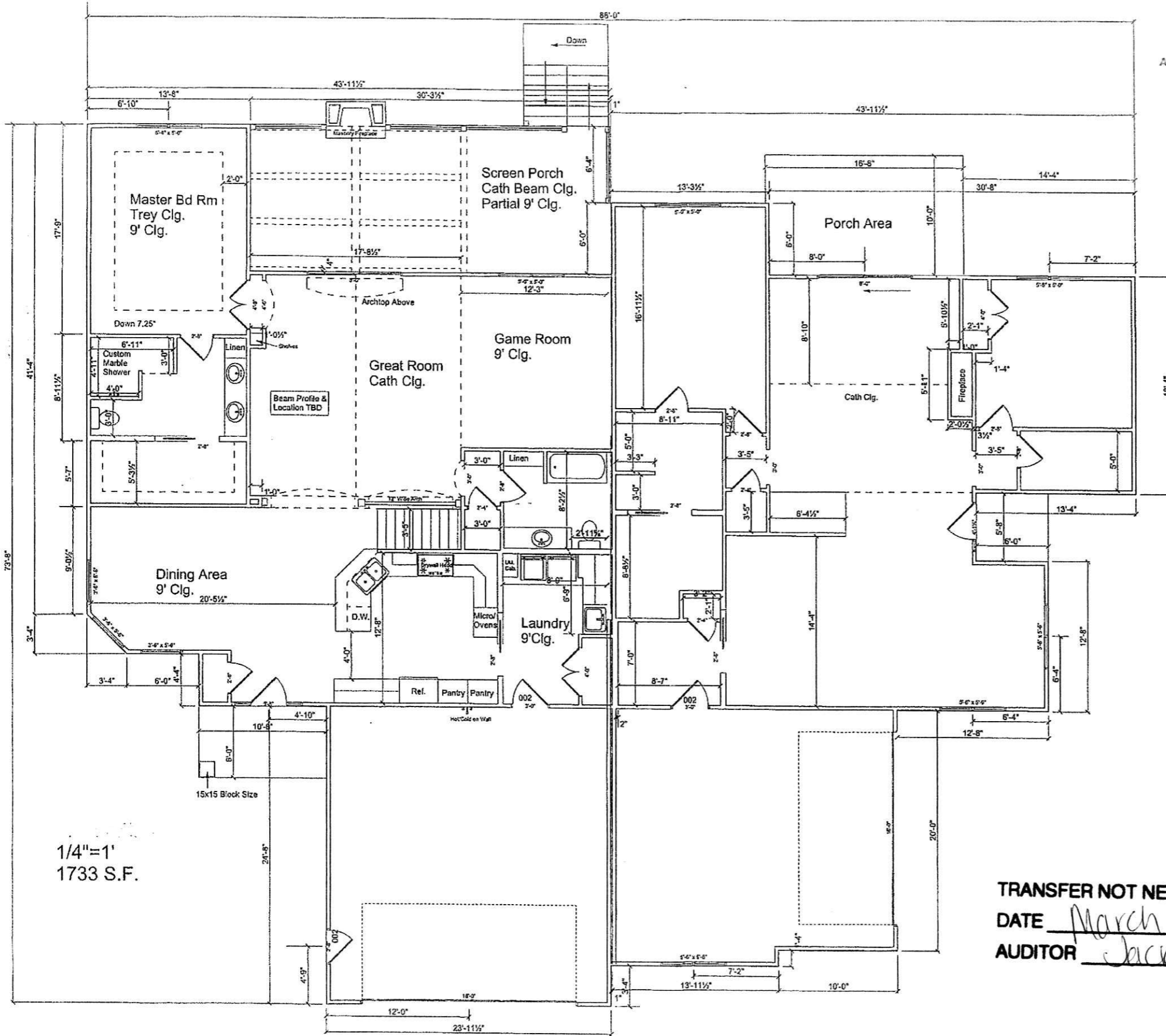

EXHIBIT B-2



KINGSTON PLAN

1" = 10'
LIVING - 1733 SQFT

BUILDING 2, UNIT 4

FIRST FLOOR

BERKSHIRE PLAN

1" = 10'
LIVING - 1460 SQFT

BUILDING 2, UNIT 3

TRANSFER NOT NECESSARY

DATE March 3 2014

AUDITOR Jackie McCreys

THE COVE AT WALNUT CREEK
MILLER-HOPE DEVELOPMENT
WALNUT CREEK, OHIO
44687

NOTES

DATE	5/16/13
1ST FLOOR	SQFT
2ND FLOOR	SQFT
LOWER LEVEL	SQFT
TOTAL	SQFT
GARAGE	SQFT
BONUS	SQFT
DESIGNER	
JOB NO.	

"THE CAMBRIDGE-REVISED"
MILLER-HOPE
WALNUT CREEK, OHIO
44687

SHEET NO.
2 OF 3