

I.P. FD. 0.34' SOUTH OF COR.
ON LINE

OUT LOT 33

S 87°00'00"E

S 87°00'00"E

129.58' MEAS. (130' REC.)

OUT LOT 33

OUT LOT 29

117.44' MEAS.

54.23'

97' REC.

OUT LOT 29

OUT LOT 30
33' REC.

U MONROE STREET

VILLAGE OF MILLERSBURG
PART OF OUT LOT 29
HOLMES COUNTY, OHIO

SURVEYED FOR: LARRY MIZER

8' EASEMENT TO BE RESERVED
FOR THE PURPOSE OF INGRESS
& EGRESS

8' EASEMENT TO BE GRANTED UNTO
THE GRANTEE FOR THE PURPOSE OF
INGRESS & EGRESS

RICHARD C. BRUNN, TRUSTEE
236-89

0.203 ACRES

OUT LOT 29

0 15 30 60
SCALE: 1" = 30'

● IRON PIN FOUND

REFERENCES:

DEED VOL. 180 PAGE 747

DEED VOL. 236 PAGE 89

BEARINGS ASSUMED

CENTERLINE OF A 16' EASEMENT

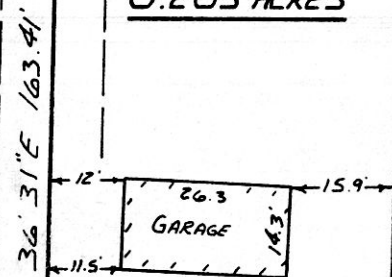

EILEEN MIZER
180-747



I CERTIFY THIS SURVEY TO BE CORRECT
TO THE BEST OF MY KNOWLEDGE.

Donald C. Baker

DONALD C. BAKER P.S. 6938

4321 TR 252
GLENMONT, OH

NOV. 29, 1988

LOT SPLIT APPROVED BY
MILLERSBURG VILLAGE

Rec. 12, 1988

Mary Ellen [Signature], clerk

EXISTING 8' STRIPS FOR AN ALLEY
SEE DEEDS

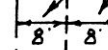

162705

FEB 06 1989

Rec'd. FEB 07 1989

AT 4:02 O'CLOCK PM

Holmes Co. Ohio Fee: \$5.00

Plat Vol. 12 Pg. 144 Recorder Richard Craven

Waltman

Deed Vol. 242 Page 199

VOL 12 PAGE 144