

(.3976 Ac.)

This plat not approved for any use that generates wastewater.

Lot 14, 1st Qtr., T. 9N., R. 6 W.
Berlin Twp., Hol. Co., Ohio
Roger Miller (Grantor)

mat Miller 7-27-87
Sanitarian Date

P.B. 7 Pg. 495
R.P. Spike Fd

SPLIT APPROVED # 870108

I. Pin Fd

153'

N 5° 14' 47" E

R.R. Spike set NB 2° 09' 00" E 264.03'

Vol. 171 Pg. 77

53° 01' 17" W

95.24'

C.R. 203
Vol. 168 Pg. 321

1980 Ac. 0.3976 Ac. Total .1996 Ac.

T.R. 353
38.10'

30.88' I. Pipe Fd. 229.98'

N 85° 21' 31" W

I. Pipe Fd

S.W. crnr Lot 14,
N.W. crnr Lot 19
1st Qtr., T 9N
R 6W, of Berlin
Twp., Hol. Co., Ohio
as per P.B. 9 Pg. 43

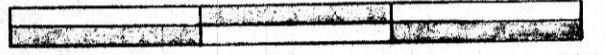

GRAPHIC SCALE IN FEET

NORTH

Known as part of Lot 14, 1st Qtr., T. 9N., R. 6 W.,
of Berlin Twp., Hol. Co., Ohio, and as part of Vol.
168 Pg. 321, and Vol. 171 Pg. 77.

Beginning at the S.W. crnr of Lot 14, as per
P.B. 9 Pg. 43;

thence with the West Line of Lot 14 and
T.R. 353 North 5° 14' 47" East 38.10' to a point in C.R.
203 from which a rail road spike set bears
South 82° 09' 00" West 4.44';

thence with C.R. 203 and leaving said West
Line North 82° 09' 00" East 264.03' to an iron pin
found;

thence leaving C.R. 203 South 3° 01' 17" West
95.24' to an iron pipe found on the South Line of
Lot 14;

thence with the South Line of Lot 14 North
85° 21' 31" West 260.86' to the point of beginning
and passing an iron pipe found on line at 229.98';
and containing 0.3976 acres, 0.1996 acres from
Vol. 171 Pg. 77, and 0.1980 acres from Vol. 168 Pg. 321,
buried on part to all legal highways.

Survey and description by Robert L. Kasner

156821

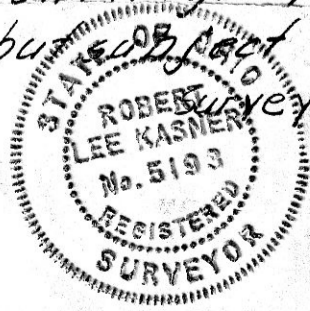

Rec'd. JUL 29 1987

AT 4:21 O'CLOCK P.M. P.S. 5193 P.E. 28820

Recorded JUL 30 1987

Holmes Co. Ohio Fee: \$5.00 7/15/87

Plat Vol. 10

Pg. 791 Recorder *Richard Weaver*

MAP OFFICE COPY