

LOCATION PLAN

S.H 527 SEC. E (P.T)

WEST LAFAYETTE — SHANESVILLE ROAD

1946

SCALE 1"=200'

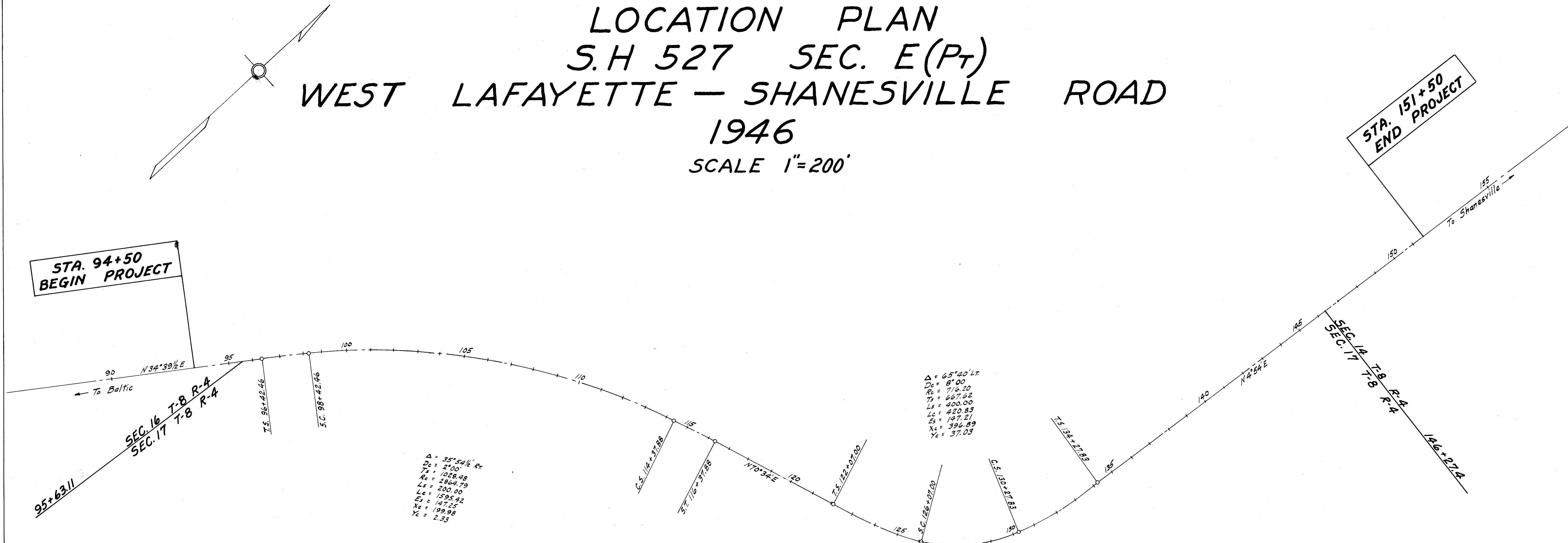

28255

RECEIVED FOR RECORD
 September 29th 1947.
 AT 2:30 O'CLOCK P.M.
 RECORDED Nov. 3, 1947 IN
 HOLMES COUNTY PLAT RECORDS
 VOLUME 2 PAGE 20
 Evelyn Anderson RECORDER
 FEE \$9.50

SECTION 14 TOWN 8 RANGE 4
 SECTION 16 TOWN 8 RANGE 4
 SECTION 17 TOWN 8 RANGE 4
 CLARK TOWNSHIP
 HOLMES COUNTY

I HEREBY CERTIFY THIS PLAT TO BE CORRECT
 SIGNED BY E. R. McCullough 9-26-47
 DIVISION ENGINEER

CENTER LINE REFERENCE MONUMENTS WILL BE SET BEFORE OR AFTER CONSTRUCTION

