

6. 9. 6 S 1/2.

Feb 19th 1846.

M	Maple	20	S 85 E	31
"	W. Oak	15	S 68 W	21
L	Maple	15	S 80 W	36
"	Do	12	S 35 E	20 1/2
D	W. Oak	16	N 12 W	22
"	Do	15	S 1 E	23
E	B. Oak	12	N 22 E	7 1/2
"	W. Oak	16	S 45 E	28
O				
P				
C	W. Oak	20	N 21 W	29
"	Do	24	S 9 W	13
G	Pronwood	6	S 88 E	19 1/2
"	Sugar	10	S 49 W	31.

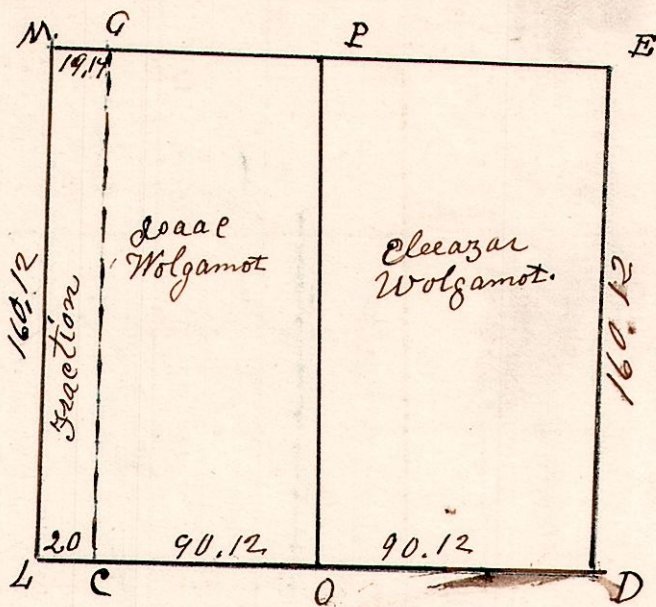

6. 9. 6. NW 1/4.

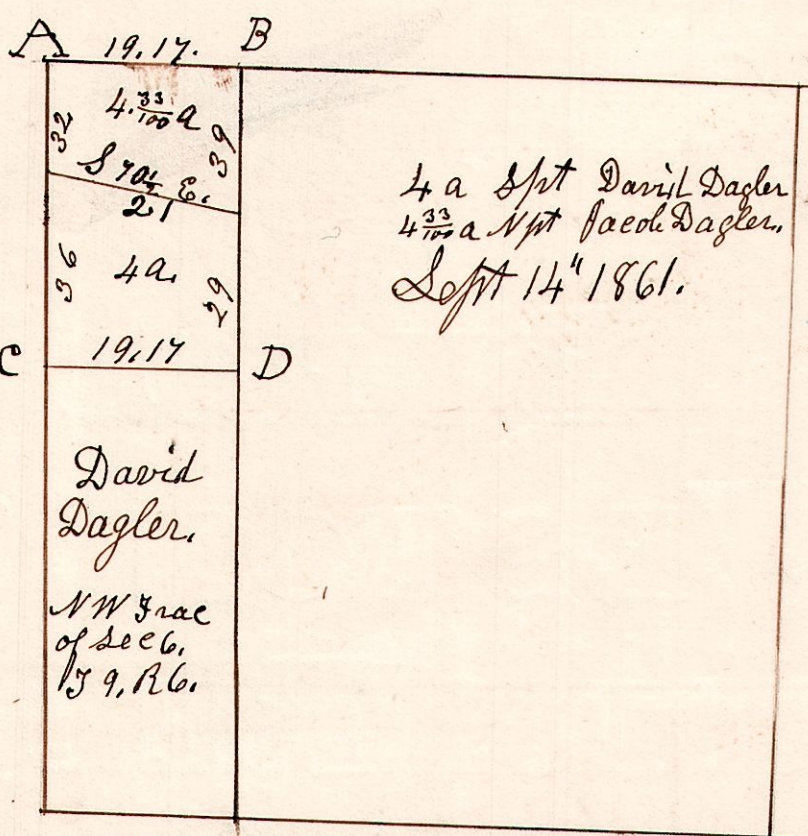

- A W. Oak 36 S 74 E 5.
- " Do 26 N 7 E 30.
- B W. Oak 30 N 37 E 17.
- " Hickory 12 S 26 W 32
- C Beech 24 S 48 1/2 W 6
- " Elm 19 N 41 3/4 W 5

School Land corner

6. 9. 25. E 1/2 of N 6 q.

E 1/2 of N 6 q. of
Sec 25. T 9. R 6.
Feb 22nd 1872
Whole Quantity 80 3/8 a.

