

6.8.20.

Section 6, Township 8 Range 6.
September 27th 1836.

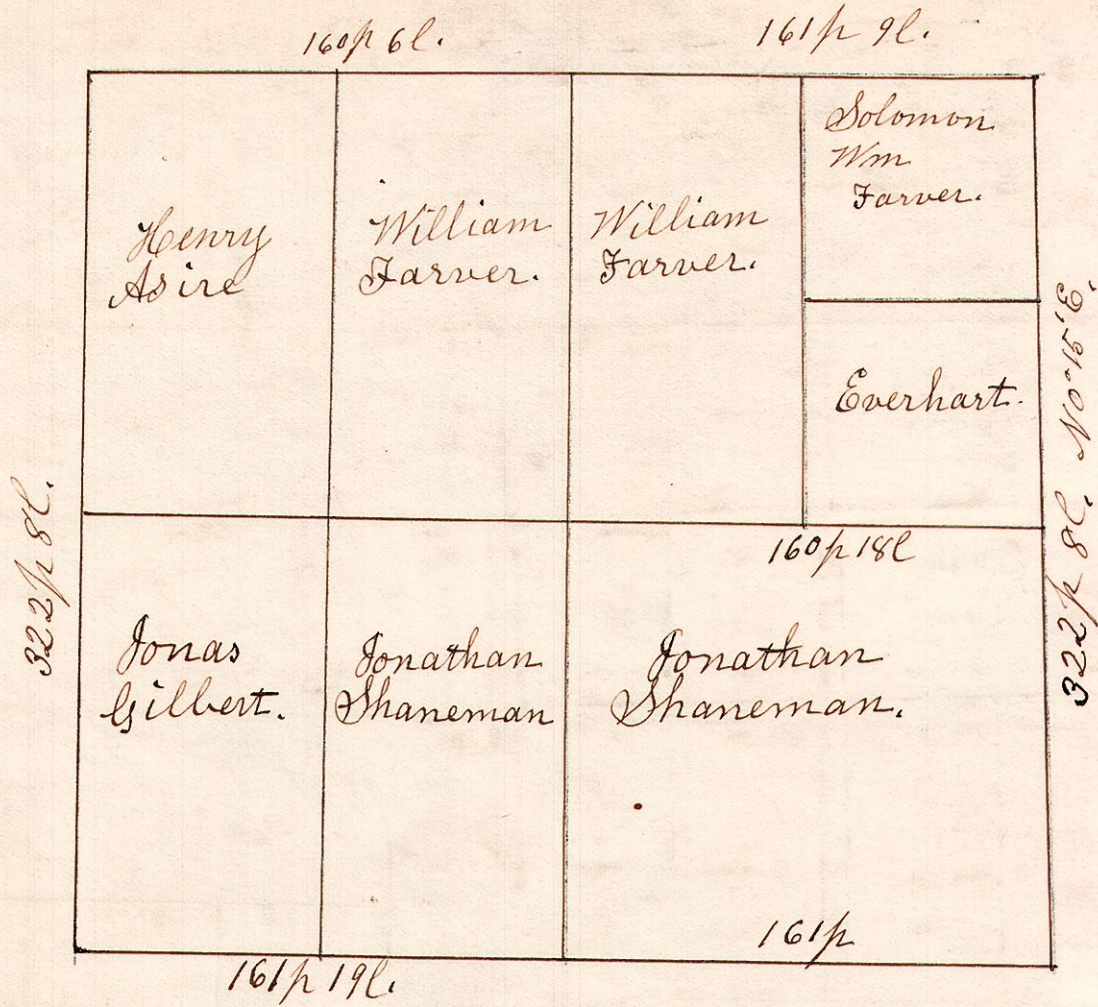

6.9.14. December 6th 1833. Surveyed Section 14. 59. R 6.
in the following manner & for the following persons.

W. Oak 16 N 12 W 22.
Do 15 S 1 E 23.

Hickory 12 S 40 W 17.
Sugar 9 S 43 E 6.

Sassafras 7 N 59 E 27.
Maple 24 S 67 W 55.

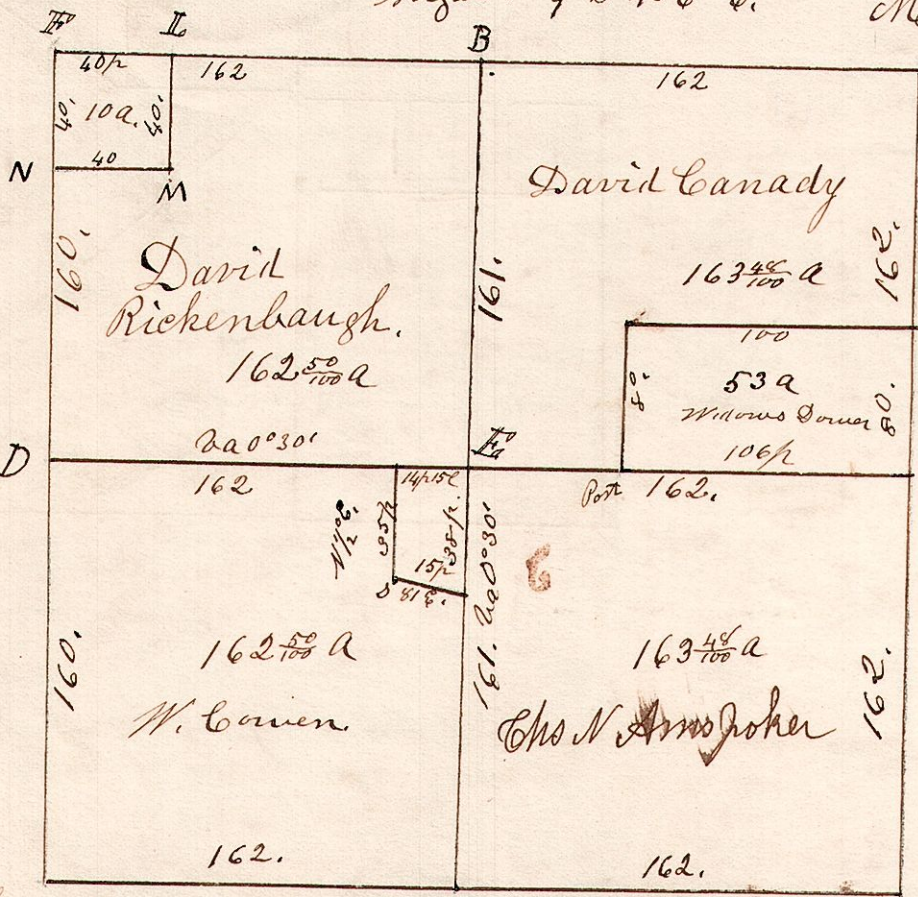

W oak 20 N 50 W 7.
Do 12 N 30 E 26. D

Red Oak 20 South 33.
Lynn - N 52 E 6. C

W. Oak 36 S 71 W 56.
Do 40 N 65 E 63.

Hickory 16 S 26 5/2.
Do 14 S 41 E 33.

Elm 12 S 57 E 22.
Chestnut 24 S 80 W 22.

- E. W. Oak 18 S 79 E 29.
- do 18 S 79 W 26.
- L. W. Oak 20 West 17.
- Beech 14 S 39 E 14.
- M. Post in field.
- N. W. Oak 15 S 6 E 31.
- Do Dogwood 5 S 82 E 19.

June 23rd 1851 Surveyed 30 acres for
Joseph Nevill - E part of NW 1/4 of Sec
14 T 9. R 6. 102 per N 8 S. 7th 29 per 16l. E. & W.

May 23rd 1860 Surveyed the NW 1/4 of NE 1/4
for Samuel McCluer 133 1/2 a.
Held out to survey of 1833.

The Survey was made March 18th 1841.
for Elijah James situated in the NW
corner of the NW 1/4 of Sec 14 59. R 6

N 1/2 E. on E & W side
E & W on N side & on S side N 89 1/4 W.