

7. 9.

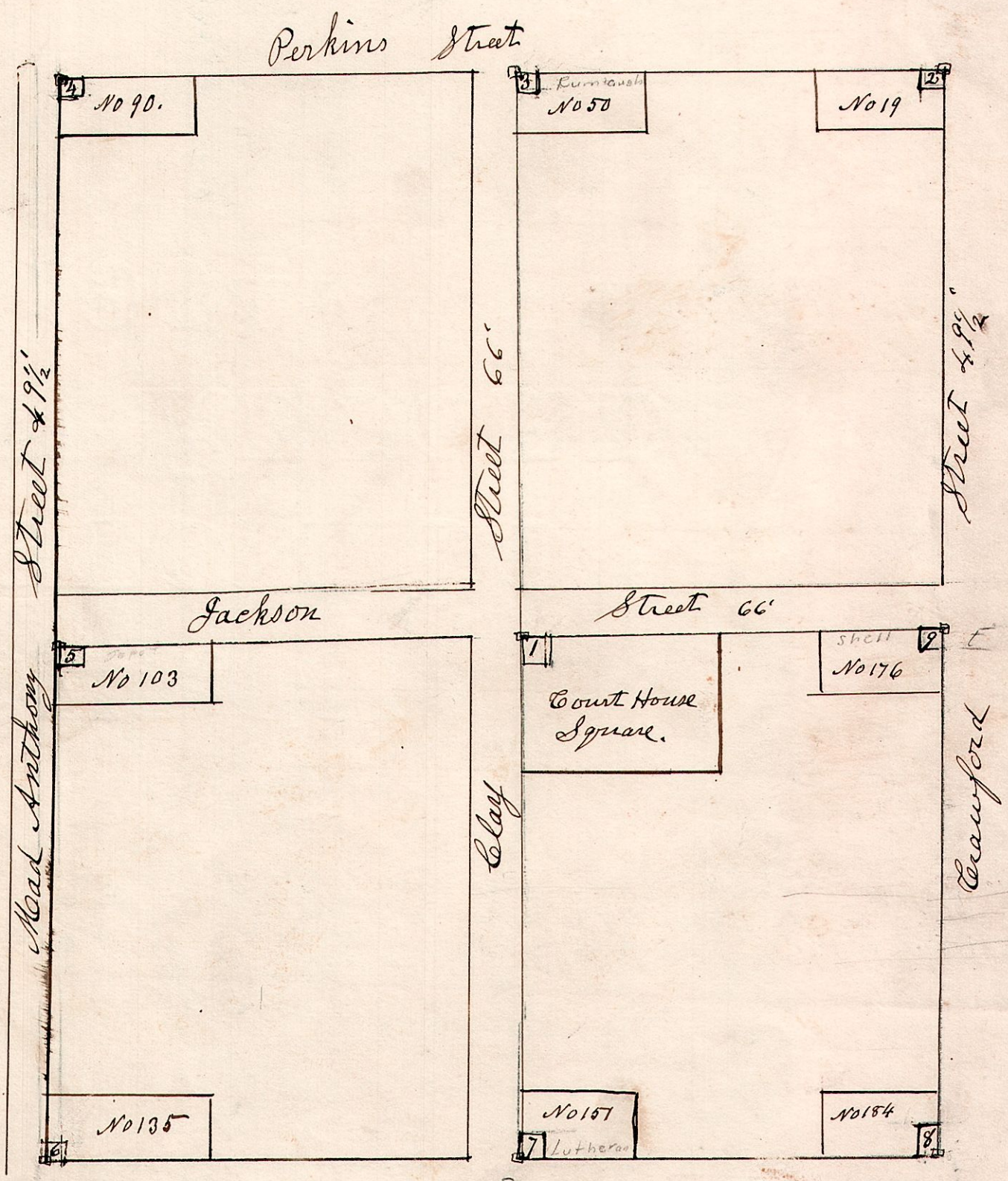

49-5
49-6
48-18
9
48-9

Standard corner stones, 8 inches in diameter on the top, with a cross cut on the top of each stone. Measurements to be had or made from center of cross: planted at the corner of the following lots of the original plat of the town of Millersburg, the County Seat of Holmes County Ohio

Count	House	Standard Starting Corner on N.W. corner of Public Square.
1		Standard Starting Corner on N.W. corner of Public Square.
2	17	Stone planted at N.E. corner of lot.
3	50	" " 7 inches west of N.W. corner of lot.
4	90	" " on N.W. corner of lot.
5	103	" " 9 inches west of N.W. corner of lot.
6	135	" " on S.W. corner of lot.
7	151	" " on S.W. corner of lot.
8	184	" " on S.E. corner of lot.
9	176	" " 9 inches East of N.E. corner of lot.

Established June 23rd 1873. by Samuel Robinson Surveyor.