

15. 19. 2. S 2. T 19. R 15.

Surveyed May 2^d 1833. by
S. Robinson Co. Surveyor.

311

November 23^d 1826,
surveyed all except
the 33⁵⁰/₁₀₀ a piece.

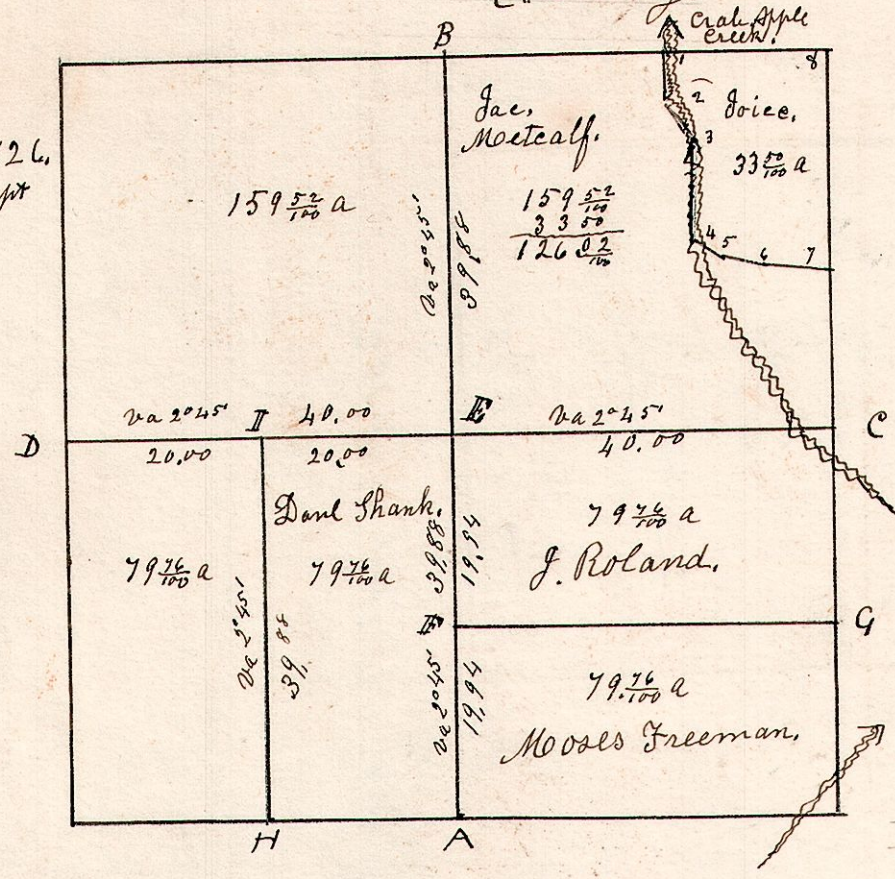

A	W. Oak	18	N 12 W	38	F	W. Oak	24	S 73 E	33
"	do	12	N 63 E	52	"	Dogwood	6	N 4 E	11
B	W. Oak	20	N 20 W	16	G	Stone	14	the corner.	
"	do	16	S 49 E	32	H	Hickory	12	S 12 E	48
C	Pine	10	S 17 W	14	"	do	10	S 82 W	21
D	B. Oak	5	S 80 E	35	I	W. Oak	10	S 22 E	63
"	do	4	N 1 E	67	"	B. Oak	8	N 38 W	44
E	W. Oak	40	N 52 W	30					
"	do	18	S 5 W	30					

8	S 88 W	16.83
1	S 46	5.75
2	S 38 1/2 E	4.75
3	South	10.50
4	S 59 E	3.00
5	S 78 E	3.50
6	S 85 E	8.40
7	N 2 1/2 W	23.47

Surveyed the above November 23^d 1826,
Bene Sec 2, T 19, R 15. of which
the above is a correct plat of the same.
Samuel Robinson Co. Surveyor.

15. 20. 29. June 2^d 1830. Surveyed Section No 29. in T 20.
of Range 15. in the following manner and for the
following persons.

312

B. Oak 10 S 34 E 25.
do 8 S 5 E 29.
Elm 30 S 10 W 34.
Hickory 4 N 34 E 16.
W Oak 24 N 72 W 55
do 22

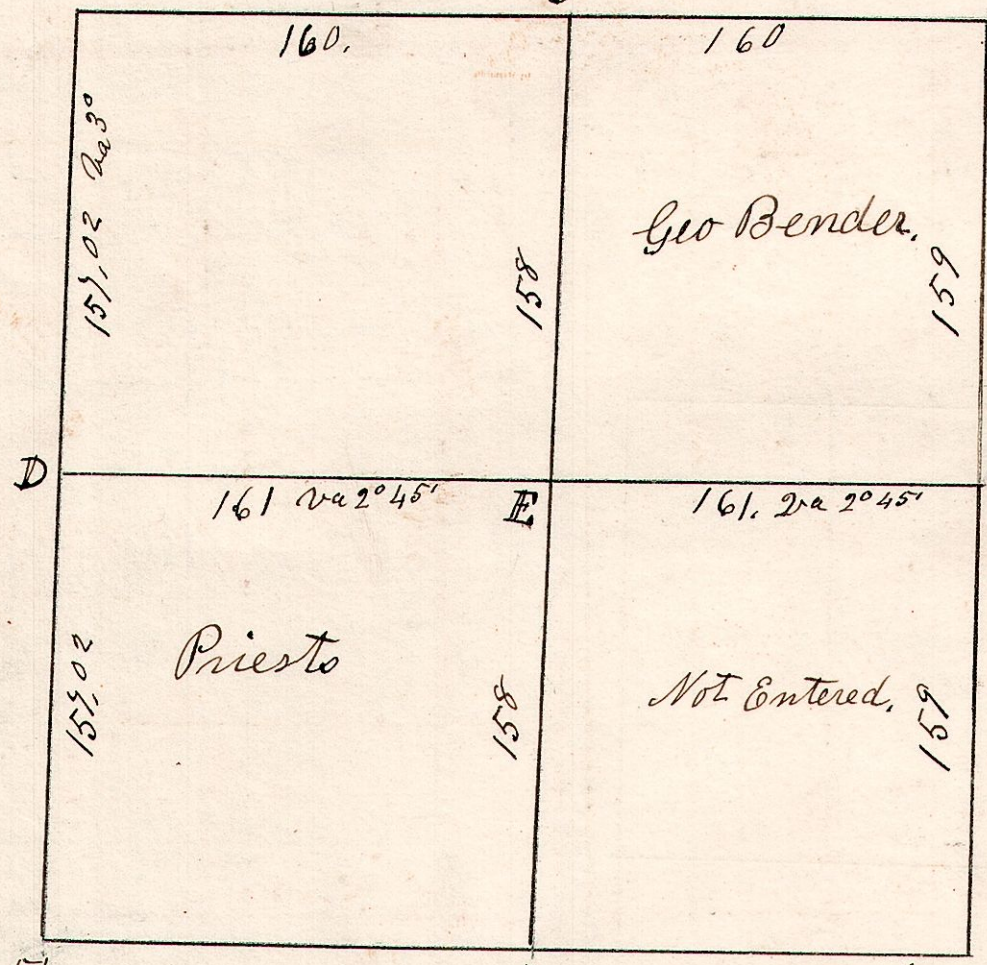

W. Oak 13 S 76 E 4.
do 22 S 60 W 4.

Stone 15th corner
in prairie.

W. Oak 12 S 78 E 4.
do 8 S 53 W 14.

E. W Oak 12 S 43 E 55,
Post stands in Swamp.