

5. 8. 12.

No 219

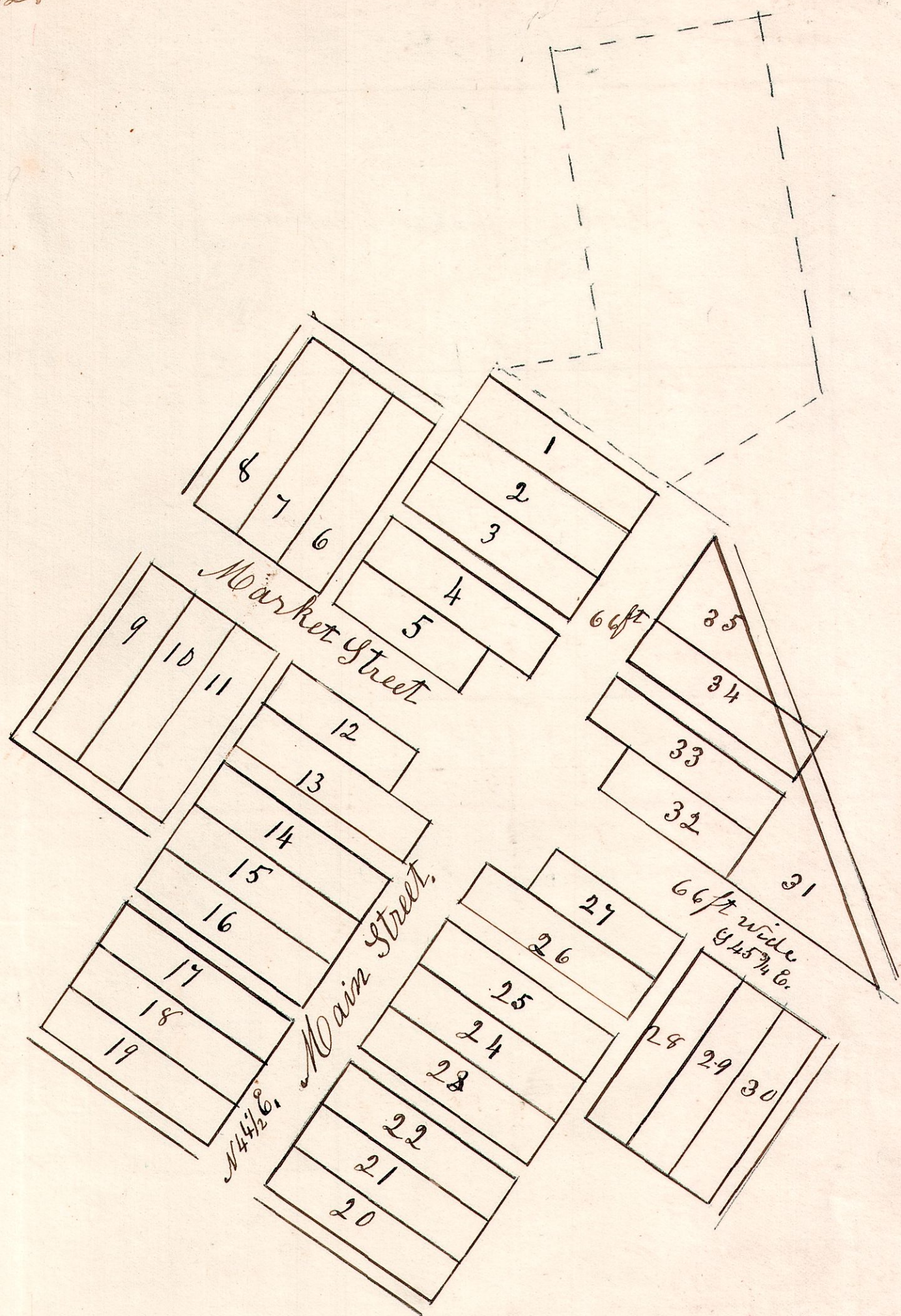

Farmeroville (Farmerstown P. O) 1805.

Surveyed May 30th 1832.

Lots 5, 12, 27, 32, are 3 perches in front, ($49\frac{1}{2}$) & 9 perches back.
do 31 & 35, are triangular lots.

All the remaining lots are 3 per in front,
and 12 per back. Alleys all $16\frac{1}{2}$ feet wide.

Farmeroville is situated on the north
East part of the North East quarter of
Sec 12, T 8, R 5. German Township