

R Tp Sec 2v
5 9 5 NE

No. 171.

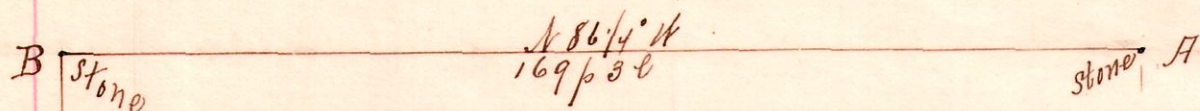

Note

"A," is a stone at the northeast corner of the northeast quarter of section 5 Tp. 9, R. 5.

Took as a new witness a

B. Walnut 5 N 5° E 25 3/4 links

"B," a stone we found at the north quarter corner of said section 5 N 86 1/4 W 169 perches 3 links from A; found stump of old witness N 00 W 12 S 17 E 12 links.

Took as new witnesses } ash 14 S 11 1/2 E 16 1/2 links
W oak 30 N 61 1/2 W 31 1/2 "

"D," a stone at the SW^q said quarter, S 4° 25' W 170 perches from B.

"C," we planted a stone at S^q Dushels land 17 perches north of D

Chamman and Assistants

Fred. Reidenbach, W^m Dushel; Eli Henry & John Reidenbach, Surveyed for William Dushel, Josiah Hochstetler, and others, to determine the lines AB and CD; also the corners A and C; April 17, 1896, Frank H. Gunt, C. Surveyor.

No. 172.

R Tp sec 2v
5 9 5 NE

Lot 1
4th 2v Tp 10 R 6⁵

Lot 24, 3d 1/4, Tp. 10, R. 5.

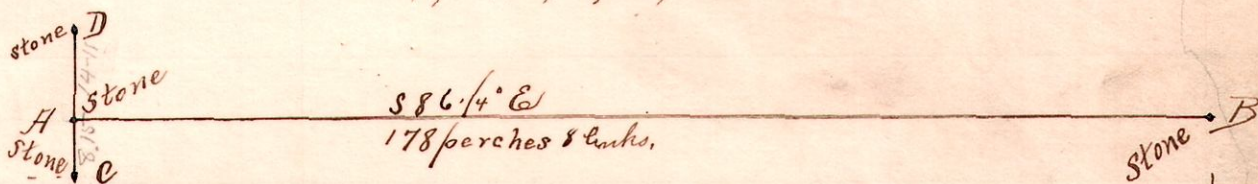

Note.

"A," the northwest corner of the northwest quarter of section 5, Tp. 9, R. 5, we located from spot where stood the original white oak 20 N 33 E 23 l; we placed a hard sand stone 3 feet long.

"B," the northeast corner said quarter, S 86 1/4 E 178 p 8 l from A.

"C," the southeast corner of Lot 1, 4th 2v Tp 10 R 6 (Salt Lake) is S 4° 10' W 8 p 15 l from A; it is also corner Lot 1, 1st 1/4 Tp 9 R 6.

"D," a stone on east line said Lot 1, 4th 2v Tp 10 R 6 N 4° 10' E 14 p 11 l from A and 23 p 10 l from C.

Surveyed for Fred Reidenbach, William Dushel, et al to determine the lines AB, and CD; also the corners A, D and C. April 17 1896.

Frank H. Gunt,
C. Surveyor,
Holmes Co.
O.