

211

Twp 14 Range 12, Sec. 2 S.W. 1/4 East part.

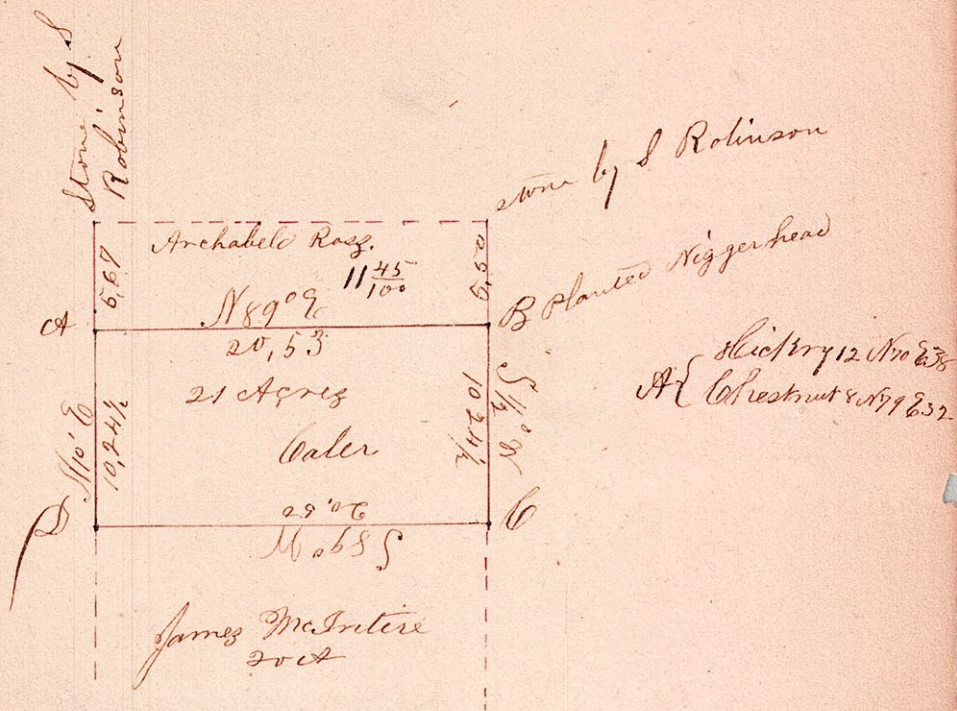

Surveyed the above for Archabell Ross & Caleb
 on Thursday Aug 15th A.D. 1861. — Ross having sold
 the twenty one acres to Caleb
 I hereby certify the above to be a correct plat &
 notes of the survey of the east part of the aforesaid
 Joseph Edgar County
 Surveyor for Holmes County