

1917

Sec. 6, Twp. 8, R. 8, (Richland) South West 2d.

No. 19,

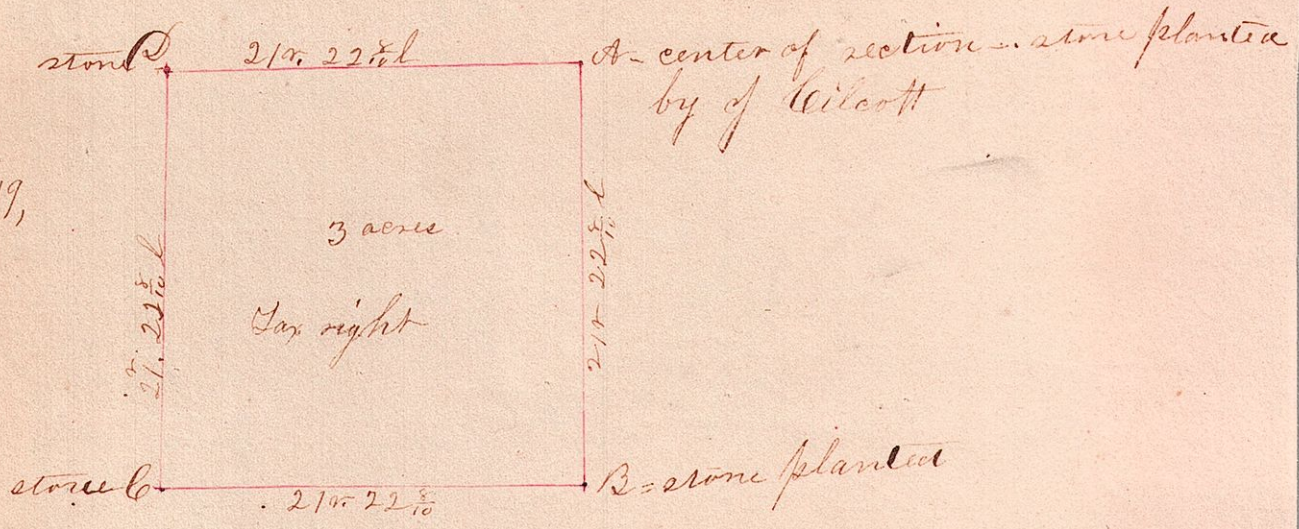

Witness at Co. Book 8 N 49 1/2 W 24 1/2 l, Heickery 5: S. 4 9 1/2 W. 9 l  
 Surveyed the above for James Jolley on the  
 2<sup>d</sup> day of July A.D. 1860, being three acres out  
 of the N. E. corner of the south West 2d.  
 Chain carriers Wm Scott & Charles Cornelle sworn  
 Joseph Edgar, County  
 Surveyor for Columbus Co. Ohio