

184

T.P. 8, R. 6, S. 18, E. 2, N.W. 6. (Mechanic & P.)

(11)

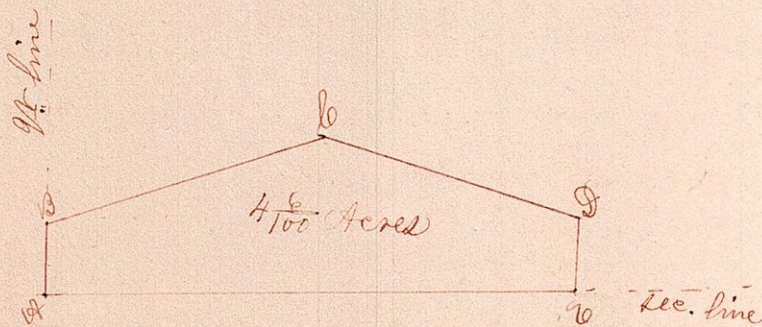

Course and distances of lines		B. Tree	Sim. C. Grey bear	Size
A	N 1° E 70 rods & 11 links.	A	28	N 30 1/2° W 60
		B	21	S 52° E 60
B	N 74 3/4° E 34 & 14 "	B	15	N 23° E 15
		C	25	N 79 1/2° W 6
C	S 72 3/4° E 28 rods.	C	14	N 30 1/2° E 80
D	S 3 1/2° W 70 rods & 19 links.	D	Post corner in side of road	
E	N 89 1/4° W 56 rods	E	Post corner	

Surveyed the above for J. Snyder on the 20th day of Apr. 1860. being a parcel of land in the south West corner of N. E. Quarter of Sec. 18 T.P. 8 of R. 6. of which the above is a correct plat. and note of survey.

Joseph Edgar County Surveyor for Holmes County Ohio.