

Sec 19, T. P. 9, R. 4

West  
South part of N. E. 9.

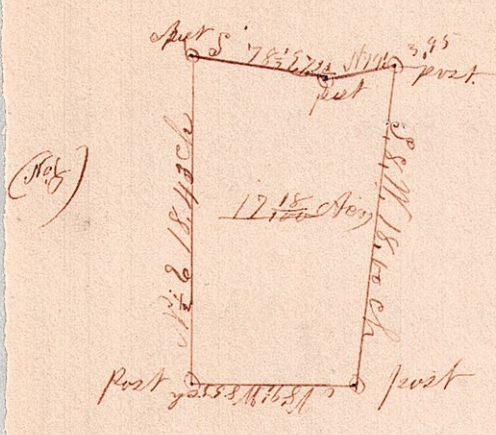

Surveyed the above for John of Grover of Walnut Creek  
Township on 29<sup>th</sup> day of Oct 1860. being the south west part  
of a tract of land lying on the south side of the road  
that leads from Berlin to Shansville. the middle  
of said road being the north line, said lot contains  
17 <sup>15</sup>/<sub>100</sub> acres which he has sold to Daniel Stoltzman  
Joseph Edgar County surveyor for  
Knox County Ohio