

Section 6 Twp 8 Range 9.

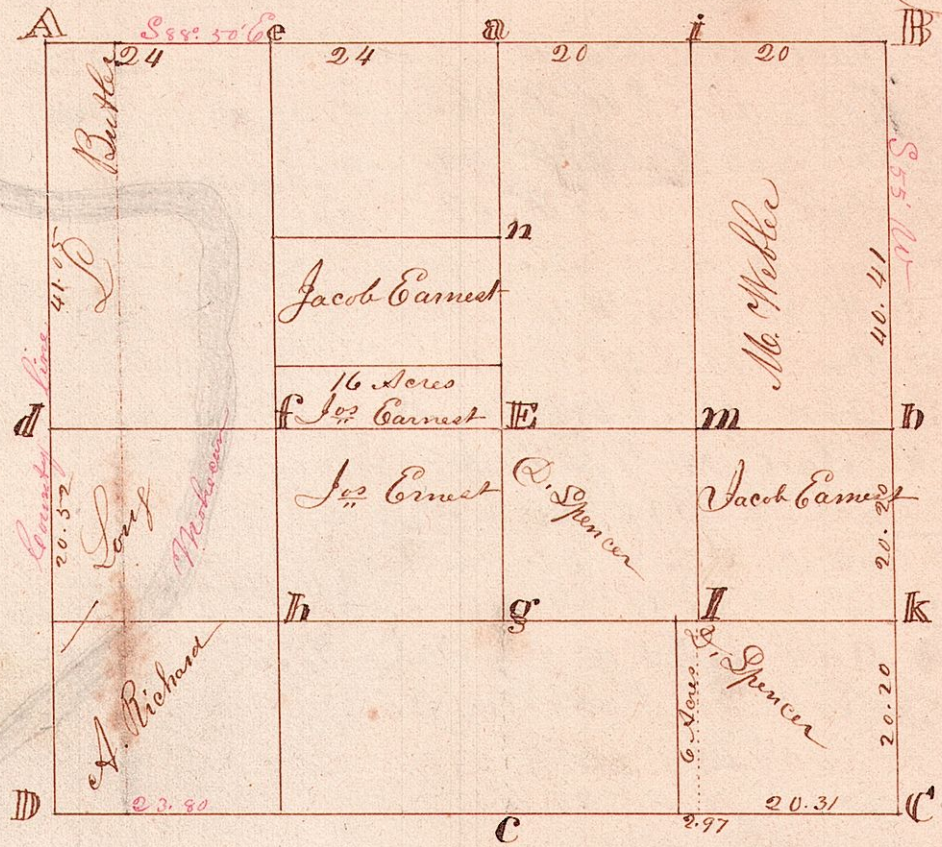

Bearing Trees.

- A B. Oak 12 S 66 E 27 S 30 12 N 50 E 35
- B W. Oak 20 S 66 E 62. No other ^{landed} timber near
- b B. Oak 11 S 34 E 24 S 30 12 N 75 E 17
- k W. Oak 20 S 6 W 20 S 30 20 N 70 E 17
- i W. Oak 16 19 E 47 No other sound timber near
- g B. Oak 10 N 1 E 26
- h B. Oak N 7 W 58
- d Honey Locust 3 N 3 E 174 line R
- e W. Oak 18 N 2 W 58 S 30 14 S 55 W 41
- m W. Oak 15 N 66 W 27
- k B. Oak 6 S 46 E 8
- l B. Oak 10 N 70 W 41
- e B. Oak 5 N 45 W 24 S 30 6 N 73 W 4
- a Original corner One of the W. Oaks standing

Surveyed the above section by mutual agreement with the above named persons. January 1851

The N.W. corner could not be found, was made by running a line from the N.E. corner past the g^r corner to the county line.

Richard Silcott (C. S. H. C.)